



Western Michigan University
ScholarWorks at WMU

Legacy Scout Tickets from Pure Oil Company

8-20-2021

**MGRRE_PureOilScoutTickets_BRYAN, THOMAS &
EDITH_2_21011091690000**

MGRRE
Western Michigan University

Follow this and additional works at: <https://scholarworks.wmich.edu/pure>



Part of the Geology Commons

WMU ScholarWorks Citation

MGRRE, "MGRRE_PureOilScoutTickets_BRYAN, THOMAS & EDITH_2_21011091690000" (2021). *Legacy Scout Tickets from Pure Oil Company*. 242.
<https://scholarworks.wmich.edu/pure/242>

This Document is brought to you for free and open access via ScholarWorks at WMU. It has been accepted for inclusion in Legacy Scout Tickets from Pure Oil Company by an authorized administrator of ScholarWorks at WMU. See the National Digital Catalogue - Science Base Catalogue for more collections submitted by MGRRE.



MGRRE_PureOilScoutTickets_BRYAN, THOMAS & EDITH_2_21011091690000

API 21011091690000

Permit Number 9169

Lease Name BRYAN, THOMAS & EDITH

Well Number 2

County Arenac

Township 19N

Range 3E

Section 22

2021 DEQ or Pure co_name MAJOR ERVIN

Pure Number 262

Latitude 44.03045

Longitude -84.09723

THE PURE OIL COMPANY

262+

DATE November 15, 1941

LOCATION REPORT

No.

STATE Michigan

COUNTY Arenac

TWP. Adams

SEC. 22

TOWN 19 N

RANGE 3 E

WELL No. 22

(SERIAL No. 262) FARM

Thomas and Edith Bryan

ACRES

NAME OF STREAM OR WATERS

QUADRANGLE SE NE SW

OPERATOR Ervin Major

Map Adams Township, Arenac County

990

Ervin Major

Feet from North Line of Farm

330

330

" " East " " "

" " South " " "

" " West " " "

990

990

Feet from North Line of Section

330

330

" " East " " "

" " South " " "

" " West " " "

Rig

LEGEND

○ LOCATION

① RIG

⊕ DRILLING

☼ GAS WELL

● OIL WELL

◆ SMALL OIL WELL

⊙ DRY HOLE

◆ DRY SHOWING OIL

⊙ DRY SHOWING GAS

⊙ ABANDONED LOCATION

☼ ABANDONED GAS WELL

◆ ABANDONED OIL WELL

NOTE: Below make tracing from map, (when no map is obtainable make sketch) showing farm, center of section, this location with measurements and also wells, dry holes, or other locations in the vicinity of this location.

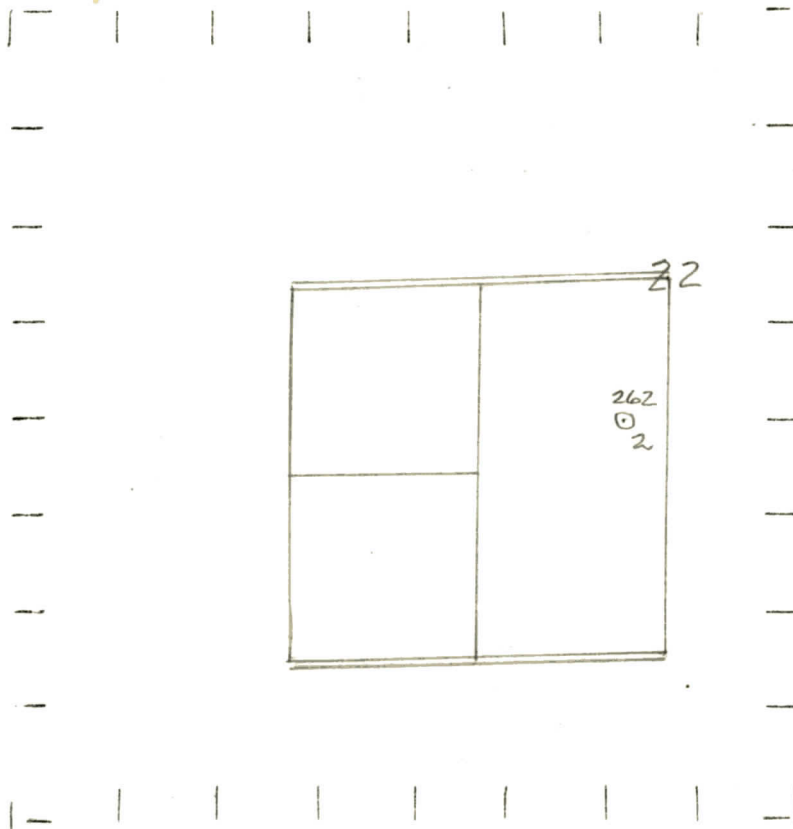

REMARKS:

SIGNED

Superintendent or Foreman.

RECORD

330

330

OBSERVATION PLATE NO. 101

NAME OF SURVEYOR OR MALEERS

SURVEYING STATION

State Mich. County Arenac Twp. Adams Sec. 22 Twp. 19 N Rge. 3 EWell No. 2 (Serial No.) 262 Farm Thomas Bryan AcresOperator Ervin Major Information secured By Scouting DepartmentDate well started 11-23-41 Date well completed 12-30-41 Elevation 792.7PRODUCTION RECORD1st 24 hours natural Dry Hole

2nd 24 hours natural

Date of shot No. of quarts From to From to Date of acid No. of gallons 1st 24 hours after acid shot2nd 24 hours after acid shotFORMATION AND CASING RECORD

Formation	Top	Bottom	Top Pay	Bottom Pay	Remarks	Casing	
						Size	Set at
Marshall	374	486				10"	207
"	502	541				8-1/4"	589
"	564	576	564	572	Water.	6-5/8"	2500
Coldw. Red Rock	1485	1495	895	986	"		
Sunbury	1570						
Berea	1591		1645	1650	Water.		
Antrim	1725						
Traverse Line	2102	S.L.M.	2103	2113	Rainbow oil.		
				2215	Salt water.		
				2381	Flowing water.		
Dundee	2878		3007	3011	Water - 1000 ft.		
Total Depth		3011					

Remarks 2823' CTM equals 2825' SLM.Signed D. C. Shackelford