



Western Michigan University
ScholarWorks at WMU

Legacy Scout Tickets from Pure Oil Company

8-20-2021

MGRRE_PureOilScoutTickets_Joe Varadi_1_na

MGRRE

Western Michigan University

Follow this and additional works at: <https://scholarworks.wmich.edu/pure>



Part of the Geology Commons

WMU ScholarWorks Citation

MGRRE, "MGRRE_PureOilScoutTickets_Joe Varadi_1_na" (2021). *Legacy Scout Tickets from Pure Oil Company*. 275.

<https://scholarworks.wmich.edu/pure/275>

This Document is brought to you for free and open access via ScholarWorks at WMU. It has been accepted for inclusion in Legacy Scout Tickets from Pure Oil Company by an authorized administrator of ScholarWorks at WMU. See the National Digital Catalogue - Science Base Catalogue for more collections submitted by MGRRE.



MGRRE_PureOilScoutTickets_Joe Varadi_1_na

API na

Permit Number na

Lease Name Joe Varadi

Well Number 1

County Arenac

Township 19N

Range 4E

Section 30

2021 DEQ or Pure co_name Ervin Major

Pure Number 296

Latitude 44.0188111

Longitude -84.0367205

THE PURE OIL COMPANY

296
Serial No. 296

Date July 29, 1942 LOCATION REPORT A.F.E. No. _____

Division Michigan Producing District _____ Lease Joe Varadi
Joe Varadi

Acres _____ Lease No. _____ Elevation _____ Well No. 1 (Serial No. 29296)

Quadrangle C SW SW (1/4) Sec. 30 Twp. 19-N Rge. 4-W ~~By~~ ~~Risk~~ Twp. Deep River

Survey _____ County Arenac State Michigan

Operator Ervin Major Map Deep River Township, Arenac County

Feet from North Line of Lease

" " East " " "

660 660 " " South " " "

440 440 " " West " " "

Feet from North Line of Section

" " East " " "

660 660 " " South " " 4/4

440 440 " " West " " "

LEGEND

○ Location

☀ Gas Well

● Oil Well

☀ Gas - Distillate Well

○ or ○ Dry Hole

● Dry Showing Oil

☀ Dry Showing Gas

⊗ Abandoned Location

☀ or ☀ Abandoned Gas Well

● or ● Abandoned Oil Well

⊗ or ⊗ Input Well

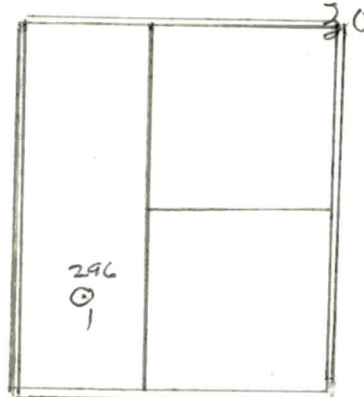

Scale _____

Remarks: _____

Submitted by W _____
Civil Engineer

Approved by _____
Division Manager

Approved by _____
Vice-President - General Manager

Michigan Producing Division

Date October 21, 1942 No. 296
 State Mich. County Arenac ~~Deep River~~ Twp. Deep River Sec. 30 Twp. 19 N Rge. 4 E
 Well No. 1 (Serial No. 296) ~~296~~ Farm Joe Varadi Acres _____
 Operator Ervin Major Information secured ~~XXXX~~ By Scouting Department
 Date well started Not started Date well completed Not completed Elevation 701.5

PRODUCTION RECORD

1st 24 hours natural Location abandoned.
 2nd 24 hours natural _____
 Date of shot _____ No. of quarts _____ From _____ to _____ From _____ to _____
 Date of acid _____ No. of gallons _____
 1st 24 hours after acid shot _____
 2nd 24 hours after acid shot _____

FORMATION AND CASING RECORD

Formation	Top	Bottom	Top Pay	Bottom Pay	Remarks	Casing	
						Size	Set at
Location abandoned 9-19-42.							

Remarks _____

Signed D. C. Shackelford