



Western Michigan University  
ScholarWorks at WMU

---

Legacy Scout Tickets from Pure Oil Company

---

8-20-2021

**MGRRE\_PureOilScoutTickets\_LUCAS, WILLIAM  
H\_1\_21011097690000**

MGRRE

*Western Michigan University*

Follow this and additional works at: <https://scholarworks.wmich.edu/pure>



Part of the Geology Commons

---

#### **WMU ScholarWorks Citation**

MGRRE, "MGRRE\_PureOilScoutTickets\_LUCAS, WILLIAM H\_1\_21011097690000" (2021). *Legacy Scout Tickets from Pure Oil Company*. 282.

<https://scholarworks.wmich.edu/pure/282>

This Document is brought to you for free and open access via ScholarWorks at WMU. It has been accepted for inclusion in Legacy Scout Tickets from Pure Oil Company by an authorized administrator of ScholarWorks at WMU. See the National Digital Catalogue - Science Base Catalogue for more collections submitted by MGRRE.



---

**MGRRE\_PureOilScoutTickets\_LUCAS, WILLIAM H\_1\_21011097690000**

API 21011097690000

Permit Number 9769

Lease Name LUCAS, WILLIAM H

Well Number 1

County Arenac

Township 19N

Range 4E

Section 30

2021 DEQ or Pure co\_name RAYBURN DON F

Pure Number 303

Latitude 44.017

Longitude -84.04016

THE PURE OIL COMPANY

FIELD OPERATORS

Date September 9, 1942 LOCATION REPORT A.F.E. No. \_\_\_\_\_

Division Michigan Producing District \_\_\_\_\_ Lease William H. Lucas

Acres \_\_\_\_\_ Lease No. \_\_\_\_\_ Elevation \_\_\_\_\_ Well No. 1 (Serial No. 303)

Quadrangle C NE SW Sec. 30 Twp. 19 N Rge. 4 E Twp. Deep River

Survey \_\_\_\_\_ County Arenac State Michigan

Operator Don F. Rayburn Map Deep River Township, Arenac County

<u>660</u>	<u>660</u>	Feet from North Line of Lease
<u>660</u>	<u>660</u>	" " East " " "
		" " South " " "
		" " West <u>1/4</u> "
<u>660</u>	<u>660</u>	Feet from North Line of Section
<u>660</u>	<u>660</u>	" " East " " "
		" " South " " "
		" " West " " "

*Loc*

LEGEND

- Location
- ☀ Gas Well
- Oil Well
- ☀ Gas - Distillate Well
- ∅ or ○ Dry Hole
- Dry Showing Oil
- ☀ Dry Showing Gas
- ⊗ Abandoned Location
- ☀ or ☀ Abandoned Gas Well
- or ● Abandoned Oil Well
- or ○ Input Well

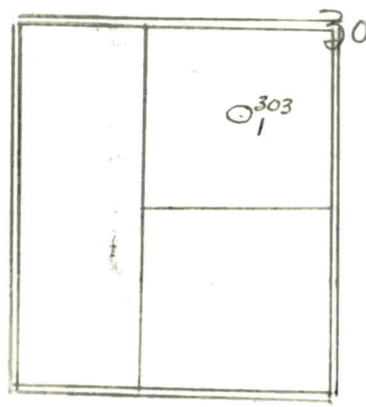

Scale \_\_\_\_\_

Remarks: \_\_\_\_\_

Submitted by \_\_\_\_\_ Civil Engineer Approved by \_\_\_\_\_ Division Manager

Approved by \_\_\_\_\_ Vice-President - General Manager

Date 1-6-43 No. 303  
 State Mich. County Arenac ~~SE333~~ Twp. Deep River Sec. 30 Twp. 19 N Rge. 4 E  
 Well No. 1 (Serial No.) 303 Farm Wm. H. Lucas Acres \_\_\_\_\_  
 Operator Don F. Rayburn Information secured ~~from~~ <sup>By</sup> Scouting Department  
 Date well started 10-5-42 Date well completed 12-15-42 Elevation 737.3

PRODUCTION RECORD

**Dry Hole**

1st 24 hours natural \_\_\_\_\_  
 2nd 24 hours natural \_\_\_\_\_  
 Date of shot \_\_\_\_\_ No. of quarts \_\_\_\_\_ From \_\_\_\_\_ to \_\_\_\_\_ From \_\_\_\_\_ to \_\_\_\_\_  
 Date of acid \_\_\_\_\_ No. of gallons \_\_\_\_\_  
 1st 24 hours after acid shot \_\_\_\_\_  
 2nd 24 hours after acid shot \_\_\_\_\_

FORMATION AND CASING RECORD

Formation	Top	Bottom	Top Pay	Bottom Pay	Remarks	Casing	
						Size	Set at
Marshall	260	430			Water 260-265.	10"	144
Coldw. Red Rock	1365	1373				8-1/4"	490
Sunbury	1475					6-5/8"	2166
Berea	1499				H.F.W. 1560-1575.		
Antrim	1652						
Traverse Form.	2010						
Traverse Line	2015	S.O.M.			Water at 3040.		
Dundas	2820	SLM					
Total Depth		3115					

Remarks 2120' CTM equals 2120' SOM; 2836' CTM equals 2840' SLM.

Signed D. C. Shackelford