



Western Michigan University
ScholarWorks at WMU

Legacy Scout Tickets from Pure Oil Company

8-20-2021

MGRRE_PureOilScoutTickets_PULA, WALTER_1_21011102850000

MGRRE

Western Michigan University

Follow this and additional works at: <https://scholarworks.wmich.edu/pure>



Part of the Geology Commons

WMU ScholarWorks Citation

MGRRE, "MGRRE_PureOilScoutTickets_PULA, WALTER_1_21011102850000" (2021). *Legacy Scout Tickets from Pure Oil Company*. 296.

<https://scholarworks.wmich.edu/pure/296>

This Document is brought to you for free and open access via ScholarWorks at WMU. It has been accepted for inclusion in Legacy Scout Tickets from Pure Oil Company by an authorized administrator of ScholarWorks at WMU. See the National Digital Catalogue - Science Base Catalogue for more collections submitted by MGRRE.



MGRRE_PureOilScoutTickets_PULA, WALTER_1_21011102850000

API 21011102850000

Permit Number 10285

Lease Name PULA, WALTER

Well Number 1

County Arenac

Township 18N

Range 4E

Section 19

2021 DEQ or Pure co_name MAJOR ERVIN

Pure Number 317

Latitude 43.95259

Longitude -84.03419

THE PURE OIL COMPANY LOCATION REPORT

Date August 11, 1943 A.F.E. No. _____
 Division Mich. Producing District _____ Lease Walter Pula
 Acres _____ Lease No. _____ Elevation _____ Well No. 1 (Serial No. 317)
 Quadrangle NW NE Sec. 19 Twp. 18 N Rge. 4 E Twp. Lincoln
 Survey _____ County Arenac State Michigan
 Operator Ervin Major Map Lincoln Township, Arenac County

660 660 Feet from North Line of Lease
 " " East " " "
 " " South " " "
660 660 " " West " 1/4 "
660 660 Feet from North Line of Section
 " " East " " "
 " " South " " "
660 660 " " West " " "

Sp 8-10

- LEGEND
- Location
 - ☀ Gas Well
 - Oil Well
 - ☀ Gas - Distillate Well
 - ∅ or ○ Dry Hole
 - Dry Showing Oil
 - Dry Showing Gas
 - ⊖ Abandoned Location
 - ☀ or ☀ Abandoned Gas Well
 - or ● Abandoned Oil Well
 - or ○ Input Well

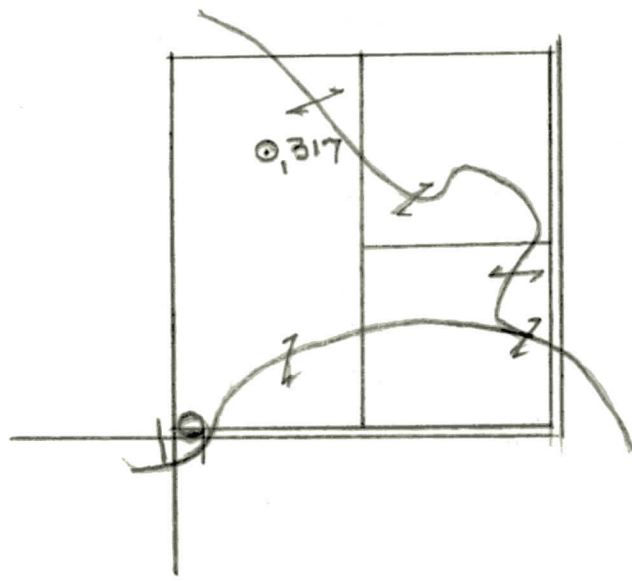

Scale _____

Remarks: _____

Submitted by RAN Civil Engineer Approved by _____ Division Manager
 Approved by _____ Vice-President - General Manager

Michigan Producing Division

Date September 9, 1943 No. 317
 State Mich. County Arenac ~~DuSoto~~ Twp. Lincoln Sec. 19 Twp. 18 N Rge. 4 E
 Well No. 1 (~~20025200~~) 317 Farm Walter Pula Acres _____
 Operator Ervin Major Information secured ~~from~~ Scouting Department By _____
 Date well started 8-10-43 Date well completed 9-1-43 Elevation 649.9

PRODUCTION RECORD

1st 24 hours natural Dry Hole
 2nd 24 hours natural _____
 Date of shot _____ No. of quarts _____ From _____ to _____ From _____ to _____
 Date of acid _____ No. of gallons _____
 shot _____
 1st 24 hours after acid _____
 shot _____
 2nd 24 hours after acid _____

FORMATION AND CASING RECORD

Formation	Top	Bottom	Top Pay	Bottom Pay	Remarks	Casing	
						Size	Set at
Marshall	340 ?					10"	108
Coldw. Red Rock	1369	1375				8-1/4"	500
Sunbury	1471	C.T.M.					
Berea	1504				Salt water 1560.		
Antrim	1661						
Traverse Lime	2011	C.T.M.			Very small show oil 2011-2016.		
Dundee	2794	C.T.M.			Very small show oil 2910.		
					Water 3035-3045 - 100 ft. in 1 hour.		
Total Depth		3045					

Remarks 2384' CTM equals 2384' SLM.

Signed D. C. Shackelford

2882
141