



Western Michigan University  
ScholarWorks at WMU

---

Legacy Scout Tickets from Pure Oil Company

---

8-20-2021

**MGRRE\_PureOilScoutTickets\_MULLER,  
CHARLES\_1\_21011103010000**

MGRRE  
*Western Michigan University*

Follow this and additional works at: <https://scholarworks.wmich.edu/pure>



Part of the Geology Commons

---

#### **WMU ScholarWorks Citation**

MGRRE, "MGRRE\_PureOilScoutTickets\_MULLER, CHARLES\_1\_21011103010000" (2021). *Legacy Scout Tickets from Pure Oil Company*. 297.

<https://scholarworks.wmich.edu/pure/297>

This Document is brought to you for free and open access via ScholarWorks at WMU. It has been accepted for inclusion in Legacy Scout Tickets from Pure Oil Company by an authorized administrator of ScholarWorks at WMU. See the National Digital Catalogue - Science Base Catalogue for more collections submitted by MGRRE.



---

**MGRRE\_PureOilScoutTickets\_MULLER, CHARLES\_1\_21011103010000**

API 21011103010000

Permit Number 10301

Lease Name MULLER, CHARLES

Well Number 1

County Arenac

Township 19N

Range 6E

Section 11

2021 DEQ or Pure co\_name MCCLANAHAN W L

Pure Number 318

Latitude 44.05641

Longitude -83.70878

**THE PURE OIL COMPANY  
LOCATION REPORT**

A.F.E. No. \_\_\_\_\_

*Charles Muller*  
Charles Muller

Date August 18, 1943

Division Mich. Producing District \_\_\_\_\_ Lease \_\_\_\_\_

Acres \_\_\_\_\_ Lease No. \_\_\_\_\_ Elevation \_\_\_\_\_ Well No. 1 (Serial No. 318)

Quadrangle C S 1/2 SE SE Sec. 11 Twp. 19 N Rge. 6 E Dist. Au Gres Twp. Au Gres

Survey \_\_\_\_\_ County Arenac State Michigan

Operator W. L. McClanahan Map Au Gres Township, Arenac County

Feet from North Line of Lease  
660 660 " " East " " "  
330 330 " " South " " "  
 " " West " " "

Feet from North Line of Section  
660 660 " " East 1/4 "  
330 330 " " South " " "  
 " " West " " "

**LEGEND**

- Location
- ☀ Gas Well
- Oil Well
- ☀ Gas - Distillate Well
- ∅ or ○ Dry Hole
- Dry Showing Oil
- ☀ Dry Showing Gas
- ⊗ Abandoned Location
- ☀ or ☀ Abandoned Gas Well
- or ● Abandoned Oil Well
- or ○ Input Well

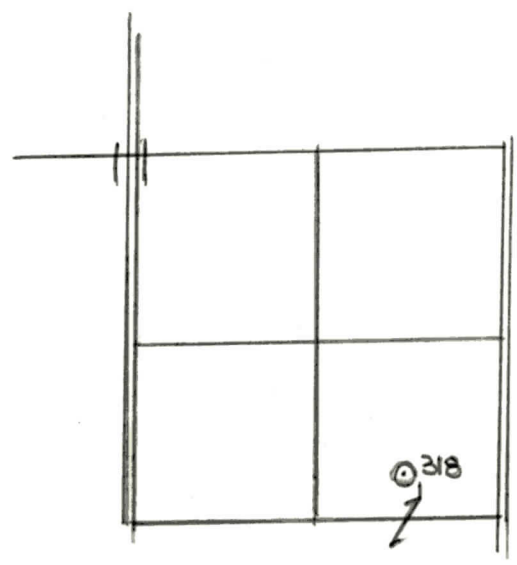

Scale \_\_\_\_\_

Remarks: \_\_\_\_\_  
 \_\_\_\_\_  
 \_\_\_\_\_

Submitted by RD Civil Engineer Approved by \_\_\_\_\_ Division Manager

Approved by \_\_\_\_\_ Vice-President - General Manager

The Pure Oil Company  
 COMPLETION RECORD OF WELLS DRILLED BY OTHER OPERATORS

Michigan Producing Division

Date **November 15, 1944** No. **318**  
 State **Mich.** County **Arenac** District **Au Gres** Twp. **Au Gres** Sec. **11** Twp. **19 N** Rge. **6 E**  
 Well No. **1** (Serial No.) **(~~318~~) 318** Farm **Chas. Miller** Acres \_\_\_\_\_  
 Operator **W. L. McClanahan** Information secured ~~xxxx~~ **Scouting Department**  
 Date well started **10-14-43** Date well completed **11-9-44** Elevation **597.0**

PRODUCTION BOARD

1st 24 hours natural **Dry Hole**  
 2nd 24 hours natural \_\_\_\_\_  
 Date of shot \_\_\_\_\_ No. of quarts \_\_\_\_\_ From \_\_\_\_\_ To \_\_\_\_\_ From \_\_\_\_\_ to \_\_\_\_\_  
 Date of acid \_\_\_\_\_ No. of gallons \_\_\_\_\_  
 1st 24 hours after acid shot \_\_\_\_\_  
 2nd 24 hours after acid shot \_\_\_\_\_

FORMATION AND CASING RECORD

Formation	Top	Bottom	Top Pay	Bottom Pay	Remarks	Casing	
						Size	Set at
Marshall	70	(+527)			H.F.W. 80. (+517)	14"	40
Sunbury	1130	(-822)s				10"	290
Berea	1459	(-860)s			H.F.S.W. 1515 - (-918)	6-5/8"	2833
Antrim	1670	(-673)s			Small show gas in	5-3/16"	4031 CTM.
Traverse Lime	2030	SOM.	(+1436)s		Berea. Salt wtr. 2050. (-1452)		
Dundee	2832	(-2235)s			2 ba. S.W./Hr. 3024-3048. (-2427)		
Red Rock	259	(+338)	88		H.F.S.W. 3070-3075. (-2493)		
Out Rwe	3240	(-2643)s			Show gas 3178-3180. (-2581)		
Salt	3340	(-2743)			Show sour oil 3360-3370. (-2763)		
					" " oil & gas 3791-3799. (-3194)		
					Very small show oil 4127 SLM. (-3530)		
					Small show oil 4202-questionable inc. gas from 4243-4257. (-3605)		
Total Depth		4292	(-3695)				

Remarks **2220' eq. 2224' SOM; 2300' eq. 2790' SLM; 2885' eq. 2884' SLM; 4086'-4028' SLM; 4147' eq. 4132' SLM; 4222'-eq. 4229' SLM.**

Signed **D. C. Shackelford**