



Western Michigan University  
ScholarWorks at WMU

---

Legacy Scout Tickets from Pure Oil Company

---

8-20-2021

**MGRRE\_PureOilScoutTickets\_HORTON,  
DESTER\_1\_21011103900000**

MGRRE

*Western Michigan University*

Follow this and additional works at: <https://scholarworks.wmich.edu/pure>



Part of the Geology Commons

---

#### **WMU ScholarWorks Citation**

MGRRE, "MGRRE\_PureOilScoutTickets\_HORTON, DESTER\_1\_21011103900000" (2021). *Legacy Scout Tickets from Pure Oil Company*. 300.

<https://scholarworks.wmich.edu/pure/300>

This Document is brought to you for free and open access via ScholarWorks at WMU. It has been accepted for inclusion in Legacy Scout Tickets from Pure Oil Company by an authorized administrator of ScholarWorks at WMU. See the National Digital Catalogue - Science Base Catalogue for more collections submitted by MGRRE.



---

**MGRRE\_PureOilScoutTickets\_HORTON, DESTER\_1\_21011103900000**

API 21011103900000

Permit Number 10390

Lease Name HORTON, DESTER

Well Number 1

County Arenac

Township 19N

Range 3E

Section 28

2021 DEQ or Pure co\_name MAJOR ERVIN

Pure Number 321

Latitude 44.01319

Longitude -84.11827

# THE PURE OIL COMPANY LOCATION REPORT

Date September 29, 1943 A.F.E. No. \_\_\_\_\_

Division Mich. Producing District \_\_\_\_\_ Lease Dexter Horton

Acres \_\_\_\_\_ Lease No. \_\_\_\_\_ Elevation \_\_\_\_\_ Well No. 1 (Serial No. 321)

Quadrangle C SE SW Sec. 28 Twp. 19 N Rge. 3 W Twp. Adams

Survey \_\_\_\_\_ County Arenac State Michigan

Operator Ervin Major Map Adams Twp. Arenac Co.

660 660 Feet from North Line of Lease

\_\_\_\_\_ " " East " " "

\_\_\_\_\_ " " South " " "

\_\_\_\_\_ " " West " " "

\_\_\_\_\_ Feet from North Line of Section

660 660 " " East " 1/4 "

\_\_\_\_\_ " " South " " "

\_\_\_\_\_ " " West " " "

### LEGEND

- Location
- ☀ Gas Well
- Oil Well
- ☀ Gas - Distillate Well
- or ○ Dry Hole
- Dry Showing Oil
- ☀ Dry Showing Gas
- ⊗ Abandoned Location
- ☀ or ☀ Abandoned Gas Well
- or ● Abandoned Oil Well
- or ○ Input Well

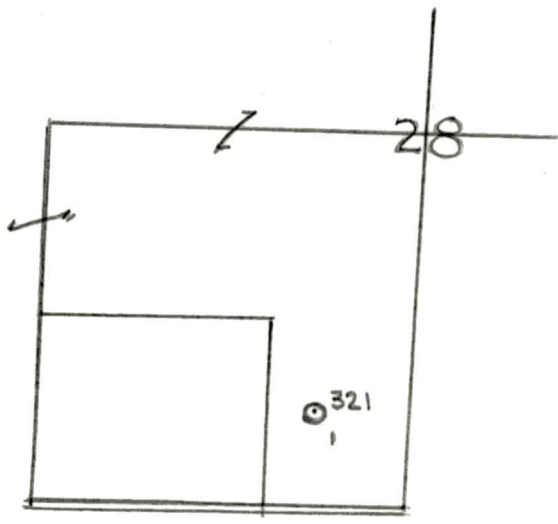

Scale \_\_\_\_\_

Remarks: \_\_\_\_\_  
\_\_\_\_\_  
\_\_\_\_\_

Submitted by RN Civil Engineer

Approved by \_\_\_\_\_ Division Manager

Approved by \_\_\_\_\_ Vice-President - General Manager

The Pure Oil Company  
COMPLETION RECORD OF WELLS DRILLED BY OTHER OPERATORS

Michigan Producing Division

TPD

Date November 24, 1943 No. 321  
 State Mich. County Arenac ~~Dex.~~ Twp. Adams Sec. 28 Twp. 19 N Rge. 3 E  
 Well No. 1 (~~00000000~~) 321 Farm Dexter Horton Acres \_\_\_\_\_  
 Operator Ervin Major By \_\_\_\_\_ Information secured ~~from~~ Scouting Department  
 Date well started 9-25-43 Date well completed 11-20-43 Elevation 814.0

PRODUCTION BOARD

Dry Hole

1st 24 hours natural \_\_\_\_\_  
 2nd 24 hours natural \_\_\_\_\_  
 Date of shot \_\_\_\_\_ No. of quarts \_\_\_\_\_ From \_\_\_\_\_ to \_\_\_\_\_ From \_\_\_\_\_ to \_\_\_\_\_  
 Date of acid \_\_\_\_\_ No. of gallons \_\_\_\_\_  
 1st 24 hours after acid shot \_\_\_\_\_  
 2nd 24 hours after acid shot \_\_\_\_\_

FORMATION AND CASING RECORD

Formation	Top	Bottom	Top Pay	Bottom Pay	Remarks	Casing	
						Size	Set at
Marshall	392				H.F.W. 596.	10"	265
Goldw. Red Rock	1557	1560	CTM			8-1/4"	682
Sunbury	1632	CTM				6-5/8"	3375
Berea	1663	"					
Antrim	1790	"					
Traverse Lime	2170				Show oil 2180-2184.		
Dundee	2977	CTM			200 ft. salt water 3140 to 3151.		
Total Depth		4610			See remarks below.		

Remarks 1 bailer water per hour from 1010 to 1020; show sulphur gas and oil 4019-4026 SLM - small show oil and gas 4370 - 2 bailers salt water 4210 to 4240 ?.  
1987' CTM eq. 1990' SLM; 4101' CTM eq. 4095' SLM.

Signed D. C. Shackelford