



Western Michigan University  
ScholarWorks at WMU

---

Legacy Scout Tickets from Pure Oil Company

---

8-20-2021

## MGRRE\_PureOilScoutTickets\_State Moffatt\_A-1\_na

MGRRE

*Western Michigan University*

Follow this and additional works at: <https://scholarworks.wmich.edu/pure>



Part of the Geology Commons

---

### WMU ScholarWorks Citation

MGRRE, "MGRRE\_PureOilScoutTickets\_State Moffatt\_A-1\_na" (2021). *Legacy Scout Tickets from Pure Oil Company*. 307.

<https://scholarworks.wmich.edu/pure/307>

This Document is brought to you for free and open access via ScholarWorks at WMU. It has been accepted for inclusion in Legacy Scout Tickets from Pure Oil Company by an authorized administrator of ScholarWorks at WMU. See the National Digital Catalogue - Science Base Catalogue for more collections submitted by MGRRE.



---

**MGRRE\_PureOilScoutTickets\_State Moffatt\_A-1\_na**

API na

Permit Number na

Lease Name State Moffatt

Well Number A-1

County Arenac

Township 20N

Range 3E

Section 28

2021 DEQ or Pure co\_name C.L. Maguire, Inc.

Pure Number 328

Latitude 44.1051611

Longitude -84.1170649

THE PURE OIL COMPANY

LOCATION REPORT

Date November 3, 1943

A.F.E. No. \_\_\_\_\_

Division Mich. Producing

District \_\_\_\_\_

Lease State-Moffatt

Acres \_\_\_\_\_

Lease No. \_\_\_\_\_

Elevation \_\_\_\_\_

Well No. A-1 (Serial No. 328)

Quadrangle N 1/2 SW SW

Sec. 28

Twp. 20 N

Rge. 3 E

~~XXX~~  
~~XXX~~  
Twp. Moffatt

Survey C. L. Maguire, Inc.

County Arenac

State Michigan

Operator C. L. Maguire, Inc.

Map Moffatt Twp. Arenac Co.  
Moffatt Township, Arenac County

Feet from North Line of Lease

890 890 " " East " " "  
660 660 " " South " " "  
" " West " " "

Feet from North Line of Section

890 890 " " East " " "  
660 660 " " South " " 1/4  
" " West " " "

*RN*

LEGEND

- Location
- ☀ Gas Well
- Oil Well
- ☀ Gas - Distillate Well
- ∅ or ○ Dry Hole
- Dry Showing Oil
- ☀ Dry Showing Gas
- ⊗ Abandoned Location
- ☀ or ☀ Abandoned Gas Well
- or ● Abandoned Oil Well
- or ○ Input Well

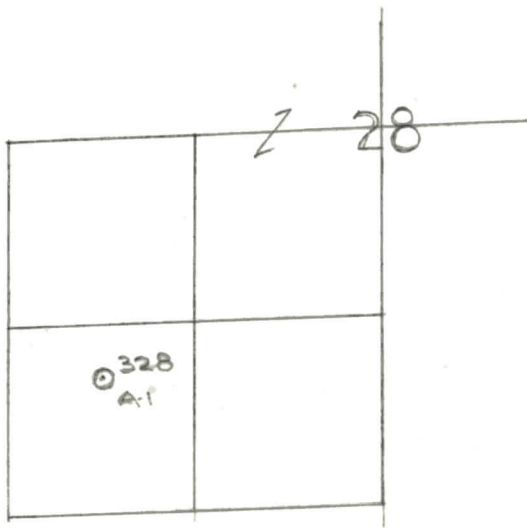

Scale \_\_\_\_\_

Remarks: \_\_\_\_\_

Submitted by RN \_\_\_\_\_  
Civil Engineer

Approved by \_\_\_\_\_  
Division Manager

Approved by \_\_\_\_\_  
Vice-President - General Manager

The Pure Oil Company  
COMPLETION RECORD OF WELLS DRILLED BY OTHER OPERATORS

Michigan Producing Division

Date January 19, 1944 No. 328  
 State Mich. County Arenac ~~Rick~~ Twp. Moffatt Sec. 28 Twp. 20 N Rge. 3 E  
 Well No. A-1 (Serial No.) ~~328~~ Farm State-Moffatt Acres \_\_\_\_\_  
 Operator C. L. Maguire, Inc. Information secured ~~from~~ By Scouting Department  
 Date well started Not started Date well completed Not completed. Elevation 771.9

PRODUCTION BOARD

1st 24 hours natural Location abandoned.  
 2nd 24 hours natural \_\_\_\_\_  
 Date of shot \_\_\_\_\_ No. of quarts \_\_\_\_\_ From \_\_\_\_\_ to \_\_\_\_\_ From \_\_\_\_\_ to \_\_\_\_\_  
 Date of acid \_\_\_\_\_ No. of gallons \_\_\_\_\_  
 1st 24 hours after acid \_\_\_\_\_ shot \_\_\_\_\_  
 2nd 24 hours after acid \_\_\_\_\_ shot \_\_\_\_\_

FORMATION AND CASING RECORD

Formation	Top	Bottom	Top Pay	Bottom Pay	Remarks	Casing	
						Size	Set at
<u>Location abandoned 1-18-44.</u>							

Remarks \_\_\_\_\_

Signed D. G. Shackelford