



Western Michigan University  
ScholarWorks at WMU

---

Legacy Scout Tickets from Pure Oil Company

---

8-20-2021

MGRRE\_PureOilScoutTickets\_BORUSHKO,  
WILLIAM\_1\_21011109650000

MGRRE  
*Western Michigan University*

Follow this and additional works at: <https://scholarworks.wmich.edu/pure>



Part of the Geology Commons

---

#### WMU ScholarWorks Citation

MGRRE, "MGRRE\_PureOilScoutTickets\_BORUSHKO, WILLIAM\_1\_21011109650000" (2021). *Legacy Scout Tickets from Pure Oil Company*. 347.

<https://scholarworks.wmich.edu/pure/347>

This Document is brought to you for free and open access via ScholarWorks at WMU. It has been accepted for inclusion in Legacy Scout Tickets from Pure Oil Company by an authorized administrator of ScholarWorks at WMU. See the National Digital Catalogue - Science Base Catalogue for more collections submitted by MGRRE.



---

**MGRRE\_PureOilScoutTickets\_BORUSHKO, WILLIAM\_1\_21011109650000**

API 21011109650000

Permit Number 10965

Lease Name BORUSHKO, WILLIAM

Well Number 1

County Arenac

Township 19N

Range 4E

Section 9

2021 DEQ or Pure co\_name RANCH PRODUCTION LLC

Pure Number 369

Latitude 44.0557675

Longitude -84.0037387

# THE PURE OIL COMPANY

## LOCATION REPORT

Date August 9, 1944

A.F.E. No. \_\_\_\_\_

Division Mich. Producing District \_\_\_\_\_ Lease William BorushkoAcres \_\_\_\_\_ Lease No. \_\_\_\_\_ Elevation \_\_\_\_\_ Well No. 1 (Serial No. 369)Quadrangle SE-SW-SW Sec. 9 Twp. 19 N Rge. 4 E Twp. Deep RiverSurvey \_\_\_\_\_ County Arenac State MichiganOperator Basin Oil Co. and Don Rayburn Map Deep River Township, Arenac County

Feet from North Line of Lease

330 330 " " East " " "400 400-330 " " South " " "330 330 " " West " " "

Feet from North Line of Section

" " East " " "

400 400-330 " " South " " 1/4990 990 " " West " " "8/16

## LEGEND

○ Location

☀ Gas Well

● Oil Well

☀ Gas - Distillate Well

○ or ○ Dry Hole

● Dry Showing Oil

☀ Dry Showing Gas

☀ Abandoned Location

☀ or ☀ Abandoned Gas Well

● or ● Abandoned Oil Well

● or ○ Input Well

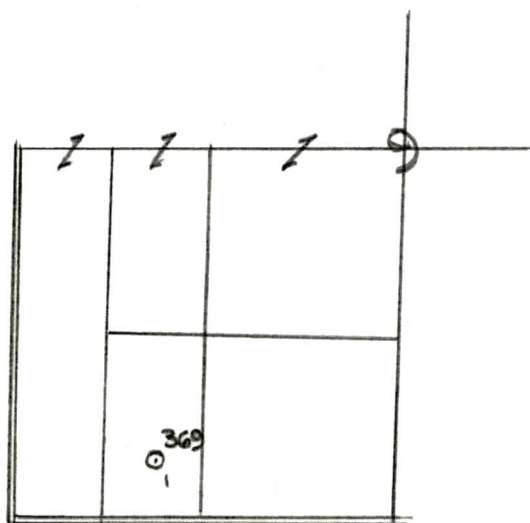

Scale \_\_\_\_\_

Remarks: \_\_\_\_\_

Submitted by RN Civil Engineer

Approved by \_\_\_\_\_ Division Manager

Approved by \_\_\_\_\_ Vice-President - General Manager



The Pure Oil Company  
COMPLETION RECORD OF WELLS DRILLED BY OTHER OPERATORS

Michigan Producing Division

Date October 25, 1944 No. 369  
 State Mich. County Arenac ~~DDECK~~ Twp. Deep River Sec. 9 Twp. 19 N Rge. 4 E  
 (Serial No.)  
 Well No. 1 (~~County No.~~) 369 Farm Wm. Borushko Acres  
 Operator Basin Oil Co. & Don Rayburn Information secured ~~DECK~~ By Scouting Department  
 Date well started 9-13-44 Date well completed 10-19-44 Elevation 761.6

PRODUCTION BOARD

1st 24 hours natural Est. 3600 bbls. (on tests of 150 bbls. per hour)

2nd 24 hours natural

Date of shot No. of quarts From to From to

Date of acid No. of gallons

1st 24 hours after acid shot

2nd 24 hours after acid shot

FORMATION AND CASING RECORD

Formation	Top	Bottom	Top Pay	Bottom Pay	Remarks	Casing	
						Size	Set at
Marshall	230' (1532)	390'				10"	223'
Cdwtr. Red Rock	1304' (1542)	1307'				8-1/4"	487'
Sunbury	1455'	(1692)				6-5/8"	2440'
Berea	1487'	(1725)				5-3/16" Liner	2424'-2775'
Antrim	1630' (1868)	1985'			(1227)		
Trav. Lime	1989'	S.L.H. (1227)			Show oil 1989'-1996'		
					(12020) H.F.S.W. 2006' (1244)		
Dundee	2773'	(12013)	2782'	2787'			
Total Depth		2787' (12025)					

Remarks

Signed Dean C. Shackelford