



Western Michigan University
ScholarWorks at WMU

Legacy Scout Tickets from Pure Oil Company

8-20-2021

MGRRE_PureOilScoutTickets_BARNES,
GEORGE_1_21011113040000

MGRRE
Western Michigan University

Follow this and additional works at: <https://scholarworks.wmich.edu/pure>



Part of the Geology Commons

WMU ScholarWorks Citation

MGRRE, "MGRRE_PureOilScoutTickets_BARNES, GEORGE_1_21011113040000" (2021). *Legacy Scout Tickets from Pure Oil Company*. 382.
<https://scholarworks.wmich.edu/pure/382>

This Document is brought to you for free and open access via ScholarWorks at WMU. It has been accepted for inclusion in Legacy Scout Tickets from Pure Oil Company by an authorized administrator of ScholarWorks at WMU. See the National Digital Catalogue - Science Base Catalogue for more collections submitted by MGRRE.



MGRRE_PureOilScoutTickets_BARNES, GEORGE_1_21011113040000

API 21011113040000

Permit Number 11304

Lease Name BARNES, GEORGE

Well Number 1

County Arenac

Township 19N

Range 3E

Section 14

2021 DEQ or Pure co_name MICHIGAN OIL CO

Pure Number 404

Latitude 44.04323

Longitude -84.07991

THE PURE OIL COMPANY

LOCATION REPORT

Date December 28, 1944

A.F.E. No. _____

Division Mich. Producing

District _____

Lease _____

George Barnes
George Barnes

Acres _____ Lease No. _____

Elevation _____

Well No. 1(Serial No. 404)Quadrangle NW-SE-SW
NW SE SWSec. 14Twp. 19 NRge. 3 E~~XXX~~
~~XXX~~
Twp. AdamsAdams

Survey _____

County ArenacState MichiganOperator Michigan Oil CompanyMap Adams Township, Arenac County300 300

Feet from North Line of Lease

" " East " " "

" " South " " "

" " West " " "

Feet from North Line of Section

" " East " 1/4

" " South " " "

" " West " " "

LEGEND

○ Location



Gas Well



Oil Well



Gas - Distillate Well

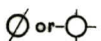

Dry Hole



Dry Showing Oil



Dry Showing Gas



Abandoned Location

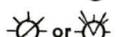

Abandoned Gas Well

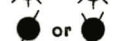

Abandoned Oil Well

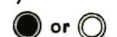

Input Well

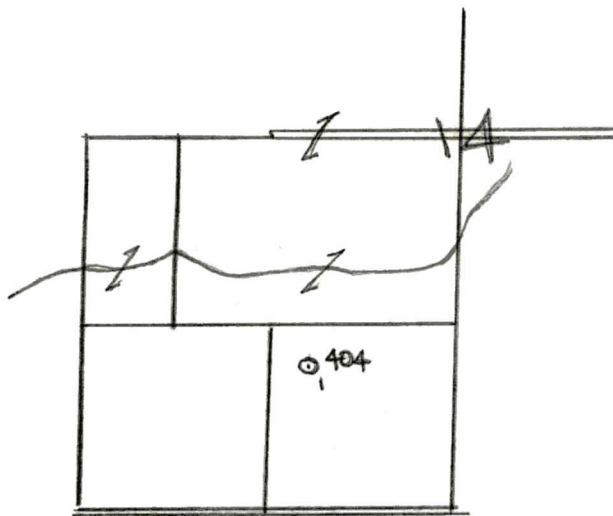

N

Remarks: _____ Scale _____

Submitted by RN

Civil Engineer

Approved by _____

Division Manager

Approved by _____

Vice-President - General Manager

Date **December 38 1947**

LOCATION BEBOBI

V.E.E. No.

COMPLETION RECORD OF WELLS DRILLED BY OTHER OPERATORS

Michigan Producing DivisionDate **April 4, 1945**No. **404**State **Mich.** County **Arenac** Twp. **Adams** Sec. **14** Twp. **19 N** Rge. **3 E**

(Serial No.)

Well No. **1** (~~xxxxxx~~) **404**Farm **Geo. Barnes**

Acres

Operator **Michigan Oil Company**Information secured ~~xxxx~~ By **Scouting Department**Date well started **1-2-45** Date well completed **3-22-45** Elevation **782.3**

PRODUCTION BOARD

1st 24 hours natural **Dry Hole**

2nd 24 hours natural

Date of shot **3-23-45** No. of quarts **40** From **?** To **2866** From toDate of acid **3-27-45** No. of gallons **500**1st 24 hours after acid shot **No results from shot or acid treatment.**

2nd 24 hours after acid shot

FORMATION AND CASING RECORD

| Formation | Top | Bottom | Top Pay | Bottom Pay | Remarks | Casing | |
|------------------------|-------------|---------------|----------------|---------------|---|---------------------------|----------------|
| | | | | | | Size | Set at |
| Marshall | 340 | (+442) | | | H.F.W. 340. (+442) | 10" | 248 |
| | | | | | See remarks below. | 8-1/4" | 522 |
| Coldw. Red Rock | 1460 | 1470 | (-678) | | | 6-5/8" | 2520 |
| Sunbury | 1552 | (-770) | | | | 5-3/16" | 2874 |
| Berea | 1575 | (-793) | | | H.F.W. in Berea. | | |
| Antrim | 1620 | (-838) | | | | | |
| Traverse Lime | 2085 | CTM. | (-1304) | | | | |
| Dundee | 2870 | " | (-2088) | | Very small show oil | 2895-2901. (-2113) | |
| | | | | | 1 ba. oil in 12 hrs. from 2982-2987. | | |
| Total Depth | | 2987 | (-2205) | | | | (-2200) |
| | | | | (+232) | (-158) | | |

Remarks **1 1/2** bailers water per hr. at 550; water at 940; **4 1/2** bailers water per hour from 1015 to 1065. **(-233)****1997' equals 1995' SON; 2403' equals 2406' SLN.**

Signed

D. C. Shackelford