



Western Michigan University
ScholarWorks at WMU

Legacy Scout Tickets from Pure Oil Company

8-20-2021

**MGRRE_PureOilScoutTickets_CURRISTON, ERWIN 35 ET
AL_1_21011113810000**

MGRRE
Western Michigan University

Follow this and additional works at: <https://scholarworks.wmich.edu/pure>



Part of the Geology Commons

WMU ScholarWorks Citation

MGRRE, "MGRRE_PureOilScoutTickets_CURRISTON, ERWIN 35 ET AL_1_21011113810000" (2021).
Legacy Scout Tickets from Pure Oil Company. 394.
<https://scholarworks.wmich.edu/pure/394>

This Document is brought to you for free and open access via ScholarWorks at WMU. It has been accepted for inclusion in Legacy Scout Tickets from Pure Oil Company by an authorized administrator of ScholarWorks at WMU. See the National Digital Catalogue - Science Base Catalogue for more collections submitted by MGRRE.



MGRRE_PureOilScoutTickets_CURRISTON, ERWIN 35 ET AL_1_21011113810000

API 21011113810000

Permit Number 11381

Lease Name CURRISTON, ERWIN 35 ET AL

Well Number 1

County Arenac

Township 20N

Range 5E

Section 26

2021 DEQ or Pure co_name AMERICAN DRILLING CO

Pure Number 416

Latitude 44.11029

Longitude -83.84618

THE PURE OIL COMPANY

LOCATION REPORT

Date February 28, 1945 A.F.E. No. _____
 Division Mich. Producing District _____ Lease Erwin Curriston et al
Erwin Curriston, et al
 Acres _____ Lease No. _____ Elevation _____ Well No. 1 (Serial No. 416)
SW-NW-NW Quadrangle SW NW NW Sec. 26 Twp. 20 N Rge. 5 E Twp. Mason
 Survey _____ County Arenac State Michigan
 Operator American Drilling Co. Map Mason Twp. Arenac Co.
American Drilling Company

Feet from North Line of Lease

" " East " " "

" " South " " "

" " West " " "

Feet from North Line of Section

" " East " " "

" " South " " "

" " West " " "

LEGEND

○ Location

☀ Gas Well

● Oil Well

☀ Gas - Distillate Well

○ or ○ Dry Hole

● Dry Showing Oil

☀ Dry Showing Gas

⊗ Abandoned Location

☀ or ☀ Abandoned Gas Well

● or ● Abandoned Oil Well

● or ○ Input Well

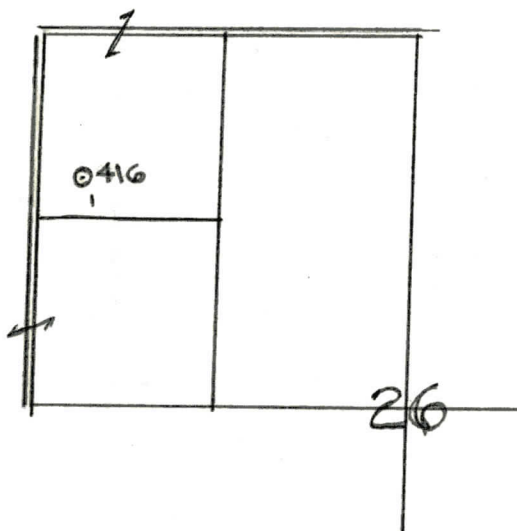

Remarks: _____

Scale _____

Submitted by RJ Civil Engineer

Approved by _____

Division Manager

Approved by _____

Vice-President - General Manager

Date **June 13, 1945**

LOCATION REPORT

V.E.E. No.

COMPLETION RECORD OF WELLS DRILLED BY OTHER OPERATORS

Michigan Producing Division

Date **June 13, 1945**No. **416**State **Mich.** County **Arenac**~~XXXXX~~

Twp.

MasonSec. **26**Twp. **20 N** Rge. **5 E**Well No. **1** (Serial No.) ~~XXXXXXX~~ **416**

Farm

Edwin Curriston, et al AcresOperator **American Drilling Co.**Information secured ~~from~~ By **Scouting Department**Date well started **3-22-45**Date well completed **6-10-45**Elevation **653.2**

PRODUCTION BOARD

1st 24 hours natural

Dry Hole

2nd 24 hours natural

Date of shot No. of quarts From To From to

Date of acid No. of gallons

1st 24 hours after acid shot

2nd 24 hours after acid shot

FORMATION AND CASING RECORD

Formation	Top	Bottom	Top Pay	Bottom Pay	Remarks	Casing	
						Size	Set at
					Flo. Fresh wtr. 63-67.	10"	42
Marshall	116	234	(+537)		(+590)	8-1/4"	465
Coldw. Red Rock	1393	(-140)s				6-5/8"	2435
Sunbury	1414	(-1761)s				5" Liner	2803
Berea	1443	(-190)s			2 ba. S.W. per hr. at 1510.		
Antrim	1626	1986	(-973)s		(-857)		
Traverse Lime	2005	(-1352)			Flo. S.W. 2005-2007.	(-1352)	
Dundee	2803	S.L.M.	(-2150)s		300 ft. S.W. 2960-2963.	(-2307)	
Total Depth		2963	(-2310)				

Remarks **475' equals 465' pipe tally; 1308' eq. 1307' S.L.M.; 2765' equals 2770' S.L.M.; 2903' equals 2892' S.L.M.**

Signed

D. C. Shackelford