



Western Michigan University  
ScholarWorks at WMU

---

Legacy Scout Tickets from Pure Oil Company

---

8-20-2021

MGRRE\_PureOilScoutTickets\_BILARSKI,  
ALEX\_2\_21011121310000

MGRRE  
*Western Michigan University*

Follow this and additional works at: <https://scholarworks.wmich.edu/pure>



Part of the Geology Commons

---

#### WMU ScholarWorks Citation

MGRRE, "MGRRE\_PureOilScoutTickets\_BILARSKI, ALEX\_2\_21011121310000" (2021). *Legacy Scout Tickets from Pure Oil Company*. 506.  
<https://scholarworks.wmich.edu/pure/506>

This Document is brought to you for free and open access via ScholarWorks at WMU. It has been accepted for inclusion in Legacy Scout Tickets from Pure Oil Company by an authorized administrator of ScholarWorks at WMU. See the National Digital Catalogue - Science Base Catalogue for more collections submitted by MGRRE.



---

MGRRE\_PureOilScoutTickets\_BILARSKI, ALEX\_2\_21011121310000

API 21011121310000

Permit Number 12131

Lease Name BILARSKI, ALEX

Well Number 2

County Arenac

Township 19N

Range 4E

Section 24

2021 DEQ or Pure co\_name GORDON OIL CO

Pure Number 528

Latitude 44.03604

Longitude -83.94335

## WELL REPORT - OUTSIDE OPERATIONS

WELL REPORT - OUTSIDE OPERATIONS

SERIAL NO.

528

STATE Michigan ~~XESM~~ CO. ArenacOPERATOR Gordon Oil Co.FARM Alex Bilarski WELL NO. 2TWP. 3828Z Deep River S. 24 T. 19N R. 4ELOC. NE SW NWWILDCAT ☐ FIELD ☐ FIELD NAME \_\_\_\_\_

MAP NO. \_\_\_\_\_ CO-ORD. \_\_\_\_\_ ELEV. \_\_\_\_\_

STATUS Plugged and abandoned 7-29-54Total Depth - 2757'

NORTH

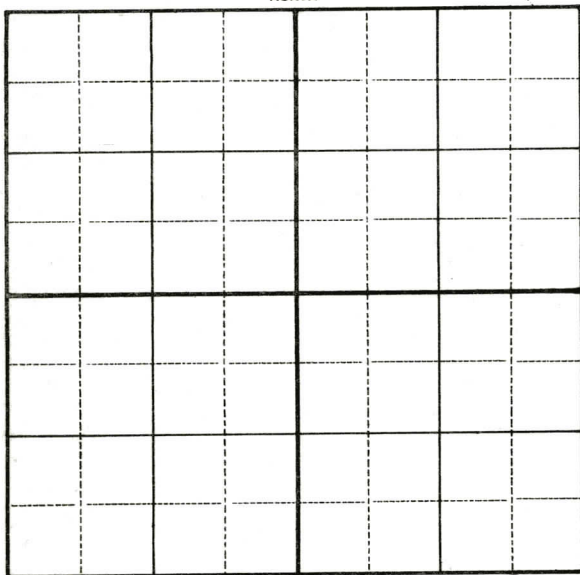
DATE 9-2-54 SCOUT JEC

STATE Michigan ~~XXX~~ CO. Arenac

OPERATOR The Gordon Oil Co.

FARM Alex Bilarski WELL NO. 1-2-3-5

TWP. Deep River S. 24 T. 19N R. 4E

LOC. \_\_\_\_\_

WILDCAT ☐ FIELD ☐ FIELD NAME \_\_\_\_\_

MAP NO. \_\_\_\_\_ CO-ORD. \_\_\_\_\_ ELEV. \_\_\_\_\_

STATUS \_\_\_\_\_

Operator's name corrected from:  
Ervin Major

NORTH

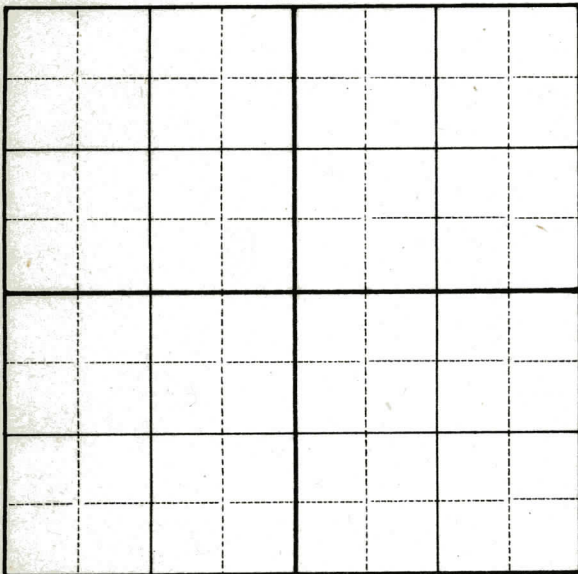

DATE 8-4-53 SCOUT JEC

# THE PURE OIL COMPANY

## LOCATION REPORT

Date February 20, 1946 A.F.E. No. Alex Bilarski  
 Division Mich. Producing District \_\_\_\_\_ Lease Alex Bilarski  
 Acres \_\_\_\_\_ Lease No. \_\_\_\_\_ Elevation \_\_\_\_\_ Well No. 2 (Serial No. 528)  
 Quadrangle NE-SW-NW Sec. 24 Twp. 19 N Rge. 4 E Twp. Deep River  
 Survey \_\_\_\_\_ County Arenac State Michigan  
 Operator Ervin Major Map Deep River Township, Arenac County

Feet from North Line of Lease  
330 330 " " East " " "  
330 330 " " South " " "  
 " " West " " "  
 Feet from North Line of Section  
990 990 " " East " " "  
990 990 " " South " 1/4 "  
 " " West " " "

### LEGEND

○ Location

☀ Gas Well

● Oil Well

☀ Gas - Distillate Well

○ or ○ Dry Hole

● Dry Showing Oil

☀ Dry Showing Gas

⊗ Abandoned Location

☀ or ☀ Abandoned Gas Well

● or ● Abandoned Oil Well

● or ○ Input Well

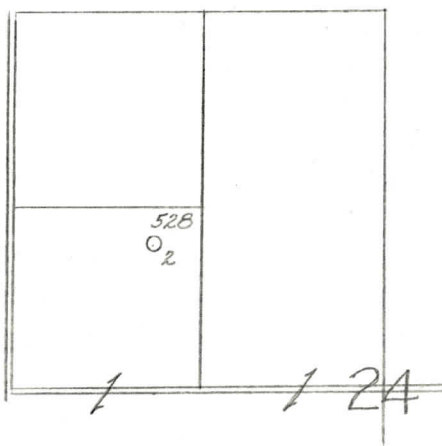

N



Scale \_\_\_\_\_

Remarks: \_\_\_\_\_  
 \_\_\_\_\_  
 \_\_\_\_\_

Submitted by CB Civil Engineer Approved by \_\_\_\_\_ Division Manager  
 Approved by \_\_\_\_\_ Vice-President - General Manager



