



Western Michigan University  
ScholarWorks at WMU

---

Legacy Scout Tickets from Pure Oil Company

---

8-20-2021

**MGRRE\_PureOilScoutTickets\_BUFFALO  
LAND\_5\_21011128660000**

MGRRE  
*Western Michigan University*

Follow this and additional works at: <https://scholarworks.wmich.edu/pure>



Part of the Geology Commons

---

#### **WMU ScholarWorks Citation**

MGRRE, "MGRRE\_PureOilScoutTickets\_BUFFALO LAND\_5\_21011128660000" (2021). *Legacy Scout Tickets from Pure Oil Company*. 563.  
<https://scholarworks.wmich.edu/pure/563>

This Document is brought to you for free and open access via ScholarWorks at WMU. It has been accepted for inclusion in Legacy Scout Tickets from Pure Oil Company by an authorized administrator of ScholarWorks at WMU. See the National Digital Catalogue - Science Base Catalogue for more collections submitted by MGRRE.



---

**MGRRE\_PureOilScoutTickets\_BUFFALO LAND\_5\_21011128660000**

API 21011128660000

Permit Number 12866

Lease Name BUFFALO LAND

Well Number 5

County Arenac

Township 20N

Range 4E

Section 10

2021 DEQ or Pure co\_name SUMMIT PETROLEUM CORP AND MUSKEGON DEVELOPMENT C

Pure Number 585

Latitude 44.155589

Longitude -83.9838377

WELL REPORT - OUTSIDE OPERATIONS

SERIAL NO. 585

STATE Michigan ~~XPSHX~~ Arenac  
CO.

OPERATOR Will C. Mee

FARM Buffalo Land Company WELL NO. 5

TWP. Clayton S. 10 T. 20N R. 4E  
~~XSDRYKX~~

LOC. NE NW NW

WILDCAT  FIELD  FIELD NAME \_\_\_\_\_

MAP NO. \_\_\_\_\_ CO-ORD. \_\_\_\_\_ ELEV. \_\_\_\_\_

STATUS \_\_\_\_\_

Operators named changed from  
McClanahan Oil Company & W. C. Mee.  
NORTH

DATE 10-8-51 SCOUT DRS

THE PURE OIL COMPANY  
LOCATION REPORT

Date Dec. 24, 1946

A.F.E. No. Buffalo Land

Division Mich. Producing

District \_\_\_\_\_

Lease Buffalo Land

Acres \_\_\_\_\_

Lease No. \_\_\_\_\_

Elevation \_\_\_\_\_

Well No. 5

(Serial No. 585)

Quadrangle NE NW NW

Sec. 10

Twp. 20 N

Rge. 4 E

Twp. Clayton

Survey \_\_\_\_\_

County Arenac

State Michigan

Operator McClanahan Oil Co.  
McClanahan Oil Company & W. C. Mee

Map Clayton Township, Arenac County

330 330

Feet from North Line of Lease

" " East " " "

" " South " " "

" " West " " "

990 990

Feet from North Line of Section

" " East " " "

" " South " " "

" " West " " "

990 990

Low

LEGEND

- ☀ Gas Well
- Oil Well
- ☀ Gas - Distillate Well
- ∅ or ○ Dry Hole
- Dry Showing Oil
- Location
- ☉ Dry Showing Gas
- ⊗ Abandoned Location
- ☀ or ☀ Abandoned Gas Well
- or ● Abandoned Oil Well
- or ○ Input Well

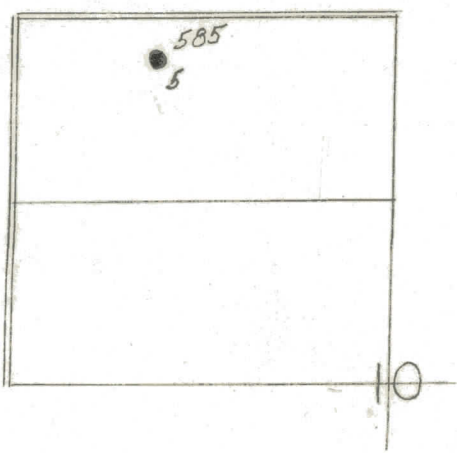

Remarks: \_\_\_\_\_

Scale \_\_\_\_\_

Submitted by CB \_\_\_\_\_  
Civil Engineer

Approved by \_\_\_\_\_  
Division Manager

Approved by \_\_\_\_\_  
Vice-President - General Manager