



Western Michigan University
ScholarWorks at WMU

Legacy Scout Tickets from Pure Oil Company

8-20-2021

MGRRE_PureOilScoutTickets_Glander_1_21017032370000

MGRRE

Western Michigan University

Follow this and additional works at: <https://scholarworks.wmich.edu/pure>



Part of the Geology Commons

WMU ScholarWorks Citation

MGRRE, "MGRRE_PureOilScoutTickets_Glander_1_21017032370000" (2021). *Legacy Scout Tickets from Pure Oil Company*. 680.

<https://scholarworks.wmich.edu/pure/680>

This Document is brought to you for free and open access via ScholarWorks at WMU. It has been accepted for inclusion in Legacy Scout Tickets from Pure Oil Company by an authorized administrator of ScholarWorks at WMU. See the National Digital Catalogue - Science Base Catalogue for more collections submitted by MGRRE.



MGRRE_PureOilScoutTickets_Glander_1_21017032370000

API 21017032370000

Permit Number 3237

Lease Name Glander

Well Number 1

County Bay

Township 14N

Range 03E

Section 18

2021 DEQ or Pure co_name McEvoy, Henry L.

Pure Number 22

Latitude 43.62004

Longitude -84.1521

COMPLETION RECORD THE PURE OIL COMPANY OTHER OPERATORS

DATE May 7, 1936

LOCATION REPORT

No. 22

STATE Michigan COUNTY Bay DIST. Williams TWP. Williams SEC. 18 TOWN 14 N RANGE 3 E

WELL No. 1 (SERIAL No. 22) FARM Glander ACRES

NAME OF STREAM OR WATERS QUADRANGLE SW SE NE

OPERATOR Henry L. McEvoy Map Williams Township, Bay County

Feet from North Line of Farm

" " East " " "

330 " " South " " "

330 " " West " " "

Feet from North Line of Section

990 " " East " " "

330 " " South " 1/4 "

" " West " " "

July 10' spaced 5-5-36

LEGEND

- LOCATION
- ⊕ RIG
- ⊕ DRILLING
- ☀ GAS WELL
- OIL WELL
- ⬮ SMALL OIL WELL
- ⊕ DRY HOLE
- ⬮ DRY SHOWING OIL
- ⊕ DRY SHOWING GAS
- ⊕ ABANDONED LOCATION
- ☀ ABANDONED GAS WELL
- ⬮ ABANDONED OIL WELL

NOTE: Below make tracing from map, (when no map is obtainable make sketch) showing farm, center of section, this location with measurements and also wells, dry holes, or other locations in the vicinity of this location.

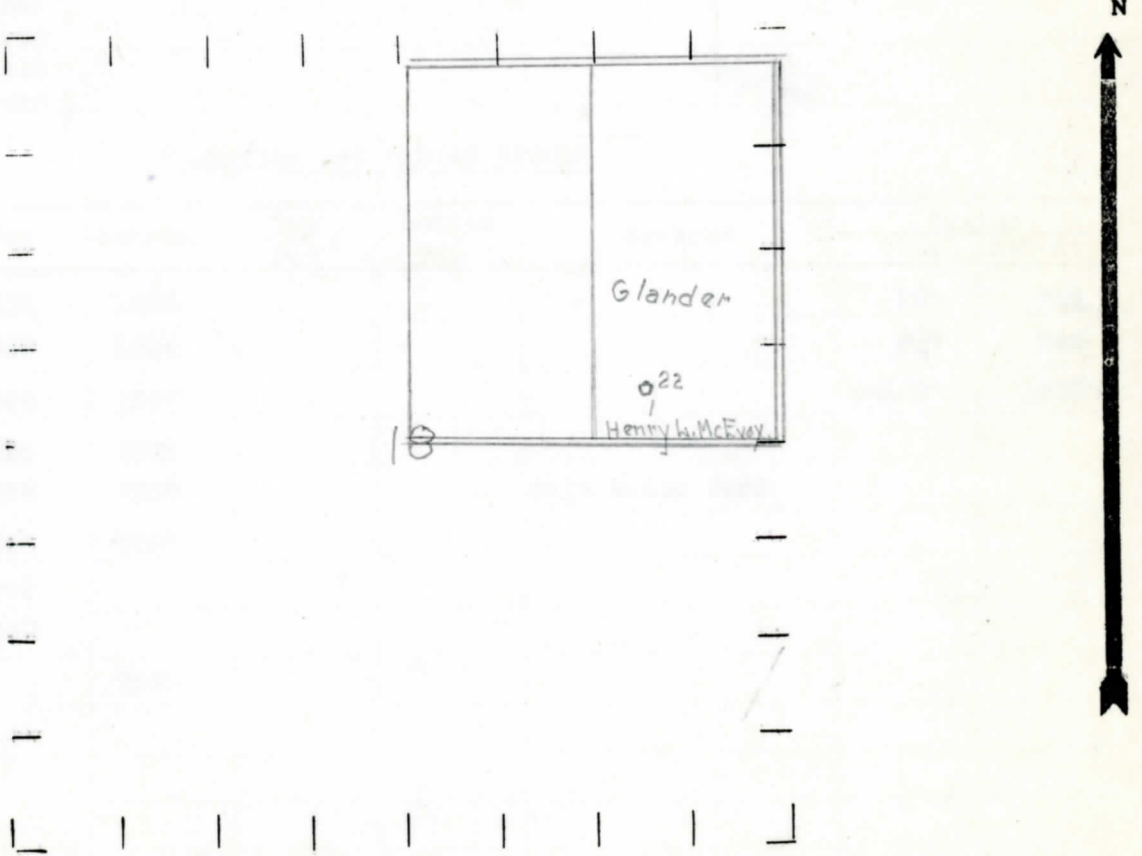

REMARKS:

SIGNED

R. L. Jags
Superintendent or Foreman.

RECEIVED
 DIVISION
 COMM. BEA
 BREC LAL DISL
 Michigan Producing
 No. 22
 Dist. Williams
 Sec. 18 Twp. 14 N Rge. 3 E
 Farm Glander
 Acres
 Operator Henry L. McEvoy
 Information secured by Scouting Department
 Date well started 5-5-36 Date well completed 8-23-36 Elevation 655.8

Date August 27, 1936 No. 22
 State Michigan County Bay Dist. Williams
 (Serial No.) Twp. Williams Sec. 18 Twp. 14 N Rge. 3 E
 Well No. 1 (County No.) 22 Farm Glander Acres _____
 Operator Henry L. McEvoy Information secured ~~from~~ Scouting Department
 Date well started 5-5-36 Date well completed 8-23-36 Elevation 655.8

PRODUCTION RECORD

1st 24 hours natural Dry Hole
 2nd 24 hours natural _____
 Date of shot _____ No. of quarts _____ From _____ to _____ From _____ to _____
 Date of acid _____ No. of gallons _____
 1st 24 hours after acid shot _____
 2nd 24 hours after acid shot _____

FORMATION AND CASING RECORD

Formation	Top	Bottom	Top Pay	Bottom Pay	Remarks	Casing	
						Size	Set At
Marshall	1131	1233				10"	232
Red Rock	1233	1314				8 1/4"	860
Red Rock	1320	1327				6-5/8"	1353
Sunbury	2355	2378					
Berea	2378	2500			Salt water 2468		
Antrim	2542	2908					
Traverse	2908						
Dundee	3590						
Total Depth		3772					

Remarks Salt water 3749-3760-H.F.S.W. 3772.

Signed J.M. Bell