



Western Michigan University
ScholarWorks at WMU

Legacy Scout Tickets from Pure Oil Company

8-20-2021

**MGRRE_PureOilScoutTickets_Delong Daniel
J_1_21017032470000**

MGRRE
Western Michigan University

Follow this and additional works at: <https://scholarworks.wmich.edu/pure>



Part of the Geology Commons

WMU ScholarWorks Citation

MGRRE, "MGRRE_PureOilScoutTickets_Delong Daniel J_1_21017032470000" (2021). *Legacy Scout Tickets from Pure Oil Company*. 681.
<https://scholarworks.wmich.edu/pure/681>

This Document is brought to you for free and open access via ScholarWorks at WMU. It has been accepted for inclusion in Legacy Scout Tickets from Pure Oil Company by an authorized administrator of ScholarWorks at WMU. See the National Digital Catalogue - Science Base Catalogue for more collections submitted by MGRRE.



MGRRE_PureOilScoutTickets_Delong Daniel J_1_21017032470000

API 21017032470000

Permit Number 3247

Lease Name Delong Daniel J

Well Number 1

County Bay

Township 16N

Range 03E

Section 35

2021 DEQ or Pure co_name Weber, Alvin H.

Pure Number 23

Latitude 43.74019

Longitude -84.0684

COMPLETION RECORD THE PURE OIL COMPANY OTHER OPERATORS

DATE May 7, 1936

LOCATION REPORT

No. 23

STATE Michigan COUNTY Bay DIST. Garfield TWP. Garfield SEC. 35 TOWN 16 N RANGE 3 E

WELL No. 1 (SERIAL No. 23) FARM Daniel J. DeLong ACRES

NAME OF STREAM OR WATERS QUADRANGLE SE SE SE

OPERATOR Alvin H. Weber Map Garfield Township, Bay County

Feet from North Line of Farm

280 280 " " East " " "

280 280 " " South " " "

" " West " " "

Feet from North Line of Section

280 280 " " East " " "

280 280 " " South " " "

" " West " " "



LEGEND

- LOCATION
- ⊕ RIG
- ⊕ DRILLING
- ☀ GAS WELL
- OIL WELL
- ◆ SMALL OIL WELL
- ⊖ DRY HOLE
- ◆ DRY SHOWING OIL
- ☀ DRY SHOWING GAS
- ⊖ ABANDONED LOCATION
- ☀ ABANDONED GAS WELL
- ◆ ABANDONED OIL WELL

NOTE: Below make tracing from map, (when no map is obtainable make sketch) showing farm, center of section, this location with measurements and also wells, dry holes, or other locations in the vicinity of this location.

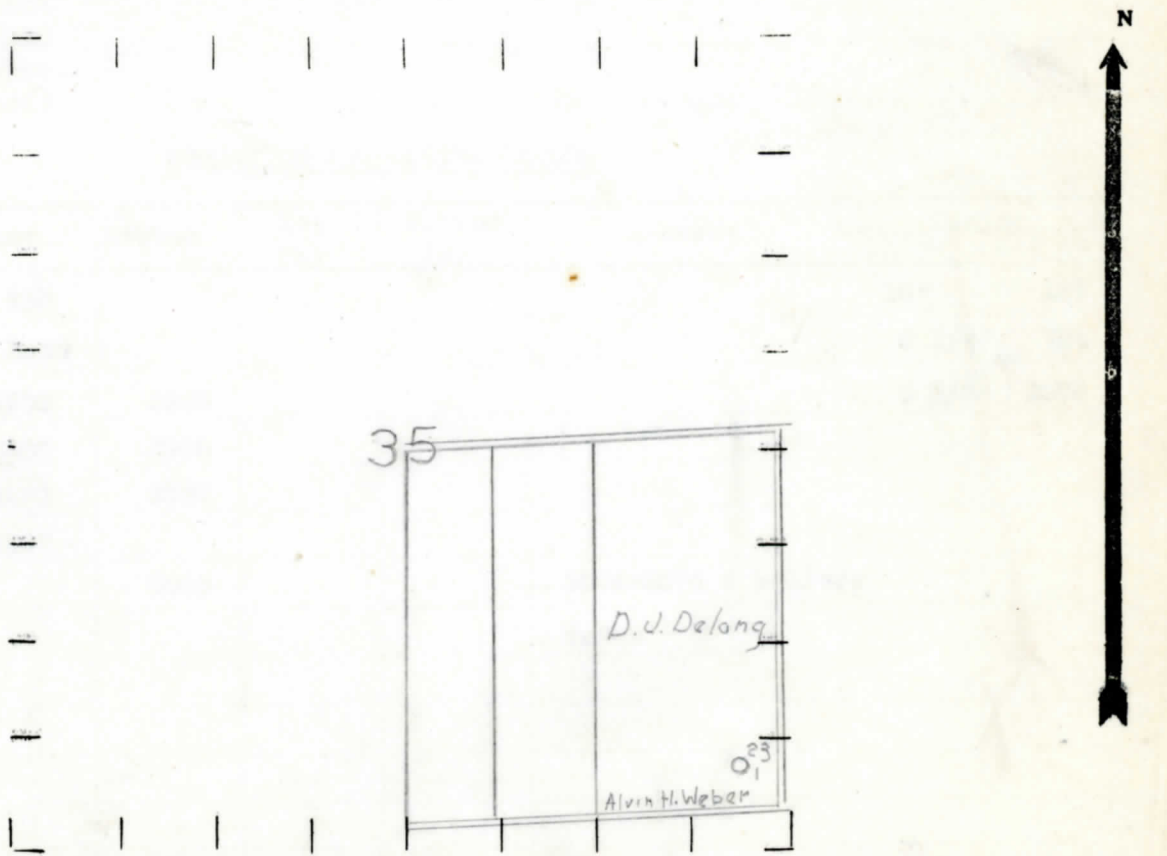

REMARKS:

SIGNED

R. L. Yeager

Superintendent or Foreman.

Michigan Producing Division

Date **July 2, 1936** No. **23**
 State **Michigan** County **Bay** Dist. **Garfield**
 (Serial No.) Twp. **6N** Sec. **35** Rge. **3E**
 Well No. **1** (County No.) **23** Farm **Daniel J. Delong** Acres _____
 Operator **Alvin H. Weber** Information secured from **Scouting Department**
 Date well started **5-16-36** Date well completed **6-26-36** Elevation **641.7**

PRODUCTION RECORD

1st 24 hours natural **Dry Hole**
 2nd 24 hours natural _____
 Date of shot _____ No. of quarts _____ From _____ to _____ From _____ to _____
 Date of acid _____ No. of gallons _____
 1st 24 hours after acid shot _____
 2nd 24 hours after acid shot _____

FORMATION AND CASING RECORD

Formation	Top	Bottom	Top Pay	Bottom Pay	Remarks	Casing	
						Size	Set At
Marshall	650					10"	187
Red Rock	None					8 1/4"	784
Berea	1905	2005				6 5/8"	2009
Traverse	2425	2905					
Dundee	3170	3527					
Monroe	3527						
Total Depth		3576			3574-3576 6 bailers water		

Remarks _____

Signed _____