



Western Michigan University
ScholarWorks at WMU

Legacy Scout Tickets from Pure Oil Company

8-20-2021

MGRRE_PureOilScoutTickets_Arnold_1_21017058310000

MGRRE

Western Michigan University

Follow this and additional works at: <https://scholarworks.wmich.edu/pure>



Part of the Geology Commons

WMU ScholarWorks Citation

MGRRE, "MGRRE_PureOilScoutTickets_Arnold_1_21017058310000" (2021). *Legacy Scout Tickets from Pure Oil Company*. 696.

<https://scholarworks.wmich.edu/pure/696>

This Document is brought to you for free and open access via ScholarWorks at WMU. It has been accepted for inclusion in Legacy Scout Tickets from Pure Oil Company by an authorized administrator of ScholarWorks at WMU. See the National Digital Catalogue - Science Base Catalogue for more collections submitted by MGRRE.



MGRRE_PureOilScoutTickets_Arnold_1_21017058310000

API 21017058310000

Permit Number 5831

Lease Name Arnold

Well Number 1

County Bay

Township 14N

Range 04E

Section 10

2021 DEQ or Pure co_name Wicklund, J. V. Development Company

Pure Number 38

Latitude 43.62966

Longitude -83.97257

THE PURE OIL COMPANY
 COMPLETION RECORD OF WELLS DRILLED BY OTHER OPERATORS
 LOCATION REPORT

DATE February 9, 1939

No. 38

STATE Michigan COUNTY Bay DIST. Monitor TWP. Monitor SEC. 10 TOWN 14 N RANGE 4 E
 WELL No. 1 (SERIAL No. 38) FARM Arnold ACRES

NAME OF STREAM OR WATERS _____ QUADRANGLE 6E 2 N 15 E - SE

OPERATOR J. V. Wicklund Development Co. Map Monitor Township, Bay County

660 660 J. V. Wicklund Dev. Co. Monitor - Bay Co.
 Feet from North Line of Farm

330 330 " " East " " "

660 660 " " South " " "

" " West " " "

660 660 Feet from North Line of Section

330 330 " " East " " "

" " South " " "

" " West " " "

LEGEND

- LOCATION
- ⊙ RIG
- ⊕ DRILLING
- ☀ GAS WELL
- OIL WELL
- ⦿ SMALL OIL WELL
- ⊖ DRY HOLE
- ⦿ DRY SHOWING OIL
- ⊖ DRY SHOWING GAS
- ⊖ ABANDONED LOCATION
- ☀ ABANDONED GAS WELL
- ⦿ ABANDONED OIL WELL

NOTE: Below make tracing from map, (when no map is obtainable make sketch) showing farm, center of section, this location with measurements and also wells, dry holes, or other locations in the vicinity of this location.

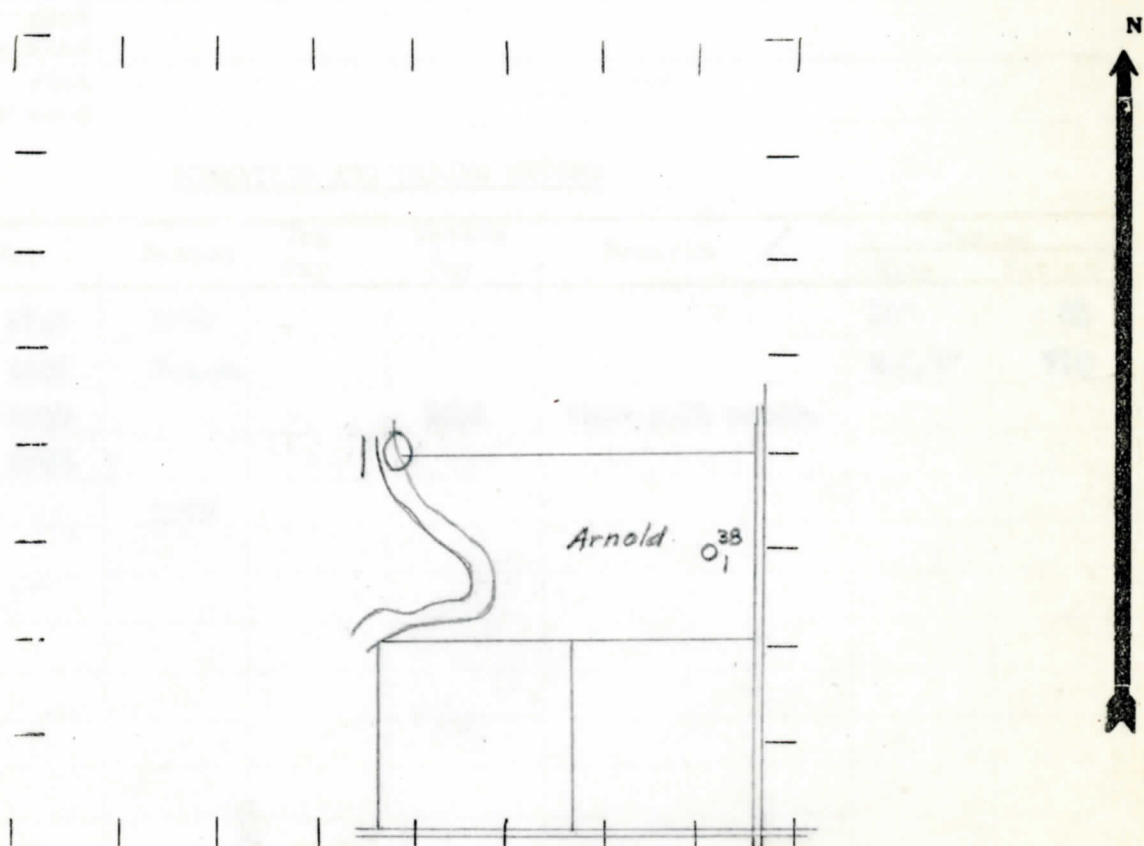

REMARKS:

SIGNED

 Superintendent or Foreman.

