



Western Michigan University
ScholarWorks at WMU

Legacy Scout Tickets from Pure Oil Company

8-20-2021

MGRRE_PureOilScoutTickets_Kircher, John H & Sophia_1_21017079000000

MGRRE

Western Michigan University

Follow this and additional works at: <https://scholarworks.wmich.edu/pure>



Part of the Geology Commons

WMU ScholarWorks Citation

MGRRE, "MGRRE_PureOilScoutTickets_Kircher, John H & Sophia_1_21017079000000" (2021). *Legacy Scout Tickets from Pure Oil Company*. 700.
<https://scholarworks.wmich.edu/pure/700>

This Document is brought to you for free and open access via ScholarWorks at WMU. It has been accepted for inclusion in Legacy Scout Tickets from Pure Oil Company by an authorized administrator of ScholarWorks at WMU. See the National Digital Catalogue - Science Base Catalogue for more collections submitted by MGRRE.



MGRRE_PureOilScoutTickets_Kircher, John H & Sophia_1_21017079000000

API 21017079000000

Permit Number 7900

Lease Name Kircher, John H & Sophia

Well Number 1

County Bay

Township 14N

Range 04E

Section 2

2021 DEQ or Pure co_name Muskegon Development Company

Pure Number 42

Latitude 43.6465784

Longitude -83.9598191

THE PURE OIL COMPANY

The Pure Oil Company

LOCATION REPORT

42

DATE August 14, 1940

No.

SECTION RECORD OF WELLS DRILLED BY OTHER OPERATORS

STATE Michigan COUNTY Bay DISTRICT Monitor TWP. Monitor SEC. 2 TOWN 14 N RANGE 4 E
WELL No. 1 (SERIAL No. 42) FARM John H. and Sophia Kircher ACRES

NAME OF STREAM OR WATERS QUADRANGLE SW SW NE

OPERATOR L. C. MacGregor Map Monitor Township, Bay County

530 530 Feet from North Line of Farm

East " " "

South " " "

900 900 West " " "

Feet from North Line of Section

East " " "

240 240 South " 1/4 "

240 240 West " " "

LEGEND

- LOCATION
- ⊕ RIG
- ⊕ DRILLING
- ☀ GAS WELL
- OIL WELL
- ◆ SMALL OIL WELL
- ⊙ DRY HOLE
- ◆ DRY SHOWING OIL
- ⊙ DRY SHOWING GAS
- ⊙ ABANDONED LOCATION
- ☀ ABANDONED GAS WELL
- ◆ ABANDONED OIL WELL

NOTE: Below make tracing from map. (when no map is obtainable make sketch) showing farm, center of section, this location with measurements and also wells, dry holes, or other locations in the vicinity of this location.

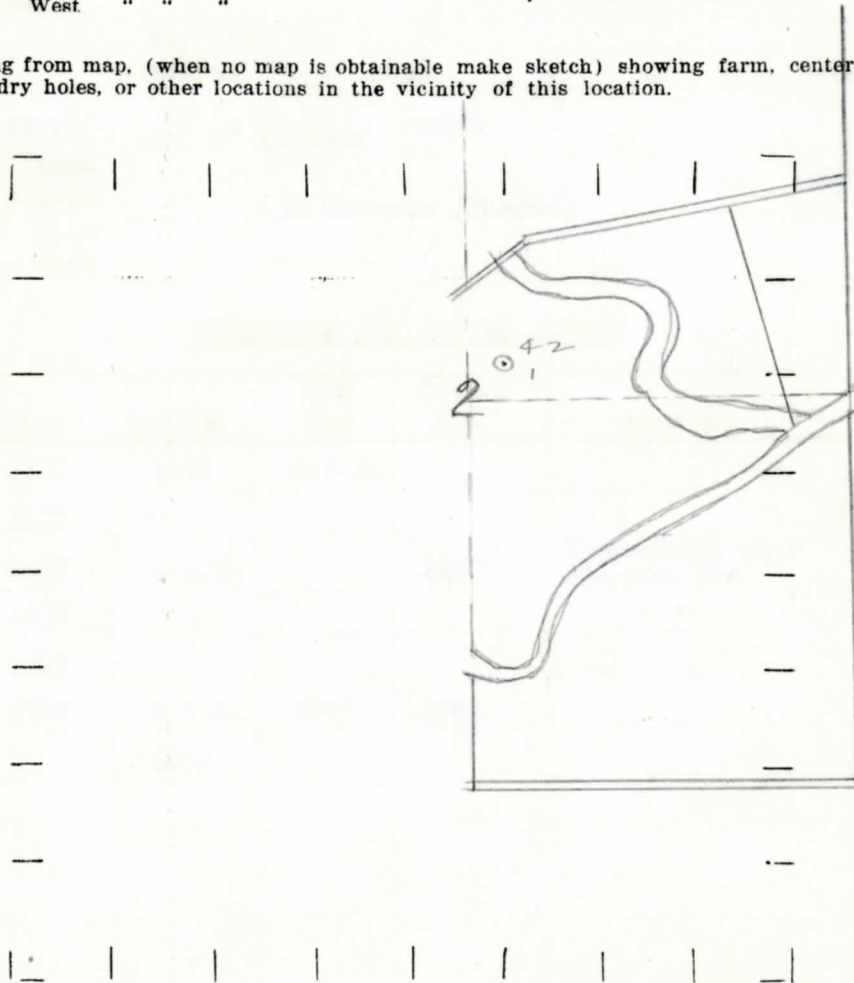

REMARKS:

SIGNED

Superintendent or Foreman.

Michigan Producing Division

Date **October 9, 1940** No. **42**
 State **Mich.** County **Bay** District **Monitor** Twp. **14 N** Rge. **4 E**
 Well No. **1** (Serial No.) **42** Farm **John H. Kircher** Acres
 Operator **L. C. MacGregor** Information secured ~~from~~ **Scouting Department**
 Date well started **8-23-40** Dated well completed **9-22-40** Elevation **593.5**

PRODUCTION RECORD

36
 1st ~~24~~ hours natural **Hole filled up with oil.**
 2nd 24 hours natural
 Date of shot No. of quarts From to From to
 Date of acid **9-27-40** No. of gallons **2000**
16
 1st ~~24~~ hours after acid **130 Barrels (Pumped)**
 shot
 2nd 24 hours after acid

FORMATION AND CASING RECORD

Formation	Top	Bottom	Top Pay	Bottom Pay	Remarks	Casing	
						Size	Set at
Coldw. Red Rock	1350	1355	S.L.M.			10"	85
Sunbury	1477					8-1/4"	740
Berea	1489	S.L.M.		1497	Very small show oil and gas.	6-5/8"	1675
Antrim	1675					5-3/16"	2710
Traverse Lime	2015						
Dundee	2702	S.L.M.	2771	2782			
Total Depth		2850					

Remarks **1525' C.T.M. equals 1532' S.L.M.**

Signed **D. C. Shackelford**