



Western Michigan University
ScholarWorks at WMU

Legacy Scout Tickets from Pure Oil Company

8-20-2021

MGRRE_PureOilScoutTickets_Bateson_1_21017086420000

MGRRE

Western Michigan University

Follow this and additional works at: <https://scholarworks.wmich.edu/pure>



Part of the Geology Commons

WMU ScholarWorks Citation

MGRRE, "MGRRE_PureOilScoutTickets_Bateson_1_21017086420000" (2021). *Legacy Scout Tickets from Pure Oil Company*. 717.

<https://scholarworks.wmich.edu/pure/717>

This Document is brought to you for free and open access via ScholarWorks at WMU. It has been accepted for inclusion in Legacy Scout Tickets from Pure Oil Company by an authorized administrator of ScholarWorks at WMU. See the National Digital Catalogue - Science Base Catalogue for more collections submitted by MGRRE.



MGRRE_PureOilScoutTickets_Bateson_1_21017086420000

API 21017086420000

Permit Number 8642

Lease Name Bateson

Well Number 1

County Bay

Township 14N

Range 04E

Section 2

2021 DEQ or Pure co_name Yost Energy, Incorporated

Pure Number 59

Latitude 43.6409548

Longitude -83.9524087

THE PURE OIL COMPANY

DATE May 28, 1941

LOCATION REPORT

No. 59

COMPLETION RECORD OF WELLS DRILLED BY OTHER OPERATORS

STATE Michigan COUNTY Bay TWP Monitor SEC. 2 TOWN 14 N RANGE 4 E
WELL No. 1 (SERIAL No. 59) FARM Bateson ACRES

NAME OF STREAM OR WATERS _____ QUADRANGLE NE SE SE

OPERATOR Basin Oil Company Map Monitor Township, Bay County

Basin Oil Co

Monitor Bay

_____ Feet from North Line of Farm

_____ " " East " " "

860 860 " " South " " "

330 330 " " West " " "

_____ Feet from North Line of Section

330 330 " " East 1/4 " "

860 860 " " South " " "

_____ " " West " " "

LEGEND

- LOCATION
- ⊙ RIG
- ⊕ DRILLING
- ☀ GAS WELL
- OIL WELL
- ◆ SMALL OIL WELL
- ⊙ DRY HOLE
- ◆ DRY SHOWING OIL
- ⊙ DRY SHOWING GAS
- ⊙ ABANDONED LOCATION
- ☀ ABANDONED GAS WELL
- ABANDONED OIL WELL

NOTE: Below make tracing from map. (when no map is obtainable make sketch) showing farm, center of section, this location with measurements and also wells, dry holes, or other locations in the vicinity of this location.

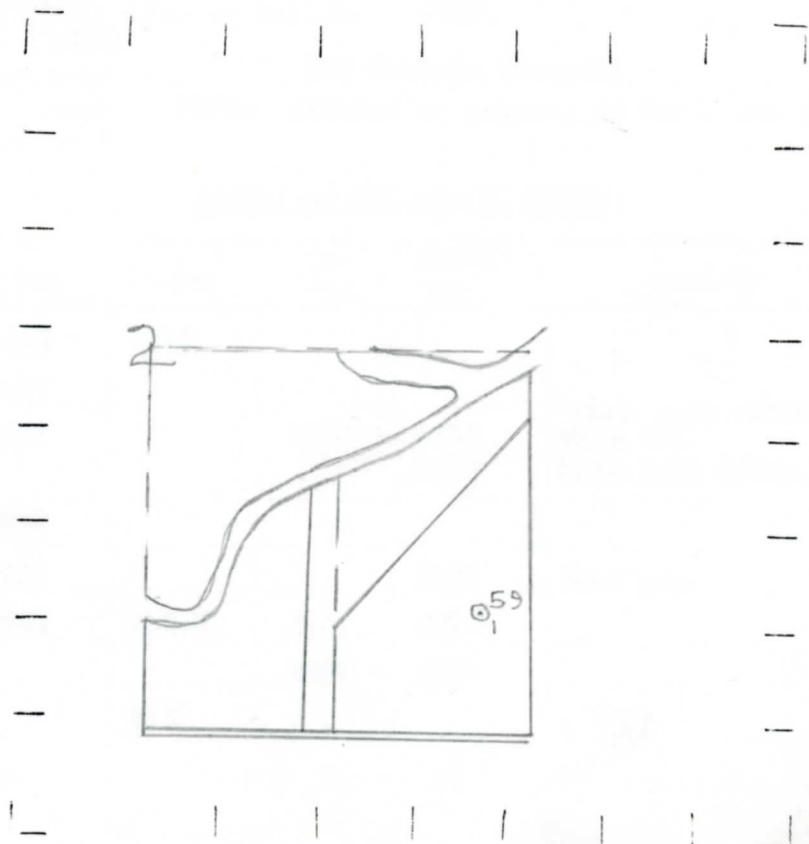

REMARKS:

SIGNED

W

Subintendent or Foreman.

Basin Oil Company
 OBSERVATION BASIN OIL COMPANY
 NAME OF SURVEYOR OR MAINTENANCE
 WELL NO. 1 (SERIAL NO. 28) 59
 Twp. Monitor Sec. 2 Twp. 14 N Rge. 4 E
 Farm Bateson Acres
 Operator Basin Oil Company Information secured By Scouting Department
 Date well started 6-3-41 Date well completed 6-30-41 Elevation 593.2

PRODUCTION RECORD

30
 1st ~~24~~ hours natural Filled up 2200 ft.
 2nd 24 hours natural
 Date of shot No. of quarts From to From to
 Date of acid 7-8-41 No. of gallons 1000
 1st 24 hours after acid shot 163 Barrels (Pumped)
 2nd 24 hours after acid shot NOTE: Settled to pumping 50 bbls. per day.

FORMATION AND CASING RECORD

Formation	Top	Bottom	Top Pay	Bottom Pay	Remarks	Casing	
						Size	Set at
Coldw. Red Rock	1243	1248				10"	102
Sunbury	1477					8-1/4"	775
Berea	1499		1500	1503	Show salt water & Show oil.	6-5/8"	1670
				1583	Hole full water.	5-3/16"	2713
Antrim	1690						
Traverse Lime	2020			2130	Show gas.		
Dundee	2707	S.L.M.	2763	2776			
			2802	2837			
Total Depth		2857					

Remarks 3 Bailers water from 225'-230'-hole full water at 256'. Pumped 140 bbls. 1st. 6 days natural.

Signed D. C. Shackelford