



Western Michigan University
ScholarWorks at WMU

Legacy Scout Tickets from Pure Oil Company

8-20-2021

MGRRE_PureOilScoutTickets_Staudacher, G_1_21017086550000

MGRRE

Western Michigan University

Follow this and additional works at: <https://scholarworks.wmich.edu/pure>



Part of the Geology Commons

WMU ScholarWorks Citation

MGRRE, "MGRRE_PureOilScoutTickets_Staudacher, G_1_21017086550000" (2021). *Legacy Scout Tickets from Pure Oil Company*. 719.

<https://scholarworks.wmich.edu/pure/719>

This Document is brought to you for free and open access via ScholarWorks at WMU. It has been accepted for inclusion in Legacy Scout Tickets from Pure Oil Company by an authorized administrator of ScholarWorks at WMU. See the National Digital Catalogue - Science Base Catalogue for more collections submitted by MGRRE.



MGRRE_PureOilScoutTickets_Staudacher, G_1_21017086550000

API 21017086550000

Permit Number 8655

Lease Name Staudacher, G

Well Number 1

County Bay

Township 14N

Range 04E

Section 2

2021 DEQ or Pure co_name Muskegon Development Company

Pure Number 61

Latitude 43.64944

Longitude -83.96918

THE PURE OIL COMPANY

The Pure Oil Company

LOCATION REPORT

COMPLETION RECORD OF OTHER OPERATORS

No. 61

DATE June 4, 1941

STATE Michigan COUNTY Bay DIST. Monitor TWP. Monitor DIVISION SEC. 2 TOWN 14 N RANGE 4 E

WELL No. 1 (SERIAL No. 61) FARM G. Staudacher ACRES

NAME OF STREAM OR WATERS QUADRANGLE NW SW NW

OPERATOR L. C. MacGregor Map Monitor Township, Bay County

330 330 Feet from North Line of Farm

East " " "

South " " "

330 330 West " " "

Feet from North Line of Section

East " " "

1260 1260 South " 1/4"

220 220 West " " "

LEGEND

- LOCATION
- ⊙ RIG
- ⊕ DRILLING
- ☀ GAS WELL
- OIL WELL
- ⬤ SMALL OIL WELL
- ⊖ DRY HOLE
- ⬤ DRY SHOWING OIL
- ☀ DRY SHOWING GAS
- ⊖ ABANDONED LOCATION
- ☀ ABANDONED GAS WELL
- ⬤ ABANDONED OIL WELL

NOTE: Below make tracing from map, (when no map is obtainable make sketch) showing farm, center of section, this location with measurements and also wells, dry holes, or other locations in the vicinity of this location.

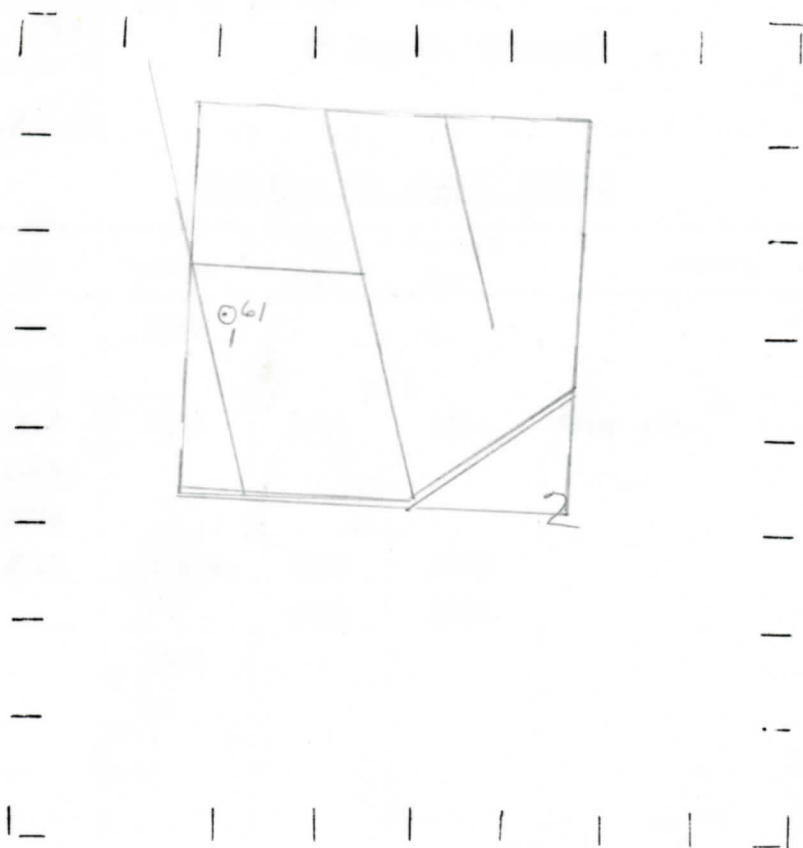

REMARKS:

Blank lines for remarks.

SIGNED

Handwritten signature 'W'

Superintendent or Foreman.

330
 DATE June 3, 1941
 OBEKVLOH T. C. MacGregor
 NAME OF BELIEVER OR APPLICANT
 (SERIAL NO. 61)
 THE PURE OIL COMPANY
 MONITOR COMPANY
 TWP. 14 N RGE. 4 E
 COUNTY Bay

Date **September 4, 1941** No. **61**
 State **Mich.** County **Bay** ~~Disc.~~ **Monitor** Sec. **2** Twp. **14 N** Rge. **4 E**
 Well No. **1** (~~Serial No.~~) **61** Farm **G. Staudacher** Acres _____
 Operator **L. C. MacGregor** Information secured ~~xxxx~~ **By Scouting Department**
 Date well started **7-13-41** Date well completed **8-18-41** Elevation **594.2**

PRODUCTION RECORD

1st 24 hours natural **Filled up 1500 ft.**
 2nd 24 hours natural _____
 Date of shot _____ No. of quarts _____ From _____ to _____ From _____ to _____
 Date of acid **8-21-41** No. of gallons **2000**
 1st 24 hours after acid ~~xxxx~~ **55 Barrels (Pumped)**
 shot _____
 2nd 24 hours after acid _____

FORMATION AND CASING RECORD

| Formation | Top | Bottom | Top Pay | Bottom Pay | Remarks | Casing | |
|-----------------|------|--------|---------|------------|-----------|---------|--------|
| | | | | | | Size | Set at |
| Coldw. Red Rock | 1365 | 1369 | | | | 10" | 93 |
| Sunbury | 1485 | | | | | 8-1/4" | 750 |
| Berea | 1506 | 1675 | 1506 | 1514 | Show oil. | 6-5/8" | 1683 |
| Antrim | 1695 | | | | | 5-3/16" | 2723 |
| Traverse Lime | 2025 | | | | | | |
| Dundee | 2712 | S.L.M. | 2772 | 2783 | | | |
| | | | 2810 | 2845 | | | |
| Total Depth | | 2871 | | | | | |

Remarks **1349' C.T.M. equals 1349' S.L.M.**

Signed **D. C. Shackelford**