



Western Michigan University
ScholarWorks at WMU

Legacy Scout Tickets from Pure Oil Company

8-20-2021

MGRRE_PureOilScoutTickets_Wendt, Fred_1_21017087130000

MGRRE

Western Michigan University

Follow this and additional works at: <https://scholarworks.wmich.edu/pure>



Part of the Geology Commons

WMU ScholarWorks Citation

MGRRE, "MGRRE_PureOilScoutTickets_Wendt, Fred_1_21017087130000" (2021). *Legacy Scout Tickets from Pure Oil Company*. 723.

<https://scholarworks.wmich.edu/pure/723>

This Document is brought to you for free and open access via ScholarWorks at WMU. It has been accepted for inclusion in Legacy Scout Tickets from Pure Oil Company by an authorized administrator of ScholarWorks at WMU. See the National Digital Catalogue - Science Base Catalogue for more collections submitted by MGRRE.



MGRRE_PureOilScoutTickets_Wendt, Fred_1_21017087130000

API 21017087130000

Permit Number 8713

Lease Name Wendt, Fred

Well Number 1

County Bay

Township 15N

Range 04E

Section 34

2021 DEQ or Pure co_name Muskegon Development Company

Pure Number 65

Latitude 43.6557955

Longitude -83.988178

THE PURE OIL COMPANY

LOCATION REPORT

DATE June 25, 1941

No. 65

COMPLETION RECORD OF WELLS DRILLED BY OTHER OPERATORS

STATE Michigan COUNTY Bay TWP. Kawkawlin SEC. 34 TOWN 15 N RANGE 4 E
 WELL No. 1 (SERIAL No. 65) FARM Fred Wendt ACRES

NAME OF STREAM OR WATERS _____ QUADRANGLE NW SW SW

OPERATOR Gulf Refining Company Map Kawkawlin Township, Bay County
330 330 Gulf Ref. Co Kawkawlin - Bay

330 330 Feet from North Line of Farm
 " " East " " "
 " " South " " "
330 330 " " West " " "
 Feet from North Line of Section
 " " East " " "
990 990 " " South " " 1/4
330 330 " " West " " "

- LEGEND**
- LOCATION
 - ⊕ RIG
 - ⊕ DRILLING
 - ☀ GAS WELL
 - OIL WELL
 - SMALL OIL WELL
 - ⊙ DRY HOLE
 - DRY SHOWING OIL
 - ⊙ DRY SHOWING GAS
 - ⊙ ABANDONED LOCATION
 - ☀ ABANDONED GAS WELL
 - ABANDONED OIL WELL

NOTE: Below make tracing from map, (when no map is obtainable make sketch) showing farm, center of section, this location with measurements and also wells, dry holes, or other locations in the vicinity of this location.

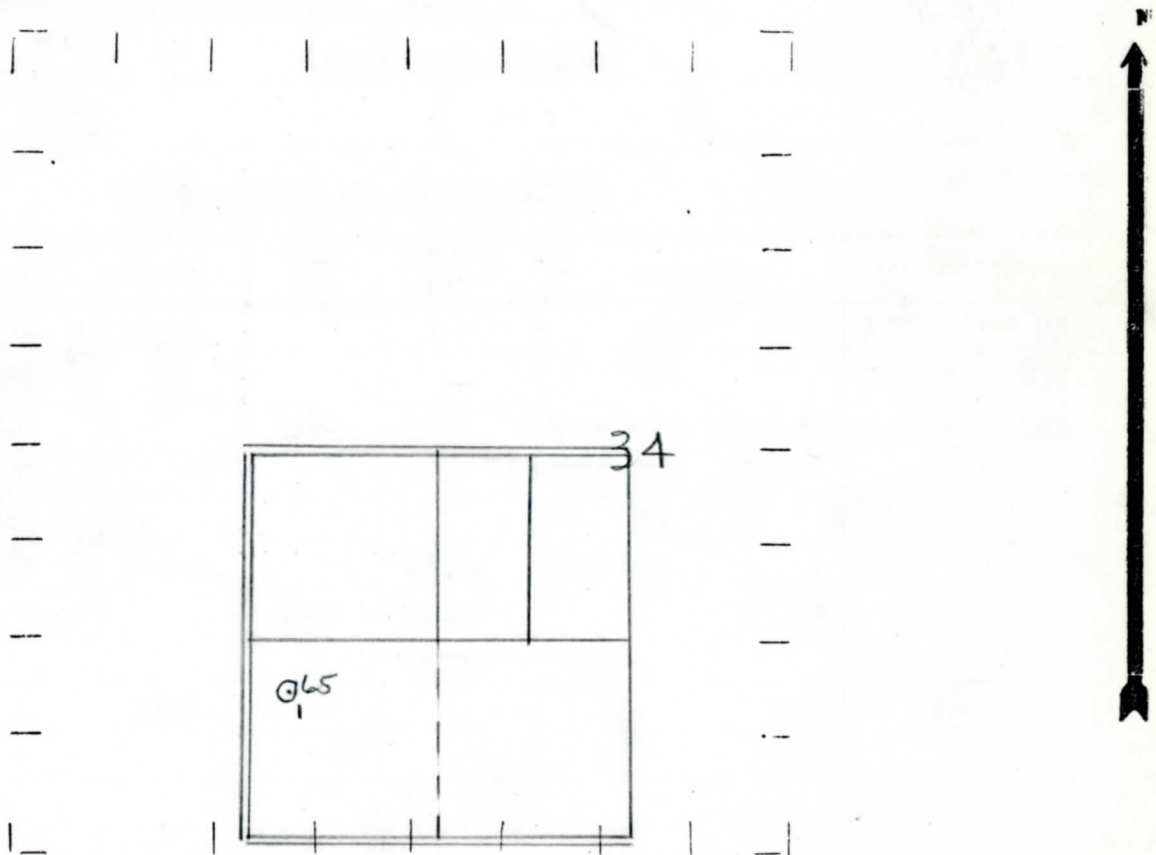

REMARKS:

SIGNED W
 Superintendent or Foreman.

OBEKVLOB WILL BEITUNG COMBINA No. 65
 NAME OF STATE OR PROVINCE Michigan No. 65
 DATE Aug 13 1941 (SERIAL NO. 65) No. 65
 STATE MICHIGAN No. 65 No. 65

Michigan Producing Division

Date August 13, 1941 No. 65
 State Mich. County Bay Twp. Kawkawlin Sec. 34 Twp. 15 N Rge. 4 E
 Well No. 1 (Serial No.) Farm Fred Wendt Acres _____
 (County No.) 65
 Operator Gulf Refining Company Information secured By Scouting Department
 Date well started 7-1-41 Date well completed 8-2-41 Elevation 601.9

PRODUCTION RECORD

¹⁴
 1st ~~24~~ hours natural 60 Barrels (Swabbed)
 2nd 24 hours natural _____
 Date of shot _____ No. of quarts _____ From _____ to _____ From _____ to _____
 Date of acid 8-4-41 No. of gallons 2000
 1st 24 hours after acid 125 Barrels (Pumped)
 shot
 2nd 24 hours after acid _____

FORMATION AND CASING RECORD

Formation	Top	Bottom	Top Pay	Bottom Pay	Remarks	Casing	
						Size	Set at
Coldw. Red Rock	1430	1442				10"	95
Sunbury	1539					8-1/4"	835
Berea	1565		1570	1575	Show salt water & show oil.	5-3/16"	2782
Antrim	1750						
Traverse Lime	2090						
Dundee	2778	S.L.M.		2845	Show oil.		
			2900	2920			
			?	2932			
Total Depth		2936					

Remarks 2771' C.T.M. equals 2782 1/2' S.L.M.

Signed D. C. Shackelford