



Western Michigan University
ScholarWorks at WMU

Legacy Scout Tickets from Pure Oil Company

8-20-2021

MGRRE_PureOilScoutTickets_Francis & Swantek Comm_1_21017088400000

MGRRE

Western Michigan University

Follow this and additional works at: <https://scholarworks.wmich.edu/pure>



Part of the Geology Commons

WMU ScholarWorks Citation

MGRRE, "MGRRE_PureOilScoutTickets_Francis & Swantek Comm_1_21017088400000" (2021). *Legacy Scout Tickets from Pure Oil Company*. 727.
<https://scholarworks.wmich.edu/pure/727>

This Document is brought to you for free and open access via ScholarWorks at WMU. It has been accepted for inclusion in Legacy Scout Tickets from Pure Oil Company by an authorized administrator of ScholarWorks at WMU. See the National Digital Catalogue - Science Base Catalogue for more collections submitted by MGRRE.



MGRRE_PureOilScoutTickets_Francis & Swantek Comm_1_21017088400000

API 21017088400000

Permit Number 8840

Lease Name Francis & Swantek Comm

Well Number 1

County Bay

Township 14N

Range 04E

Section 2

2021 DEQ or Pure co_name Yost Energy, Incorporated

Pure Number 69

Latitude 43.6512488

Longitude -83.951973

THE PURE OIL COMPANY

69

DATE August 13, 1941

LOCATION REPORT

No.

COMPLETION RECORD OF WELLS BY OTHER OPERATORS

STATE Michigan COUNTY Bay TWP Monitor SEC 2 TOWN 14 N RANGE 4 E
WELL No. 1 (SERIAL No. 689) FARM Francis-Swantek Community ACRES

NAME OF STREAM OR WATERS QUADRANGLE E 1/2 NE NE

OPERATOR Basin Oil Company Map Monitor Township, Bay County

580 580 Basin Oil Co. Feet from North Line of Farm

400 400 " " East " " "

" " South " " "

" " West " " "

660 660 1/4 sec Feet from North Line of Section

400 400 " " East " " "

" " South " " "

" " West " " "

Rig

LEGEND

- LOCATION
- ⊙ RIG
- ⊕ DRILLING
- ☀ GAS WELL
- OIL WELL
- ⬮ SMALL OIL WELL
- ⊙ DRY HOLE
- ◆ DRY SHOWING OIL
- ⊙ DRY SHOWING GAS
- ⊙ ABANDONED LOCATION
- ☀ ABANDONED GAS WELL
- ⬮ ABANDONED OIL WELL

NOTE: Below make tracing from map, (when no map is obtainable make sketch) showing farm, center of section, this location with measurements and also wells, dry holes, or other locations in the vicinity of this location.

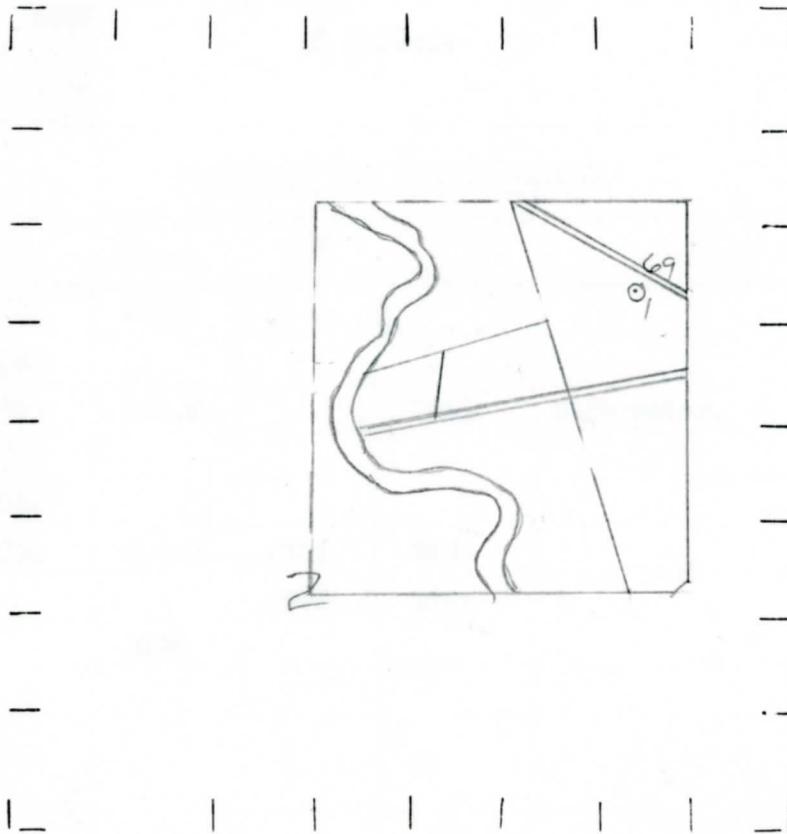

REMARKS:

SIGNED

W

Superintendent or Foreman.

