



Western Michigan University
ScholarWorks at WMU

Legacy Scout Tickets from Pure Oil Company

8-20-2021

MGRRE_PureOilScoutTickets_G. Staudacher_4_na

MGRRE

Western Michigan University

Follow this and additional works at: <https://scholarworks.wmich.edu/pure>



Part of the Geology Commons

WMU ScholarWorks Citation

MGRRE, "MGRRE_PureOilScoutTickets_G. Staudacher_4_na" (2021). *Legacy Scout Tickets from Pure Oil Company*. 741.

<https://scholarworks.wmich.edu/pure/741>

This Document is brought to you for free and open access via ScholarWorks at WMU. It has been accepted for inclusion in Legacy Scout Tickets from Pure Oil Company by an authorized administrator of ScholarWorks at WMU. See the National Digital Catalogue - Science Base Catalogue for more collections submitted by MGRRE.



MGRRE_PureOilScoutTickets_G. Staudacher_4_na

API na

Permit Number na

Lease Name G. Staudacher

Well Number 4

County Bay

Township 14N

Range 04E

Section 2

2021 DEQ or Pure co_name L C MacGregor

Pure Number 83

Latitude 43.6458429

Longitude -83.9606645

DATE October 22, 1941

LOCATION REPORT

No. 83

STATE Michigan COUNTY Bay DIST. Monitor TWP. Monitor SEC. 2 TOWN 14-N RANGE 4-E
WELL No. 44 (SERIAL No. 83) FARM G. Staudacher ACRES

NAME OF STREAM OR WATERS _____ QUADRANGLE SW-SW-NW

OPERATOR L. C. MacGregor Map Monitor Township, Bay County

Feet from North Line of Farm

1200 1200 " " East " " "

330 330 " " South " " "

330 330 " " West " " "

Feet from North Line of Section

50 50 " " East " " "

600 600 " " South " " "

600 600 " " West " " "

LEGEND

- LOCATION
- ⊕ RIG
- ⊕ DRILLING
- ☀ GAS WELL
- OIL WELL
- ◆ SMALL OIL WELL
- ⊙ DRY HOLE
- ◆ DRY SHOWING OIL
- ☀ DRY SHOWING GAS
- ⊙ ABANDONED LOCATION
- ☀ ABANDONED GAS WELL
- ◆ ABANDONED OIL WELL

NOTE: Below make tracing from map. (when no map is obtainable make sketch) showing farm, center of section, this location with measurements and also wells, dry holes, or other locations in the vicinity of this location.

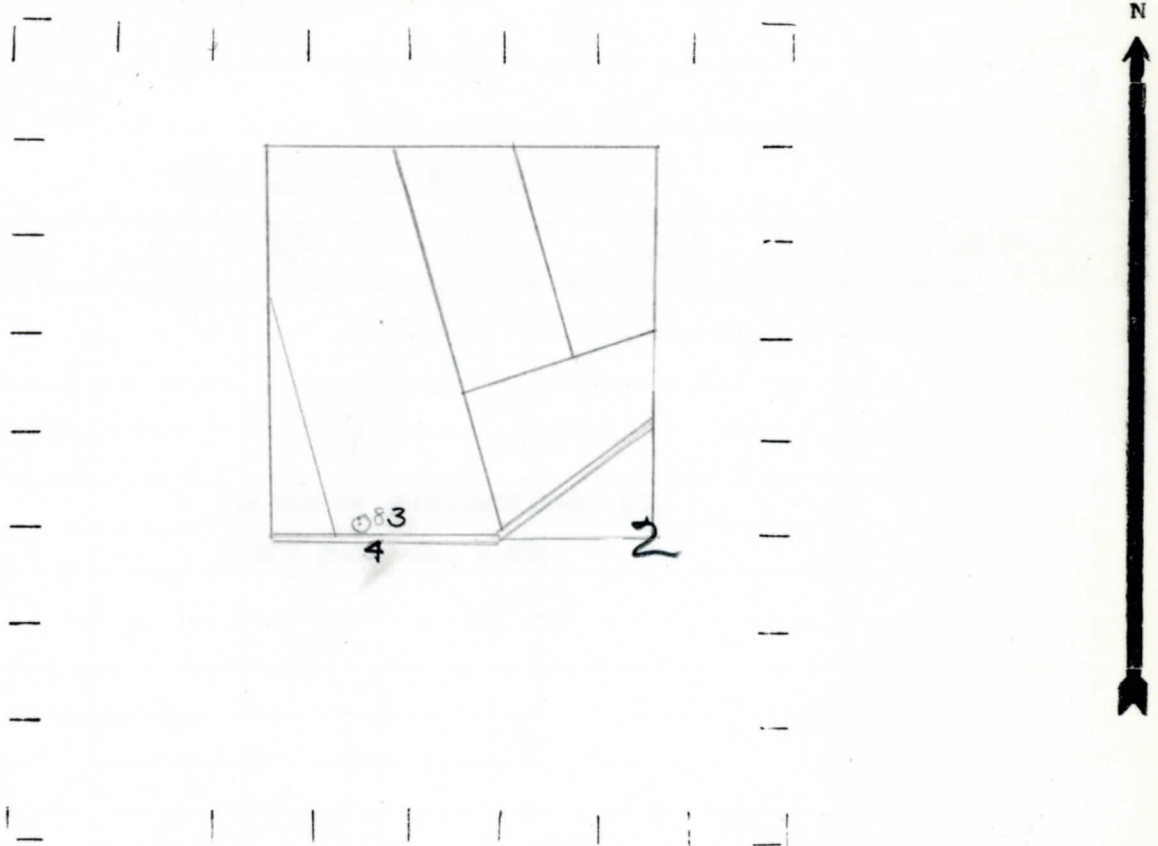

REMARKS:

SIGNED

Superintendent or Foreman.

[Handwritten signature]

Date **April 29, 1942** No. **83**
 State **Mich.** County **Bay** Twp. **Monitor** Sec. **2** Twp. **14 N** Rge. **4 E**
 Well No. **4** (Serial No.) **83** Farm **G. Staudacher** Acres
 Operator **L. C. MacGregor** Information secured ~~from~~ **By Scouting Department**
 Date well started **Not started.** Date well completed **Not completed.** Elevation

PRODUCTION RECORD

1st 24 hours natural **Location abandoned.**
 2nd 24 hours natural
 Date of shot No. of quarts From to From to
 Date of acid No. of gallons
 1st 24 hours after acid shot
 2nd 24 hours after acid shot

FORMATION AND CASING RECORD

Formation	Top	Bottom	Top Pay	Bottom Pay	Remarks	Casing	
						Size	Set at
					Location abandoned 4-27-42.		
					(OPC Order No. M-68).		

Remarks

Signed **D. C. Shackelford**