



Western Michigan University
ScholarWorks at WMU

Legacy Scout Tickets from Pure Oil Company

8-20-2021

MGRRE_PureOilScoutTickets_G. Staudacher_5_na

MGRRE

Western Michigan University

Follow this and additional works at: <https://scholarworks.wmich.edu/pure>



Part of the Geology Commons

WMU ScholarWorks Citation

MGRRE, "MGRRE_PureOilScoutTickets_G. Staudacher_5_na" (2021). *Legacy Scout Tickets from Pure Oil Company*. 742.

<https://scholarworks.wmich.edu/pure/742>

This Document is brought to you for free and open access via ScholarWorks at WMU. It has been accepted for inclusion in Legacy Scout Tickets from Pure Oil Company by an authorized administrator of ScholarWorks at WMU. See the National Digital Catalogue - Science Base Catalogue for more collections submitted by MGRRE.



MGRRE_PureOilScoutTickets_G. Staudacher_5_na

API na

Permit Number na

Lease Name G. Staudacher

Well Number 5

County Bay

Township 14N

Range 04E

Section 2

2021 DEQ or Pure co_name L C MacGregor

Pure Number 84

Latitude 43.6458429

Longitude -83.9606645

DATE October 22, 1941

LOCATION REPORT OTHER OPERATORS

No. 84

STATE Michigan COUNTY Bay DIST. Monitor TWP. Monitor SEC. 2 TOWN 14-N RANGE 4-E
WELL No. 55 (SERIAL No. 84) FARM G. Staudacher ACRES

NAME OF STREAM OR WATERS _____ QUADRANGLE SE-SE-SW-NW

OPERATOR L. C. MacGregor Map Monitor Township, Bay County

L. C. MacGregor

Monitor - Bay

Feet from North Line of Farm

394 394 " " East " " "
1320 1320 " " South " " "
" " West " " "

Feet from North Line of Section

" " East " " "
200 200 " " South " 1/4 "
1225 1225 " " West " " "

LEGEND

- LOCATION
- ⊕ RIG
- ⊕ DRILLING
- ☀ GAS WELL
- OIL WELL
- ⬮ SMALL OIL WELL
- ⊙ DRY HOLE
- ◆ DRY SHOWING OIL
- ⊙ DRY SHOWING GAS
- ⊙ ABANDONED LOCATION
- ☀ ABANDONED GAS WELL
- ⬮ ABANDONED OIL WELL

NOTE: Below make tracing from map. (when no map is obtainable make sketch) showing farm, center of section, this location with measurements and also wells, dry holes, or other locations in the vicinity of this location.

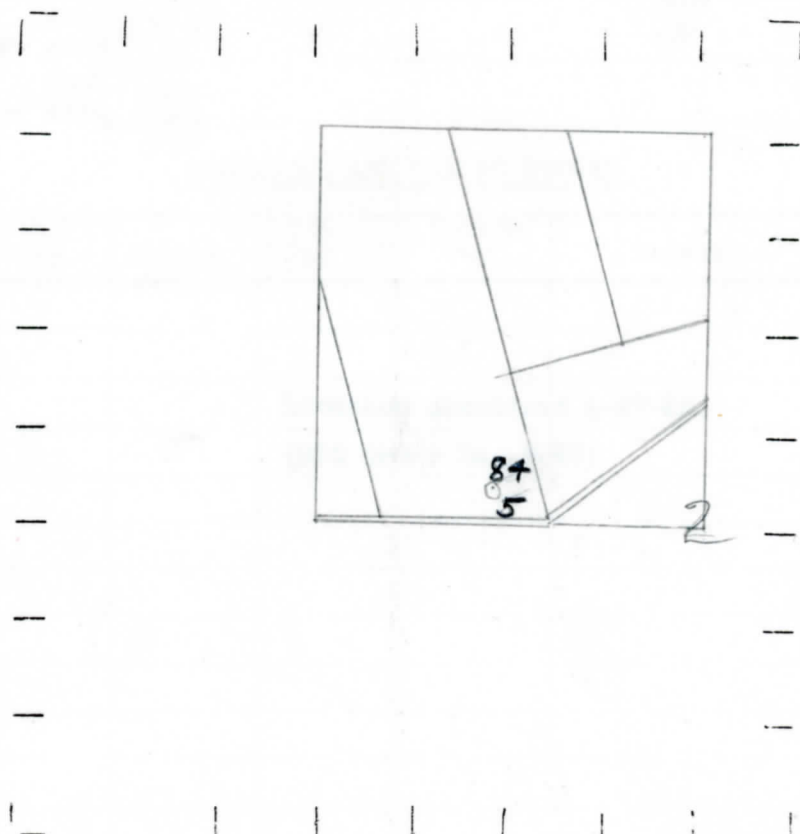

REMARKS:

SIGNED

W
Superintendent or Foreman.

G

