



Western Michigan University  
ScholarWorks at WMU

---

Legacy Scout Tickets from Pure Oil Company

---

8-20-2021

**MGRRE\_PureOilScoutTickets\_Schweitzer,  
Wm\_2\_21017097310000**

MGRRE  
*Western Michigan University*

Follow this and additional works at: <https://scholarworks.wmich.edu/pure>



Part of the Geology Commons

---

#### **WMU ScholarWorks Citation**

MGRRE, "MGRRE\_PureOilScoutTickets\_Schweitzer, Wm\_2\_21017097310000" (2021). *Legacy Scout Tickets from Pure Oil Company*. 774.  
<https://scholarworks.wmich.edu/pure/774>

This Document is brought to you for free and open access via ScholarWorks at WMU. It has been accepted for inclusion in Legacy Scout Tickets from Pure Oil Company by an authorized administrator of ScholarWorks at WMU. See the National Digital Catalogue - Science Base Catalogue for more collections submitted by MGRRE.



---

**MGRRE\_PureOilScoutTickets\_Schweitzer, Wm\_2\_21017097310000**

API 21017097310000

Permit Number 9731

Lease Name Schweitzer, Wm

Well Number 2

County Bay

Township 14N

Range 04E

Section 12

2021 DEQ or Pure co\_name Muskegon Development Company

Pure Number 116

Latitude 43.6357866

Longitude -83.9437888

COMPLETION RECORD THE PURE OIL COMPANY OTHER OPERATORS

Date August 12, 1942 LOCATION REPORT A.F.E. No.

Division Michigan Producing District Lease Wm. Schweitzer

Acres Lease No. Elevation Well No. 2 (Serial No. 116)

Quadrangle C S 2 NE NW Sec. 12 Twp. 14 N Rge. 4 E Twp. Monitor

Survey County Bay State Michigan

Operator Gulf Refining Company Map Monitor Township, Bay County

660	660	Feet from North Line of Lease
330	330	" " East " " "
660	660	" " South " " "
990	990	" " West 1/4 " "
660	660	Feet from North Line of Section
		" " East " " "
		" " South " " "
		" " West " " "

Rev

LEGEND

- Location
- ☉ Gas Well
- Oil Well
- ☉ Gas - Distillate Well
- ∅ or ○ Dry Hole
- or ○ Dry Showing Oil
- ☉ Dry Showing Gas
- ⊗ Abandoned Location
- ☉ or ☉ Abandoned Gas Well
- or ● Abandoned Oil Well
- or ○ Input Well

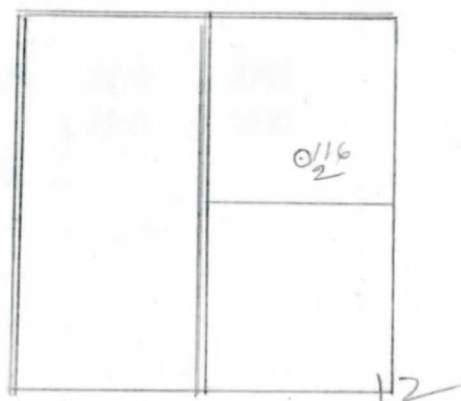

Scale \_\_\_\_\_

Remarks: \_\_\_\_\_

Submitted by \_\_\_\_\_ Civil Engineer Approved by \_\_\_\_\_ Division Manager

Approved by \_\_\_\_\_ Vice-President - General Manager

Michigan Producing Division

Date September 16, 1942 No. 116  
 State Mich. County Bay ~~xxxx~~ Twp. Monitor Sec. 12 Twp. 14 N Rge. 4 E  
 Well No. 2 (Serial No.) ~~xxxxxxx~~ 116 Farm Wm. Schweitzer Acres \_\_\_\_\_  
 Operator Gulf Refining Company Information secured ~~from~~ By Scouting Department  
 Date well started 8-11-42 Date well completed 8-28-42 Elevation 588.7

PRODUCTION RECORD

1st 24 hours natural ??  
 2nd 24 hours natural \_\_\_\_\_  
 Date of shot 9-3-42 and No. of quarts \_\_\_\_\_ From \_\_\_\_\_ to \_\_\_\_\_  
 Date of acid 9-10-42 No. of gallons 2500  
 1st 24 hours after acid ~~shot~~ 20 Barrels (Pumped)  
 2nd 24 hours after acid shot

FORMATION AND CASING RECORD

Formation	Top	Bottom	Top Pay	Bottom Pay	Remarks	Casing	
						Size	Set at
Sunbury	1490					10"	124
Berea	1510					5-3/16"	2718
Traverse Lime	2032						
Dundee	2712	S.I.M.	2770	2792			
			2799	2850			
Total Depth		2858½					

Remarks \_\_\_\_\_  
 \_\_\_\_\_  
 \_\_\_\_\_  
 \_\_\_\_\_

Signed D. C. Shackelford