



Western Michigan University  
ScholarWorks at WMU

---

Legacy Scout Tickets from Pure Oil Company

---

8-20-2021

**MGRRE\_PureOilScoutTickets\_Friebe-Knockel\_1\_21017097530000**

MGRRE

*Western Michigan University*

Follow this and additional works at: <https://scholarworks.wmich.edu/pure>



Part of the Geology Commons

---

#### WMU ScholarWorks Citation

MGRRE, "MGRRE\_PureOilScoutTickets\_Friebe-Knockel\_1\_21017097530000" (2021). *Legacy Scout Tickets from Pure Oil Company*. 777.

<https://scholarworks.wmich.edu/pure/777>

This Document is brought to you for free and open access via ScholarWorks at WMU. It has been accepted for inclusion in Legacy Scout Tickets from Pure Oil Company by an authorized administrator of ScholarWorks at WMU. See the National Digital Catalogue - Science Base Catalogue for more collections submitted by MGRRE.



---

**MGRRE\_PureOilScoutTickets\_Friebe-Knockel\_1\_21017097530000**

API 21017097530000

Permit Number 9753

Lease Name Friebe-Knockel

Well Number 1

County Bay

Township 15N

Range 04E

Section 35

2021 DEQ or Pure co\_name Muskegon Development Company

Pure Number 119

Latitude 43.6664577

Longitude -83.9670713

THE PURE OIL COMPANY

LOCATION REPORT

A.F.E. No. \_\_\_\_\_

Date August 26, 1942

Division Michigan Producing District \_\_\_\_\_ Lease Friebe-Knockel

Acres \_\_\_\_\_ Lease No. \_\_\_\_\_ Elevation \_\_\_\_\_ Well No. 1 (Serial No. 119)

Quadrangle C-1/2 NW NW Sec. 355 Twp. 15 N Rge. 4 E Twp. Kawkawlin

Survey \_\_\_\_\_ County Bay State Michigan

Operator Gulf Refining Company Map Kawkawlin Township, Bay County

330	330	Feet from North Line of Lease
660	660	" " East " " "
		" " South " " "
660	660	" " West " " "
330	330	Feet from North Line of Section
		" " East " " "
		" " South " " "
660	660	" " West " " "

*Loo*

LEGEND

- Location
- ☀ Gas Well
- Oil Well
- ☀ Gas - Distillate Well
- ∅ or ○ Dry Hole
- Dry Showing Oil
- ☀ Dry Showing Gas
- ⊖ Abandoned Location
- ☀ or ⊖ Abandoned Gas Well
- or ● Abandoned Oil Well
- or ○ Input Well

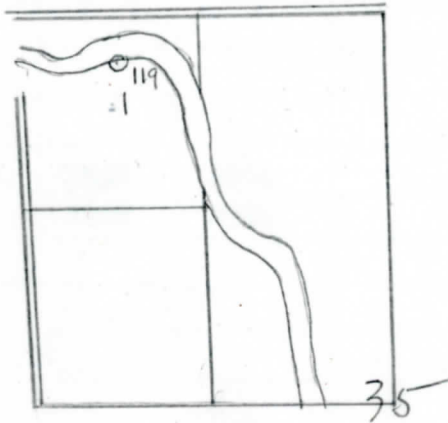

Scale \_\_\_\_\_

Remarks: \_\_\_\_\_

Submitted by \_\_\_\_\_ Civil Engineer

Approved by \_\_\_\_\_ Division Manager

Approved by \_\_\_\_\_ Vice-President - General Manager

Michigan Producing Division

Date October 7, 1942 No. 119  
 State Mich. County Bay Twp. Kawkawlin Sec. 35 Twp. 15 N Rge. 4 E  
 Well No. 1 (Serial No.) 119 Farm Friebe-Knockel Acres \_\_\_\_\_  
 Operator Gulf Refining Company Information secured By Scouting Department  
 Date well started 8-30-42 Date well completed 9-12-42 Elevation 593.3

PRODUCTION RECORD

1st 24 hours natural ??  
 2nd 24 hours natural \_\_\_\_\_  
 Date of shot 9-23-42 and 9-28-42 No. of quarts \_\_\_\_\_ From \_\_\_\_\_ to \_\_\_\_\_  
 Date of acid 9-28-42 No. of gallons 2126  
 1st 24 hours after acid 65 Barrels (Pumped)  
 shot  
 2nd 24 hours after acid \_\_\_\_\_

FORMATION AND CASING RECORD

Formation	Top	Bottom	Top Pay	Bottom Pay	Remarks	Casing	
						Size	Set at
Sunbury	1531					10"	109
Berea	1557					6-5/8"	2796
Traverse Lime	2086						
Dundee	2777	S.L.M.	2838	2861			
			2868	2924			
Total Depth		2932					

Remarks Cored from 2777' to 2932'.

Signed D. C. Shackelford