



Western Michigan University  
ScholarWorks at WMU

---

Legacy Scout Tickets from Pure Oil Company

---

8-20-2021

**MGRRE\_PureOilScoutTickets\_Fontaine\_1\_21017098560000**

MGRRE

*Western Michigan University*

Follow this and additional works at: <https://scholarworks.wmich.edu/pure>



Part of the Geology Commons

---

#### **WMU ScholarWorks Citation**

MGRRE, "MGRRE\_PureOilScoutTickets\_Fontaine\_1\_21017098560000" (2021). *Legacy Scout Tickets from Pure Oil Company*. 785.

<https://scholarworks.wmich.edu/pure/785>

This Document is brought to you for free and open access via ScholarWorks at WMU. It has been accepted for inclusion in Legacy Scout Tickets from Pure Oil Company by an authorized administrator of ScholarWorks at WMU. See the National Digital Catalogue - Science Base Catalogue for more collections submitted by MGRRE.



---

**MGRRE\_PureOilScoutTickets\_Fontaine\_1\_21017098560000**

API 21017098560000

Permit Number 9856

Lease Name Fontaine

Well Number 1

County Bay

Township 15N

Range 04E

Section 33

2021 DEQ or Pure co\_name Muskegon Development Company

Pure Number 127

Latitude 43.6629251

Longitude -83.9966065

THE PURE OIL COMPANY

LOCATION REPORT

Date 11-4-42 A.F.E. No. \_\_\_\_\_

Division Mich. Producing District \_\_\_\_\_ Lease Fontaine

Acres \_\_\_\_\_ Lease No. \_\_\_\_\_ Elevation \_\_\_\_\_ Well No. 1 (Serial No. 127)

Quadrangle C NE SW NE Sec. 33 Twp. 15 N Rge. 4 E ~~YBCK~~ ~~XDSTX~~ Kawkawlin

Survey \_\_\_\_\_ County Bay State Michigan

Operator Gulf Refining Co. Map Kawkawlin Twp - Bay Co

<u>330'</u>	<u>330</u>	Feet from North Line of Lease
<u>660'</u>	<u>660</u>	" " East " " "
		" " South " " "
<u>660'</u>	<u>660</u>	" " West " " "
		Feet from North Line of Section
<u>990'</u>	<u>990</u>	" " East " " "
<u>660'</u>	<u>660</u>	" " South " <u>1/4</u> "
		" " West " " "

*Low*

LEGEND

- Location
- ☀ Gas Well
- Oil Well
- ☀ Gas - Distillate Well
- ∅ or ○ Dry Hole
- Dry Showing Oil
- ☀ Dry Showing Gas
- ⊗ Abandoned Location
- ☀ or ☀ Abandoned Gas Well
- or ● Abandoned Oil Well
- or ○ Input Well

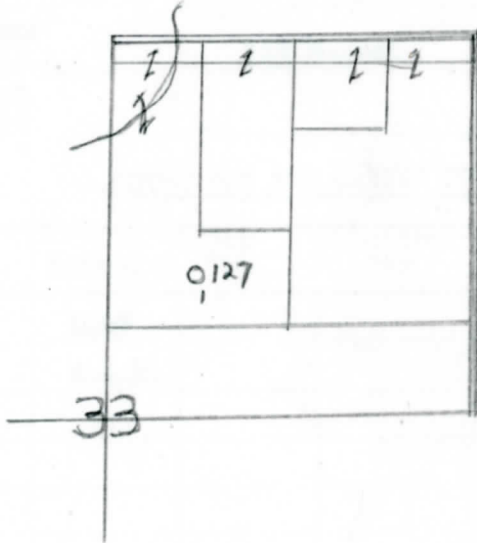

Scale \_\_\_\_\_

Remarks: \_\_\_\_\_

Submitted by N. Civil Engineer Approved by \_\_\_\_\_ Division Manager

Approved by \_\_\_\_\_ Vice-President - General Manager

Michigan Producing Division

Date 12-30-42 No. 127  
 State Mich. County Bay ~~State~~ Twp. Kawkawlin Sec. 33 Twp. 15 N Rge. 4 E  
 Well No. 1 (Serial No.) ~~(County No.)~~ 127 Farm Fontaine Acres \_\_\_\_\_  
 Operator Gulf Refining Company Information secured ~~from~~ Scouting Department  
 Date well started 11-16-42 Date well completed 12-18-42 Elevation 604.0

PRODUCTION RECORD

1st 24 hours natural Filled up 2000 ft.  
 2nd 24 hours natural \_\_\_\_\_  
 Date of shot \_\_\_\_\_ No. of quarts \_\_\_\_\_ From \_\_\_\_\_ to \_\_\_\_\_ From \_\_\_\_\_ to \_\_\_\_\_  
 Date of acid 12-26-42 No. of gallons 500  
11 ~~24~~ hours after ~~acid~~ shot 125 Barrels  
 2nd 24 hours after acid \_\_\_\_\_

FORMATION AND CASING RECORD

Formation	Top	Bottom	Top Pay	Bottom Pay	Remarks	Casing	
						Size	Set at
Coldw. Red Rock	1465	1467				10"	111
Sunbury	1582	S.L.M.				8-1/4"	788
Berea	1612				Water 1672-1682.	6-5/8"	2807
Antrim	1780						
Traverse Lime	2115						
Dundee	2795	S.L.M.	2870	2895			
			2900	2943			
Total Depth		2943					

Remarks 2368' CTM equals 2280' SOM.

Signed D. C. Shackelford