



Western Michigan University
ScholarWorks at WMU

Legacy Scout Tickets from Pure Oil Company

8-20-2021

MGRRE_PureOilScoutTickets_Philip, Anna_1_21017098780000

MGRRE

Western Michigan University

Follow this and additional works at: <https://scholarworks.wmich.edu/pure>



Part of the Geology Commons

WMU ScholarWorks Citation

MGRRE, "MGRRE_PureOilScoutTickets_Philip, Anna_1_21017098780000" (2021). *Legacy Scout Tickets from Pure Oil Company*. 786.

<https://scholarworks.wmich.edu/pure/786>

This Document is brought to you for free and open access via ScholarWorks at WMU. It has been accepted for inclusion in Legacy Scout Tickets from Pure Oil Company by an authorized administrator of ScholarWorks at WMU. See the National Digital Catalogue - Science Base Catalogue for more collections submitted by MGRRE.



MGRRE_PureOilScoutTickets_Philip, Anna_1_21017098780000

API 21017098780000

Permit Number 9878

Lease Name Philip, Anna

Well Number 1

County Bay

Township 15N

Range 04E

Section 34

2021 DEQ or Pure co_name Muskegon Development Company

Pure Number 128

Latitude 43.6646951

Longitude -83.9820446

THE PURE OIL COMPANY

LOCATION REPORT

Date 11-18-42 A.F.E. No. _____
 Division Mich. Producing District _____ Lease Anna Philip
 Anna Philip
 Acres _____ Lease No. _____ Elevation _____ Well No. 1 (Serial No. 128)
 Quadrangle C S₁/₂ NE NW Sec. 34 Twp. 15 N Rge. 4 E Twp. Kawkawlin
 Survey _____ County Bay State Michigan
 Operator Gulf Refining Co Map Kawkawlin Twp - Bay Co.
 Gulf Refining Company

Feet from North Line of Lease					
<u>660'</u>	<u>660</u>	"	"	East	" " "
<u>330'</u>	<u>330</u>	"	"	South	" " "
<u>660'</u>	<u>660</u>	"	"	West	" " "
Feet from North Line of Section					
<u>990'</u>	<u>990</u>	"	"	East	" " " <u>1/4</u>
<u>660'</u>	<u>660</u>	"	"	South	" " "
		"	"	West	" " "

Low

LEGEND

- Location
- ☀ Gas Well
- Oil Well
- ☀ Gas - Distillate Well
- or ○ Dry Hole
- Dry Showing Oil
- ☀ Dry Showing Gas
- ⊗ Abandoned Location
- ☀ or ☀ Abandoned Gas Well
- or ● Abandoned Oil Well
- ⊗ or ⊗ Input Well

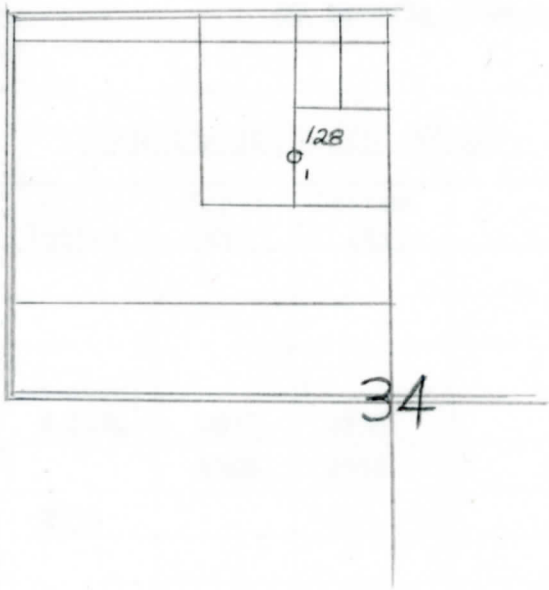

Remarks: _____

Scale _____

Submitted by N Civil Engineer Approved by _____ Division Manager
 Approved by _____ Vice-President - General Manager

COMPLETION RECORD OF WELLS DRILLED BY OTHER OPERATORS

Michigan Producing Division

Date 1-13-43 No. 128
 State Mich. County Bay ~~Sixty~~ Twp. Kawkawlin Sec. 34 Twp. 15 N Rge. 4 E
 Well No. 1 (~~County No.~~) 128 Farm Anna Philip Acres _____
 Operator Gulf Refining Company Information secured ~~from~~ Scouting Department
 Date well started 11-22-42 Date well completed 12-28-42 Elevation 602.3

PRODUCTION RECORD

1st 24 hours natural _____ Filled up 1500 ft.
 2nd 24 hours natural _____
 Date of shot _____ No. of quarts _____ From _____ to _____ From _____ to _____
 Date of acid 1-7-43 No. of gallons 500
12 ~~shots~~ shot
 1st ~~24~~ hours after acid _____ 39 Barrels (Pumped)
 2nd 24 hours after acid _____

FORMATION AND CASING RECORD

Formation	Top	Bottom	Top Pay	Bottom Pay	Remarks	Casing	
						Size	Set at
Sunbury	1525					10"	86
Berea	1545					8-1/4"	796
Traverse Lime	2095					6-5/8"	2790
Dundee	2777	S.L.M.	2837	2858			
			2868	2936			
Total Depth		2936					

Remarks _____

Signed D. C. Shackelford