



Western Michigan University
ScholarWorks at WMU

Legacy Scout Tickets from Pure Oil Company

8-20-2021

MGRRE_PureOilScoutTickets_Wildgan, Wm_1_21017100350000

MGRRE

Western Michigan University

Follow this and additional works at: <https://scholarworks.wmich.edu/pure>



Part of the Geology Commons

WMU ScholarWorks Citation

MGRRE, "MGRRE_PureOilScoutTickets_Wildgan, Wm_1_21017100350000" (2021). *Legacy Scout Tickets from Pure Oil Company*. 801.

<https://scholarworks.wmich.edu/pure/801>

This Document is brought to you for free and open access via ScholarWorks at WMU. It has been accepted for inclusion in Legacy Scout Tickets from Pure Oil Company by an authorized administrator of ScholarWorks at WMU. See the National Digital Catalogue - Science Base Catalogue for more collections submitted by MGRRE.



MGRRE_PureOilScoutTickets_Wildgan, Wm_1_21017100350000

API 21017100350000

Permit Number 10035

Lease Name Wildgan, Wm

Well Number 1

County Bay

Township 14N

Range 04E

Section 12

2021 DEQ or Pure co_name Muskegon Development Company

Pure Number 143

Latitude 43.6321828

Longitude -83.9438871

THE PURE OIL COMPANY LOCATION REPORT

Date March 31, 1943 A.F.E. No. _____
 Division Mich. Producing District _____ Lease William Wildgan
 Acres _____ Lease No. _____ Elevation _____ Well No. 1 (Serial No. 143)
 Quadrangle C S¹/₂ SE NW Sec. 12 Twp. 14 N Rge. 4 E Twp. Monitor
 Survey _____ County Bay State Michigan
 Operator Gulf Refining Company Map Monitor Twp - Bay Co

		Feet from North Line of Lease			
<u>660</u>	<u>660</u>	"	"	East	" " "
<u>330</u>	<u>330</u>	"	"	South	" " "
<u>660</u>	<u>660</u>	"	"	West	" " "
		Feet from North Line of Section			
<u>660</u>	<u>660</u>	"	"	East	" <u>1/4</u> "
<u>330</u>	<u>330</u>	"	"	South	" " "
		"	"	West	" " "

PN

- LEGEND**
- Location
 - ☉ Gas Well
 - Oil Well
 - ☼ Gas - Distillate Well
 - or ○ Dry Hole
 - Dry Showing Oil
 - ☉ or ☉ Dry Showing Gas
 - ⊗ Abandoned Location
 - ☼ or ☼ Abandoned Gas Well
 - or ● Abandoned Oil Well
 - or ○ Input Well

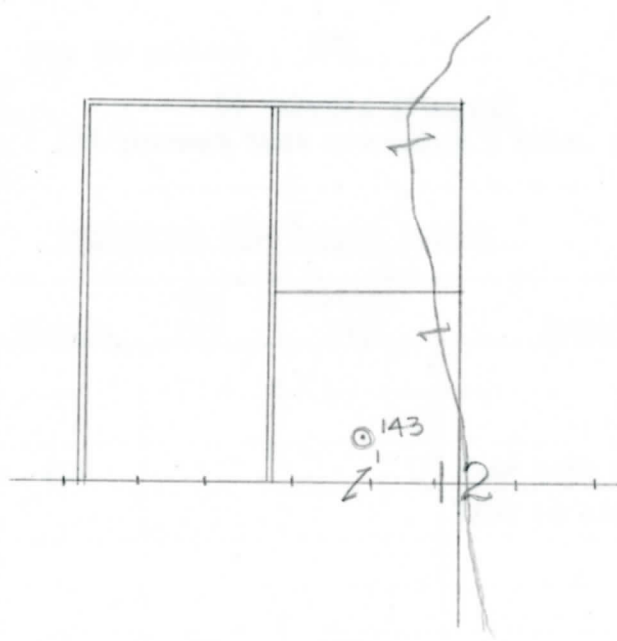

Scale _____

Remarks: _____

Submitted by PN Civil Engineer Approved by _____ Division Manager
 Approved by _____ Vice-President - General Manager

Division Michigan
Date July 21, 1943

LOCATION REPORT
THE PURE OIL COMPANY

Well No. 143
V.E. No.

COMPLETION RECORD OF WELLS DRILLED BY OTHER OPERATORS

Michigan Producing Division

Date July 21, 1943 No. 143
 State Mich. County Bay ~~Dixie~~ Twp. Monitor Sec. 12 Twp. 14 N Rge. 4 E
 Well No. 1 (Serial No.) 143 (County No.) Farm Wm. Wildgan Acres _____
 Operator Gulf Refining Company Information secured ~~from~~ Scouting Department By _____
 Date well started 4-20-43 Date well completed 5-26-43 Elevation 592.5

PRODUCTION RECORD

1st 24 hours natural Filled up 100 ft.
 2nd 24 hours natural _____
 Date of shot _____ No. of quarts _____ From _____ to _____ From _____ to _____
 Date of acid 7-12-43 No. of gallons 500
 1st 24 hours after acid ~~shot~~ 36 Barrels (Pumped)
 shot (At present time averaging 7 bbls. per day.)
 2nd 24 hours after acid _____

FORMATION AND CASING RECORD

Formation	Top	Bottom	Top Pay	Bottom Pay	Remarks	Casing	
						Size	Set at
Coldw. Red Rock	1400					10"	117
Sunbury	1536					8-1/4"	765
Berea	1556	SLM			Show salt water 1590 to 1610.	6-5/8"	2764
Antrim	1730						
Traverse Lime	2072						
Dundee	2740	SLM	2814	2840			
			2846	2905			
Total Depth		2905					

Remarks _____

Signed D. C. Shackelford