



Western Michigan University
ScholarWorks at WMU

Legacy Scout Tickets from Pure Oil Company

8-20-2021

MGRRE_PureOilScoutTickets_Fischer_1_21017100850000

MGRRE

Western Michigan University

Follow this and additional works at: <https://scholarworks.wmich.edu/pure>



Part of the Geology Commons

WMU ScholarWorks Citation

MGRRE, "MGRRE_PureOilScoutTickets_Fischer_1_21017100850000" (2021). *Legacy Scout Tickets from Pure Oil Company*. 802.

<https://scholarworks.wmich.edu/pure/802>

This Document is brought to you for free and open access via ScholarWorks at WMU. It has been accepted for inclusion in Legacy Scout Tickets from Pure Oil Company by an authorized administrator of ScholarWorks at WMU. See the National Digital Catalogue - Science Base Catalogue for more collections submitted by MGRRE.



MGRRE_PureOilScoutTickets_Fischer_1_21017100850000

API 21017100850000

Permit Number 10085

Lease Name Fischer

Well Number 1

County Bay

Township 14N

Range 04E

Section 11

2021 DEQ or Pure co_name Muskegon Development Company

Pure Number 144

Latitude 43.6360644

Longitude -83.9637138

THE PURE OIL COMPANY LOCATION REPORT

Date May 5, 1943 A.F.E. No. _____
 Division Mich. Producing District _____ Lease Fischer
 Acres _____ Lease No. _____ Elevation _____ Well No. 1 (Serial No. 144)
 Quadrangle C S 1/2 NE - NW Sec. 11 Twp. 14 N Rge. 4 E Twp. Monitor
 Survey _____ County Bay State Michigan
 Operator Gulf Ref. Co. Map Monitor Township, Bay County

_____	_____	Feet from North Line of Lease
<u>660</u>	<u>660</u>	" " East " " "
<u>330</u>	<u>330</u>	" " South " " "
<u>660</u>	<u>660</u>	" " West <u>1/4</u> " " "
_____	_____	Feet from North Line of Section
<u>990</u>	<u>990</u>	" " East " " "
<u>660</u>	<u>660</u>	" " South " " "
_____	_____	" " West " " "

3. - m

LEGEND

- Location
- ☉ Gas Well
- Oil Well
- ☉ Gas - Distillate Well
- or ○ Dry Hole
- Dry Showing Oil
- ☉ Dry Showing Gas
- ⊗ Abandoned Location
- ☉ or ☉ Abandoned Gas Well
- or ● Abandoned Oil Well
- ⊗ or ⊗ Input Well

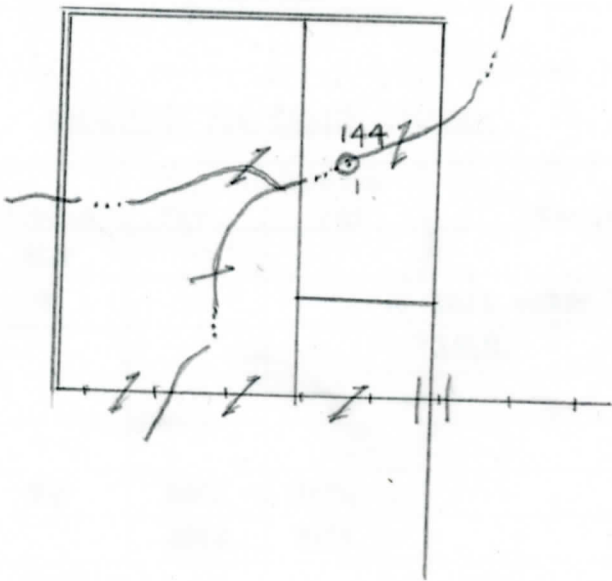

Scale _____

Remarks: _____

Submitted by PN Civil Engineer Approved by _____ Division Manager
 Approved by _____ Vice-President - General Manager

COMPLETION RECORD OF WELLS DRILLED BY OTHER OPERATORS

Michigan Producing Division

Date **July 21, 1943** No. **144**
 State **Mich.** County **Bay** Twp. **Monitor** Sec. **11** Twp. **14 N** Rge. **4 E**
 Well No. **1** (Serial No.) **144** Farm **Fischer** Acres _____
 Operator **Gulf Refining Company** Information secured ~~from~~ **Scouting Department**
 Date well started **5-11-43** Date well completed **6-8-43** Elevation **592.5**

PRODUCTION RECORD

Filled up 100 ft.
 1st 24 hours natural _____
 2nd 24 hours natural _____
 Date of shot _____ No. of quarts _____ From _____ to _____ From _____ to _____
 Date of acid **7-5-43** No. of gallons **1000**
~~5000~~
 1st 24 hours after acid **5 Barrels**
 shot
 2nd 24 hours after acid _____

FORMATION AND CASING RECORD

Formation	Top	Bottom	Top Pay	Bottom Pay	Remarks	Casing	
						Size	Set at
Sunbury	1582	SLM				10"	123
Berea	1602	"			Salt water 1627 to 1642.	8-1/4"	807
						6-5/8"	2815
Antrim	1785						
Traverse Lime	2122						
Dundee	2800	SLM	2864	2874			
			2892	2935			
Total Depth		2935					

Remarks **1637' CTM equals 1624' SLM; 2099' CTM equals 2099' SLM.**

Signed **D. C. Shackelford**