



Western Michigan University
ScholarWorks at WMU

Legacy Scout Tickets from Pure Oil Company

8-20-2021

MGRRE_PureOilScoutTickets_Jerry_1_21017114070000

MGRRE

Western Michigan University

Follow this and additional works at: <https://scholarworks.wmich.edu/pure>



Part of the Geology Commons

WMU ScholarWorks Citation

MGRRE, "MGRRE_PureOilScoutTickets_Jerry_1_21017114070000" (2021). *Legacy Scout Tickets from Pure Oil Company*. 873.

<https://scholarworks.wmich.edu/pure/873>

This Document is brought to you for free and open access via ScholarWorks at WMU. It has been accepted for inclusion in Legacy Scout Tickets from Pure Oil Company by an authorized administrator of ScholarWorks at WMU. See the National Digital Catalogue - Science Base Catalogue for more collections submitted by MGRRE.



MGRRE_PureOilScoutTickets_Jerry_1_21017114070000

API 21017114070000

Permit Number 11407

Lease Name Jerry

Well Number 1

County Bay

Township 14N

Range 06E

Section 16

2021 DEQ or Pure co_name Gulf Refining Company and EPD

Pure Number 215

Latitude 43.61881

Longitude -83.77109

WELL REPORT - OUTSIDE OPERATIONS

SERIAL NO. 215STATE Michigan ~~POCO~~ CO. BayOPERATOR Gulf Refining Co.FARM Jerry WELL NO. 1TWP. Hampton S. 16 T. 14N R. 6ELOC. NE SE NWWILDCAT ☐ FIELD ☐ FIELD NAME _____

MAP NO. _____ CO-ORD. _____ ELEV. _____

STATUS Plugged and Abandoned 10-2-52Total Depth 3935'

NORTH

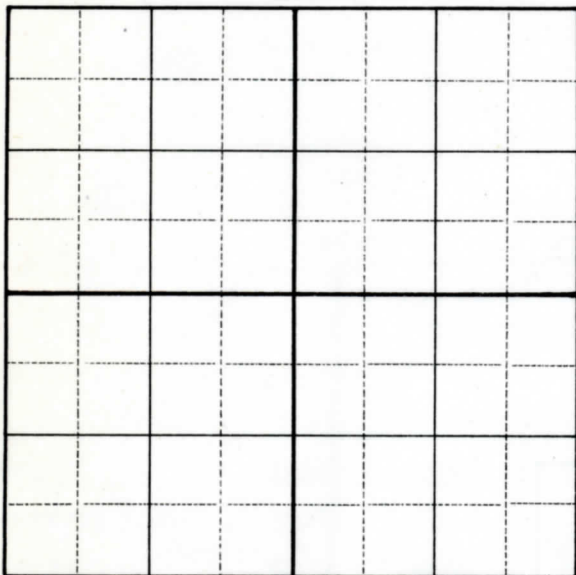
DATE 11-25-52 SCOUT DRS

	"	"	West	"	"	"
--	---	---	------	---	---	---

 or Input Well

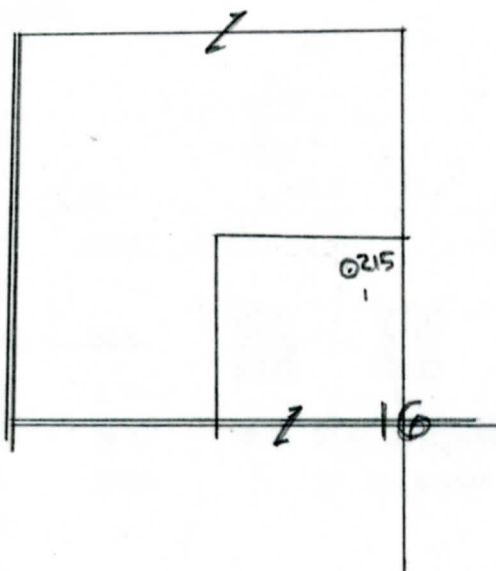

Vice-President – General Manager

THE PURE OIL COMPANY

The Pure Oil Company

COMPLETION RECORD OF WELLS DRILLED BY OTHER OPERATORS

Michigan Producing Division

Date **May 16, 1945** No. **215**
 State **Mich.** County **Bay** Dist. **Hampton** Sec. **16** Twp. **14 N** Rge. **6 E**
 (Serial No.)
 Well No. **1** (County No.) **215** Farm **Jerry** Acres
 Operator **Gulf Refining Company** Information secured **By Scout Department**
 Date well started **3-12-45** Date well completed **4-20-45** Elevation **587.0**

PRODUCTION BOARD

1st 24 hours natural **None reported.**
 2nd 24 hours natural
 Date of acid **5-7-45 and** No. of
~~shot~~ **5-12-45** quarts From To From to
 Date of acid **See above.** No. of gallons **1500**
 1st **12** hours after acid **shot** **11 Barrels (Pumped)**
~~shot~~
 2nd 24 hours after acid **shot** **40 " "**

FORMATION AND CASING RECORD

Formation	Top	Bottom	Top Pay	Bottom Pay	Remarks	Casing	
						Size	Set at
Berea	1460	SLM.	(-873)			10"	135
Traverse Lime	1969	(-1382)				5-3/16"	2667
Dundee (-2065)	2652	SLM.	2720 2763	2738 2765	(-2133) (-2176) See remarks below.		
Detroit River	3039	(-2452)	2822	2830	(-2235)		
Cored:	3461	3470	Rec. 8'6" Anhydrite.				
"	3521	3526	" 3' Dolomite and Anhydrite.				
Sylvania Form.	3850	(-3263)					
Sylvania Sand	3921	(-3334)					
Cored:	3910	3925	Rec. 14'6" Sandy Dolo.-pin points oil		3920-3925. (-3333)		
"	3925	3935	" 7' Sandy Dolo.-show salt water.				
D.S.T.	3920	3935	Open 1 hr.-rec. small show gas and 45 ft. oil cut mud.				
Total Depth		3935	(-3348)				
Plugged back: and cleaned out.	(-2293)	2880	Treated Dundee.				

Remarks Dundee: Cored: 2848-2858 rec. 8' Lime-pin point porosity-bleeding oil; 2858-2870 rec. 10' Lime - dense; 2870-2879 rec. 8'8" Lime-dense; 2879-2888 rec. 9' Lime-dense. Producing from Dundee.

1450' equals 1460' SLM; 2644' equals 2647' SLM.

Signed

D. C. Shackelford