



Western Michigan University  
ScholarWorks at WMU

---

Legacy Scout Tickets from Pure Oil Company

---

8-20-2021

**MGRRE\_PureOilScoutTickets\_Douviec, Anna\_1\_21017117030000**

MGRRE

*Western Michigan University*

Follow this and additional works at: <https://scholarworks.wmich.edu/pure>



Part of the Geology Commons

---

#### **WMU ScholarWorks Citation**

MGRRE, "MGRRE\_PureOilScoutTickets\_Douviec, Anna\_1\_21017117030000" (2021). *Legacy Scout Tickets from Pure Oil Company*. 888.

<https://scholarworks.wmich.edu/pure/888>

This Document is brought to you for free and open access via ScholarWorks at WMU. It has been accepted for inclusion in Legacy Scout Tickets from Pure Oil Company by an authorized administrator of ScholarWorks at WMU. See the National Digital Catalogue - Science Base Catalogue for more collections submitted by MGRRE.



---

**MGRRE\_PureOilScoutTickets\_Douviec, Anna\_1\_21017117030000**

API 21017117030000

Permit Number 11703

Lease Name Douviec, Anna

Well Number 1

County Bay

Township 14N

Range 05E

Section 9

2021 DEQ or Pure co\_name Muskegon Development Company

Pure Number 230

Latitude 43.63708

Longitude -83.88104

# THE PURE OIL COMPANY

## LOCATION REPORT

Date August 1, 1945 A.F.E. No. \_\_\_\_\_

Division Mich. Producing District \_\_\_\_\_ Lease Anna Douviec

Acres \_\_\_\_\_ Lease No. \_\_\_\_\_ Elevation \_\_\_\_\_ Well No. 1 (Serial No. 230)

Quadrangle N $\frac{1}{2}$  NW NE Sec. 9 Twp. 14 N Rge. 5 E Twp. Bangor

Survey \_\_\_\_\_ County Bay State Michigan

Operator Gulf Refining Company Map Bangor Township, Bay County

<u>330</u>	Feet from North Line of Lease
" "	East " " "
" "	South " " "
<u>610</u>	" " West " " "
<u>330</u>	Feet from North Line of Section
" "	East " " "
" "	South " " "
<u>610</u>	" " West " " "

### LEGEND

- Location
- ☀ Gas Well
- Oil Well
- ☀ Gas - Distillate Well
- or ○ Dry Hole
- Dry Showing Oil
- ☀ Dry Showing Gas
- ⊙ Abandoned Location
- ☀ or ☀ Abandoned Gas Well
- or ● Abandoned Oil Well
- or ○ Input Well

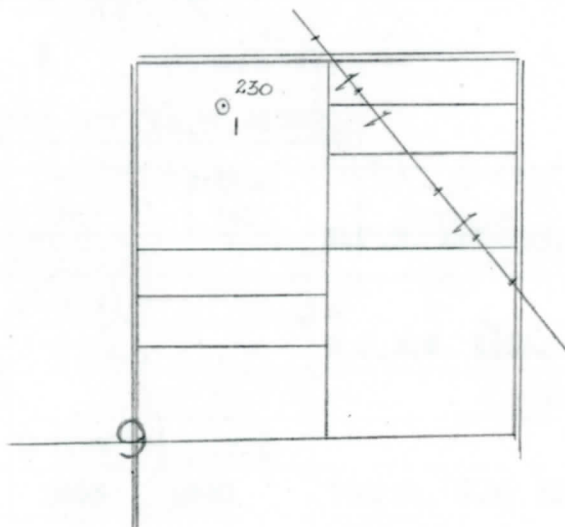

Scale \_\_\_\_\_

Remarks: \_\_\_\_\_

Submitted by \_\_\_\_\_ Civil Engineer Approved by \_\_\_\_\_ Division Manager

Approved by \_\_\_\_\_ Vice-President - General Manager

COMPLETION RECORD OF WELLS DRILLED BY OTHER OPERATORS

Michigan Producing Division

Date October 10, 1945

No. 230

State Michigan Co. Bay Twp. Bangor Sec. 9 Twp. 14 N Rge. 5 E

Well No. 1 Serial No. 230 Farm Anna Douviec Acres

Operator Gulf Refining Company

Date started 8-2-45 Date completed 9-18-45 Elevation 587.6

PRODUCTION RECORD

1st 24 hours natural 15 gals. oil and 2 bailers salt water after plug back.

Date of shot No. of quarts From To From to

Date of acid 9-27-45 No. of gallons 500

1st 24 hours after acid Pumped 23 bbls. oil and 5 barrels salt water.

Completed as: Oil Well X Gas Well Dry Hole

FORMATION AND CASING RECORD

Formation	Top	Bottom	Top Pay	Bottom Pay	Remarks	Casing	
						Size	Set at
Coldw. Red Rock	1365	1370	(-777)		H.F.W. 145-165. (-777)	10"	101
Sunbury	1549	SLM.	(-961)			8-1/4"	780
Berea	1574	"	(-986)		H.F.S.W. 1650.	8-1/4"	1770
Antrim	1770	(-1182)			(-1062)	6-5/8"	2815
Traverse Lime	2102	SLM.	(-1514)	(-2277)			
Dundee	2796	(-2208)	2865	2880	700 ft. S.W. from 2918-2924. (-2330)		
Total Depth		2924	(-2336)				
Plugged back:		2919	(-2331)				

Remarks

Signed D. C. Shackelford