



Western Michigan University
ScholarWorks at WMU

Legacy Scout Tickets from Pure Oil Company

8-20-2021

MGRRE_PureOilScoutTickets_Koth, Elmer & Margaret_1_21017121770000

MGRRE

Western Michigan University

Follow this and additional works at: <https://scholarworks.wmich.edu/pure>



Part of the Geology Commons

WMU ScholarWorks Citation

MGRRE, "MGRRE_PureOilScoutTickets_Koth, Elmer & Margaret_1_21017121770000" (2021). *Legacy Scout Tickets from Pure Oil Company*. 913.
<https://scholarworks.wmich.edu/pure/913>

This Document is brought to you for free and open access via ScholarWorks at WMU. It has been accepted for inclusion in Legacy Scout Tickets from Pure Oil Company by an authorized administrator of ScholarWorks at WMU. See the National Digital Catalogue - Science Base Catalogue for more collections submitted by MGRRE.



MGRRE_PureOilScoutTickets_Koth, Elmer & Margaret_1_21017121770000

API 21017121770000

Permit Number 12177

Lease Name Koth, Elmer & Margaret

Well Number 1

County Bay

Township 16N

Range 04E

Section 2

2021 DEQ or Pure co_name Major, Ervin

Pure Number 255

Latitude 43.81861

Longitude -83.95574

THE PURE OIL COMPANY

LOCATION REPORT

Date March 20, 1946 A.F.E. No. _____
 Division Mich. Producing District _____ Lease Elmer & Margaret Roth
Elmer & Margaret Roth
 Acres _____ Lease No. _____ Elevation _____ Well No. 1 (Serial No. 255)
 Quadrangle SW-SW-NE Sec. 2 Twp. 16 N Rge. 4 E Twp. Fraser
SW SW NE 2 16 N 4 E Fraser
 Survey _____ County Bay State Michigan
 Operator Ervin Major Map Fraser Township, Bay County

		Feet from North Line of Lease
		" " East " " "
<u>330</u>	<u>330</u>	" " South " " "
<u>330</u>	<u>330</u>	" " West " " "
		Feet from North Line of Section
		" " East " " "
<u>330</u>	<u>330</u>	" " South " " <u>1/4</u>
<u>330</u>	<u>330</u>	" " West " " "

- LEGEND**
- Location
 - ☀ Gas Well
 - Oil Well
 - ☀ Gas - Distillate Well
 - ∅ or ○ Dry Hole
 - Dry Showing Oil
 - ☀ Dry Showing Gas
 - ⊙ Abandoned Location
 - ☀ or ☀ Abandoned Gas Well
 - or ● Abandoned Oil Well
 - or ○ Input Well

Low

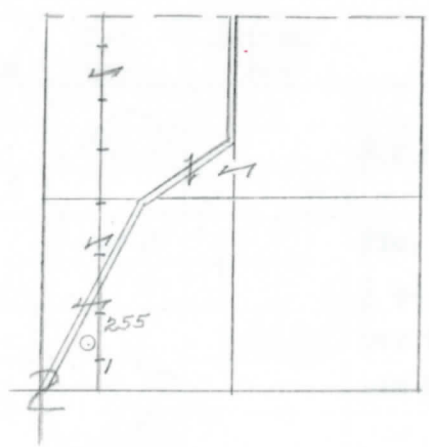

Scale _____

Remarks: _____

Submitted by CB Civil Engineer Approved by _____ Division Manager
 Approved by _____ Vice-President - General Manager

THE PURE OIL COMPANY

THE PURE OIL COMPANY

COMPLETION RECORD OF WELLS DRILLED BY OTHER OPERATORS

Michigan Producing Division

Date May 15, 1946 No. 255
 State Mich. Co. Bay ~~Sixty~~ Twp. Fraser Sec. 2 Twp. 16 N Rge. 4 E
 Well No. 1 Serial No. 255 Farm E. & M. Koth Acres _____
 Operator Ervin Major
 Date started 3-30-46 Date completed 5-11-46 Elevation 596.3

PRODUCTION RECORD

1st 24 hours natural _____
 Date of shot _____ No. of quarts _____ From _____ To _____ From _____ To _____
 Date of acid _____ No. of gallons _____ shot _____
 1st 24 hours after acid _____
 Completed as: Oil Well _____ Gas Well _____ Dry Hole

FORMATION AND CASING RECORD

Formation	Top	Bottom	Top Pay	Bottom Pay	Remarks	Casing	
						Size	Set at
Sunbury	1492	(-896)			(-954)	10"	104
Berea	1528	SLM.	(-932)		H.F.S.W. 1550.	8-1/4"	573
Antrim	1709	(-1113)			(-1834)	6-5/8"	1723
Traverse Lime	2048	SLM.	(-1452)		Flo. S.W. at 2430.	5-3/16"	2822
Dundee	2817	(-2221)			1/2 ba. salt water (-2379) per hr. 2975; 3 ba. per hr. 3007.		
Total Depth		3007	(-2411)		(-2411)		

Remarks 1590' eq. 1598' SLM; 2802' eq. 2796' SLM.

Signed D. C. Shackelford