



Western Michigan University
ScholarWorks at WMU

Legacy Scout Tickets from Pure Oil Company

8-20-2021

MGRRE_PureOilScoutTickets_STRATTON_1_21037023410000

MGRRE

Western Michigan University

Follow this and additional works at: <https://scholarworks.wmich.edu/pure>



Part of the Geology Commons

WMU ScholarWorks Citation

MGRRE, "MGRRE_PureOilScoutTickets_STRATTON_1_21037023410000" (2021). *Legacy Scout Tickets from Pure Oil Company*. 989.

<https://scholarworks.wmich.edu/pure/989>

This Document is brought to you for free and open access via ScholarWorks at WMU. It has been accepted for inclusion in Legacy Scout Tickets from Pure Oil Company by an authorized administrator of ScholarWorks at WMU. See the National Digital Catalogue - Science Base Catalogue for more collections submitted by MGRRE.



MGRRE_PureOilScoutTickets_STRATTON_1_21037023410000

API 21037023410000

Permit Number 2341

Lease Name STRATTON

Well Number 1

County Clinton

Township 8N

Range 1W

Section 4

2021 DEQ or Pure co_name ELBA DUPLAINE SYNDICATE

Pure Number 5

Latitude 43.11669

Longitude -84.43454

THE PURE OIL COMPANY

LOCATION REPORT

DATE Feb. 14, 1935

No. 5

STATE Michigan COUNTY Clinton

DIST. Duplain TWP. Duplain SEC. 4

TOWN 8-N RANGE 1W

WELL No. 1 (SERIAL No. 5) FARM

PREC. Archie Stratton

ACRES

NAME OF STREAM OR WATERS QUADRANGLE NW-NW-NE, NW-NW-NE

OPERATOR Elba-Duplain Oil Syndicate

Map Duplain - Clinton Co.

380 380 Feet from North Line of Farm

" " East " " "

" " South " " "

595 595 " " West " " "

380 380 Feet from North Line of Section

" " East " " "

" " South " " "

595 595 " " West " $\frac{1}{4}$ $\frac{1}{2}$

LEGEND

- LOCATION
- ⊙ RIG
- ⊕ DRILLING
- ☀ GAS WELL
- OIL WELL
- ⦿ SMALL OIL WELL

- ⊖ DRY HOLE
- ⦿ DRY SHOWING OIL
- ☀ DRY SHOWING GAS
- ⊖ ABANDONED LOCATION
- ☀ ABANDONED GAS WELL
- ⦿ ABANDONED OIL WELL

NOTE: Below make tracing from map, (when no map is obtainable make sketch) showing farm, center of section, this location with measurements and also wells, dry holes, or other locations in the vicinity of this location.

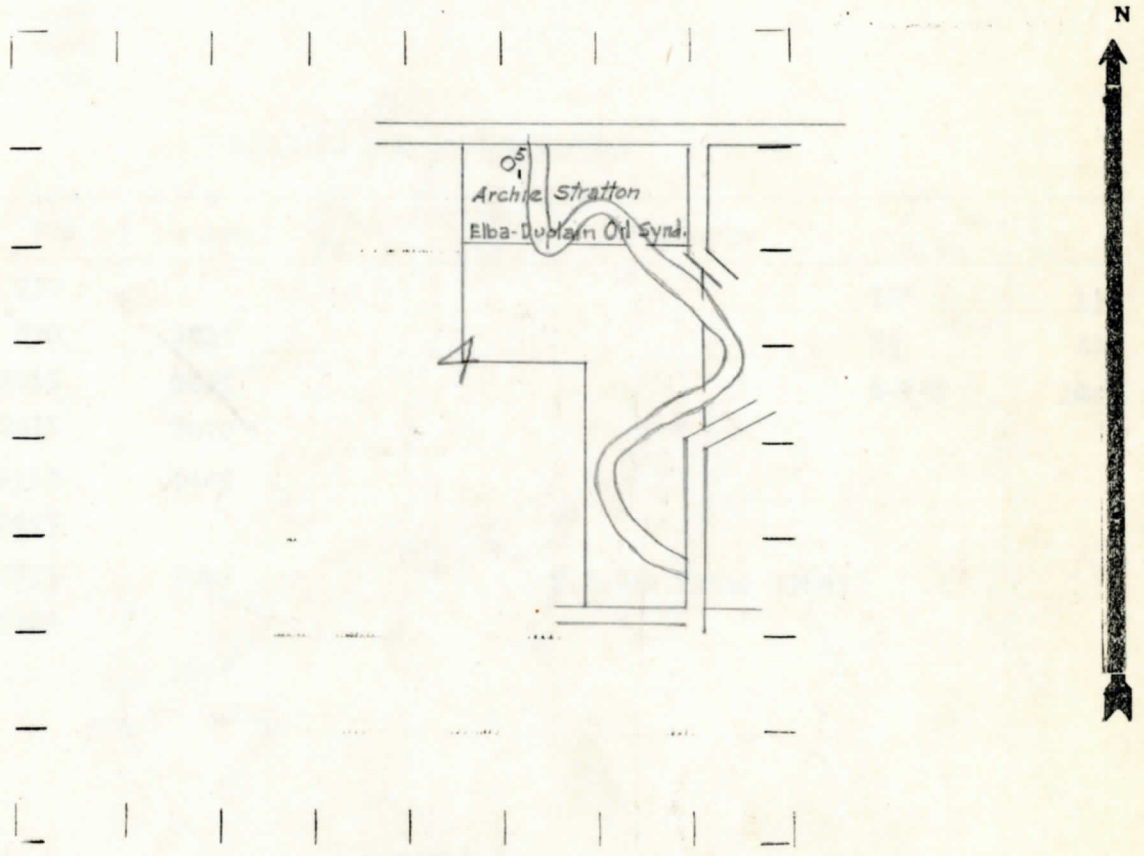

REMARKS:

SIGNED

R. A. Yeager
Superintendent or Foreman.

COMPLETION RECORD OF WELLS DRILLED BY OTHER OPERATORS

Michigan Producing Division

Date 4/25/35 No. 5
 State Michigan County Clinton Dist. Duplaine
 (Serial No.) Twp. Duplaine Sec. 4 Twp. 8N Rge. 1W
 Well No. 1 (County No.) 5 Farm Archie Stratton Acres _____
 Operator Elba-Duplain Oil Syndicate Information secured by Scouting Dept.
 Date well started 2/19/35 Date well completed 4/18/35 Elevation 689'

PRODUCTION RECORD

1st 24 hours natural Dry Hole
 2nd 24 hours natural _____
 Date of shot _____ No. of quarts _____ From _____ to _____ From _____ to _____
 Date of acid _____ No. of gallons _____
 1st 24 hours after acid shot _____
 2nd 24 hours after acid shot _____

FORMATION AND CASING RECORD

Formation	Top	Bottom	Top Pay	Bottom Pay	Remarks	Casing	
						Size	Set at
Marshall	730					10"	133'
Red Rock	890	1015				8 $\frac{1}{4}$ "	420
Sunbury	2015	2035				6-5/8"	1045
Berea	2035	2070					
Antrim	2110	2445					
Traverse	2445						
Dundee	2893	3019			H.F. Blk. Water 2984'		
Upper Monroe	3019	?					
Total Depth		3044					

Remarks _____

Signed D.H. Bell