



Western Michigan University  
ScholarWorks at WMU

---

Legacy Scout Tickets from Pure Oil Company

---

8-20-2021

**MGRRE\_PureOilScoutTickets\_BECKER\_1\_21037025530000**

MGRRE

*Western Michigan University*

Follow this and additional works at: <https://scholarworks.wmich.edu/pure>



Part of the Geology Commons

---

#### **WMU ScholarWorks Citation**

MGRRE, "MGRRE\_PureOilScoutTickets\_BECKER\_1\_21037025530000" (2021). *Legacy Scout Tickets from Pure Oil Company*. 990.

<https://scholarworks.wmich.edu/pure/990>

This Document is brought to you for free and open access via ScholarWorks at WMU. It has been accepted for inclusion in Legacy Scout Tickets from Pure Oil Company by an authorized administrator of ScholarWorks at WMU. See the National Digital Catalogue - Science Base Catalogue for more collections submitted by MGRRE.



---

**MGRRE\_PureOilScoutTickets\_BECKER\_1\_21037025530000**

API 21037025530000

Permit Number 2553

Lease Name BECKER

Well Number 1

County Clinton

Township 8N

Range 3W

Section 35

2021 DEQ or Pure co\_name BURRIS D A

Pure Number 6

Latitude 43.03704

Longitude -84.62871

DATE June 13, 1935

LOCATION REPORT

No. 6

STATE Michigan COUNTY Clinton DIST. Essex SEC. 35 TOWN 8N RANGE 3W

WELL No. 1 (SERIAL No. 6) FARM John Becker ACRES 160

NAME OF STREAM OR WATERS \_\_\_\_\_ QUADRANGLE C-NW-SE

OPERATOR D. A. Burris Map Essex Township, Clinton County

660 660 Feet from North Line of Farm

\_\_\_\_\_ " " East " " "

\_\_\_\_\_ " " South " " "

660 660 " " West " " "

660 660 Feet from North Line of Section

\_\_\_\_\_ " " East " " "

\_\_\_\_\_ " " South " " "

660 660 " " West " "  $\frac{1}{4}$ "

LEGEND

○ LOCATION

⊕ RIG

⊕ DRILLING

☀ GAS WELL

● OIL WELL

⬮ SMALL OIL WELL

⊕ DRY HOLE

⬮ DRY SHOWING OIL

☀ DRY SHOWING GAS

⊕ ABANDONED LOCATION

☀ ABANDONED GAS WELL

⬮ ABANDONED OIL WELL

NOTE: Below make tracing from map, (when no map is obtainable make sketch) showing farm, center of section, this location with measurements and also wells, dry holes, or other locations in the vicinity of this location.

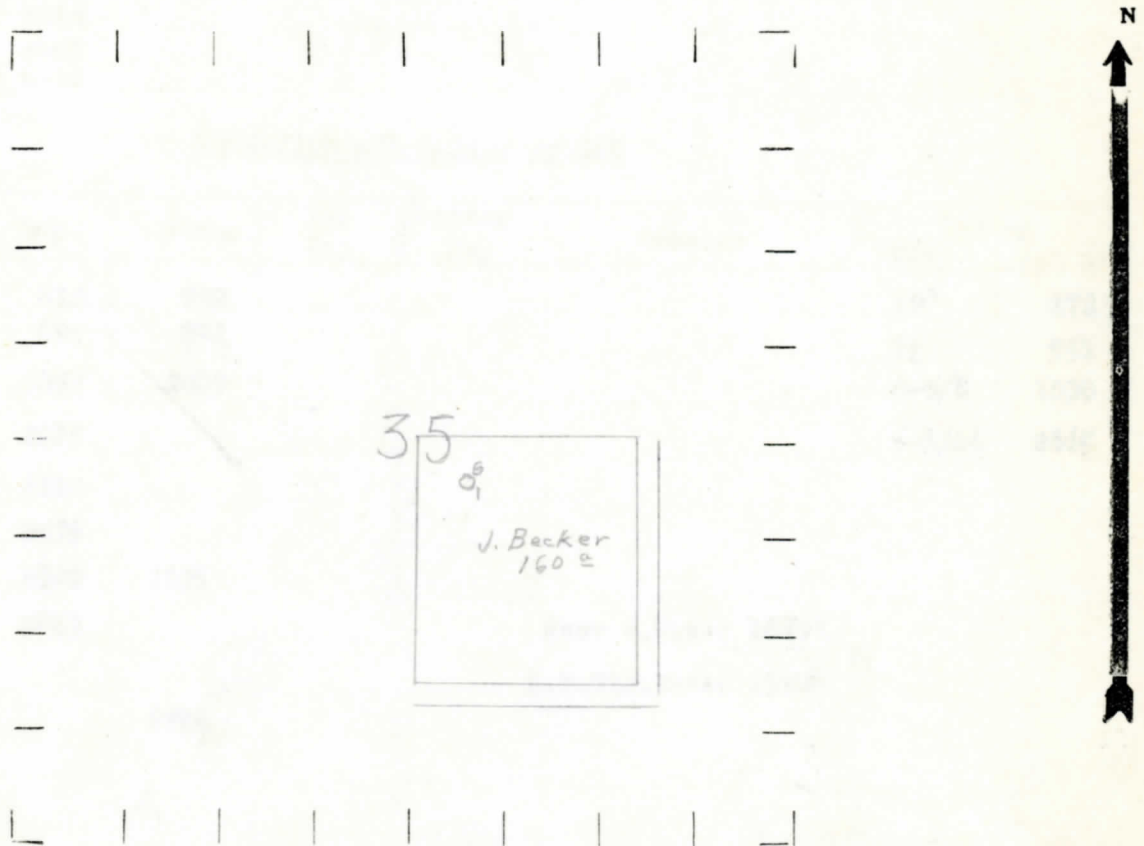

REMARKS:

SIGNED

*R. L. Yager*

Superintendent or Foreman.

Michigan Producing Division

Date 9/19/35 No. 6  
 State Michigan County Clinton Dist. \_\_\_\_\_  
 (Serial No.) \_\_\_\_\_ Twp. Essex Sec. 35 Twp. 8N Rge. 3W  
 Well No. 1 (County No.) 6 Farm John Becker Acres \_\_\_\_\_  
 Operator D. A. Burris Information secured by Scouting Dept.  
 Date well started 7/1/35 Date well completed 9/14/35 Elevation 726'

PRODUCTION RECORD

1st 24 hours natural Dry Hole  
 2nd 24 hours natural \_\_\_\_\_  
 Date of shot \_\_\_\_\_ No. of quarts \_\_\_\_\_ From \_\_\_\_\_ to \_\_\_\_\_ From \_\_\_\_\_ to \_\_\_\_\_  
 Date of acid \_\_\_\_\_ No. of gallons \_\_\_\_\_  
 1st 24 hours after acid shot \_\_\_\_\_  
 2nd 24 hours after acid shot \_\_\_\_\_

FORMATION AND CASING RECORD

| Formation          | Top  | Bottom | Top Pay | Bottom Pay | Remarks               | Casing  |        |
|--------------------|------|--------|---------|------------|-----------------------|---------|--------|
|                    |      |        |         |            |                       | Size    | Set at |
| Marshall           | 810  | 892    |         |            |                       | 10"     | 172'   |
| Red Rock           | 892  | 992    |         |            |                       | 8 1/4"  | 551    |
| Sunbury            | 2057 | 2080   |         |            |                       | 6-5/8"  | 1030   |
| Berea              | 2080 |        |         |            |                       | 5-3/16" | 2865   |
| Antrim             | 2110 |        |         |            |                       |         |        |
| Traverse Formation | 2475 |        |         |            |                       |         |        |
| " Lime             | 2500 | 2835   |         |            |                       |         |        |
| Dundee             | 2863 |        |         |            | Show S. Water 2889'   |         |        |
|                    |      |        |         |            | H.F. Blk. Water 2920' |         |        |
| Total Depth        |      | 2920   |         |            |                       |         |        |

Remarks Show O. & G. 2547' - H.F.S. Water 2548'

Signed S. H. Bell  
 2.