



Western Michigan University
ScholarWorks at WMU

Legacy Scout Tickets from Pure Oil Company

8-20-2021

**MGRRE_PureOilScoutTickets_JENISON,
HOMER_1_21037035950000**

MGRRE

Western Michigan University

Follow this and additional works at: <https://scholarworks.wmich.edu/pure>



Part of the Geology Commons

WMU ScholarWorks Citation

MGRRE, "MGRRE_PureOilScoutTickets_JENISON, HOMER_1_21037035950000" (2021). *Legacy Scout Tickets from Pure Oil Company*. 999.

<https://scholarworks.wmich.edu/pure/999>

This Document is brought to you for free and open access via ScholarWorks at WMU. It has been accepted for inclusion in Legacy Scout Tickets from Pure Oil Company by an authorized administrator of ScholarWorks at WMU. See the National Digital Catalogue - Science Base Catalogue for more collections submitted by MGRRE.



MGRRE_PureOilScoutTickets_JENISON, HOMER_1_21037035950000

API 21037035950000

Permit Number 3595

Lease Name JENISON, HOMER

Well Number 1

County Clinton

Township 5N

Range 1W

Section 6

2021 DEQ or Pure co_name PETROLEUM EXPLORATION CO

Pure Number 15

Latitude 42.84657

Longitude -84.46594

The Pure Oil Company
THE PURE OIL COMPANY

DATE October 8, 1936

LOCATION REPORT

No. 15

STATE Michigan COUNTY Clinton DIST. Bath TWP. Bath SEC. 6 TOWN 5 N RANGE 1 W

WELL No. 1 (SERIAL No. 15) FARM Homer Jenison ACRES _____

NAME OF STREAM OR WATERS _____ QUADRANGLE C 3 1/2 NE SE

OPERATOR Petroleum Exploration Company Map Bath Township, Clinton County

990	Feet from North Line of Farm				
660	" " East " " "				
	" " South " " "				
	" " West " " "				
990	Feet from North Line of Section				
660	" " East " " "				
	" " South " " "				
	" " West " " "				

LEGEND

- LOCATION
- ⊙ RIG
- ⊕ DRILLING
- ☀ GAS WELL
- OIL WELL
- ⊙ SMALL OIL WELL
- ⊙ DRY HOLE
- ◆ DRY SHOWING OIL
- ⊙ DRY SHOWING GAS
- ⊙ ABANDONED LOCATION
- ☀ ABANDONED GAS WELL
- ABANDONED OIL WELL

NOTE: Below make tracing from map, (when no map is obtainable make sketch) showing farm, center of section, this location with measurements and also wells, dry holes, or other locations in the vicinity of this location.

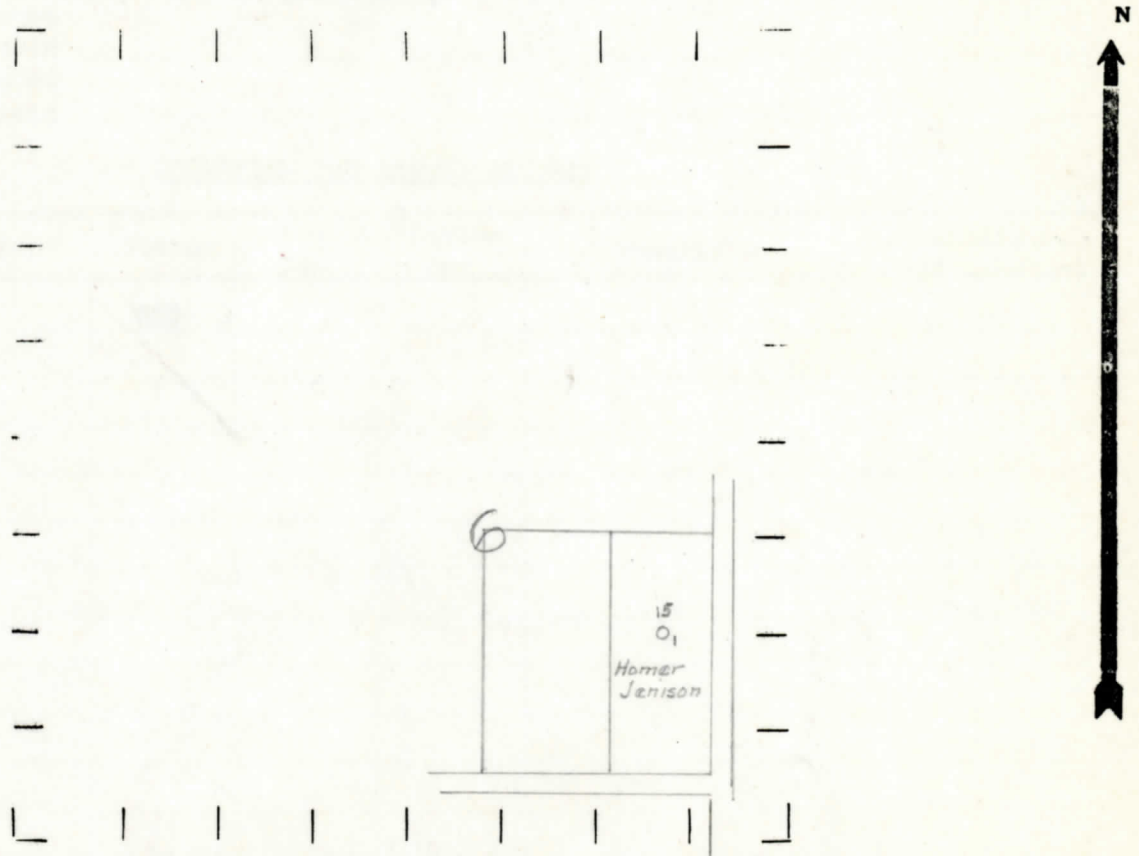

REMARKS:

SIGNED

R. L. Yeager

Superintendent or Foreman.

