



Legacy Scout Tickets from Pure Oil Company

8-20-2021

**MGRRE_PureOilScoutTickets_STURDIVAN,
ABBIE_1_21037044590000**

MGRRE

Western Michigan University

Follow this and additional works at: <https://scholarworks.wmich.edu/pure>



Part of the Geology Commons

WMU ScholarWorks Citation

MGRRE, "MGRRE_PureOilScoutTickets_STURDIVAN, ABBIE_1_21037044590000" (2021). *Legacy Scout Tickets from Pure Oil Company*. 1001.

<https://scholarworks.wmich.edu/pure/1001>

This Document is brought to you for free and open access via ScholarWorks at WMU. It has been accepted for inclusion in Legacy Scout Tickets from Pure Oil Company by an authorized administrator of ScholarWorks at WMU. See the National Digital Catalogue - Science Base Catalogue for more collections submitted by MGRRE.



MGRRE_PureOilScoutTickets_STURDIVAN, ABBIE_1_21037044590000

API 21037044590000

Permit Number 4459

Lease Name STURDIVAN, ABBIE

Well Number 1

County Clinton

Township 7N

Range 2W

Section 36

2021 DEQ or Pure co_name NORRIS J T TRUSTEE

Pure Number 17

Latitude 42.95471

Longitude -84.50218

THE PURE OIL COMPANY

DATE September 9, 1937

LOCATION REPORT

No. 17

STATE Michigan COUNTY Clinton DIST. Bingham TWP. Bingham SEC. 36 TOWN 7 N RANGE 2 W
WELL No. 1 (SERIAL No. 17) FARM Abbie Sturdivan ACRES

NAME OF STREAM OR WATERS _____ QUADRANGLE SW NW NW

OPERATOR J. T. Norris, Trustee Map Bingham Township, Clinton County

Feet from North Line of Farm

_____ " " East " " "

330 330 " " South " " "

330 330 " " West " " "

Feet from North Line of Section

_____ " " East " " "

_____ " " South " " "

330 330 " " West " " "

h 420 - Sp 8.27 - 37 =
10" 135

- LEGEND**
- LOCATION
 - ⊕ RIG
 - ⊕ DRILLING
 - ☀ GAS WELL
 - OIL WELL
 - SMALL OIL WELL
 - ⊙ DRY HOLE
 - ◆ DRY SHOWING OIL
 - ⊙ DRY SHOWING GAS
 - ⊙ ABANDONED LOCATION
 - ☀ ABANDONED GAS WELL
 - ABANDONED OIL WELL

NOTE: Below make tracing from map, (when no map is obtainable make sketch) showing farm, center of section, this location with measurements and also wells, dry holes, or other locations in the vicinity of this location.

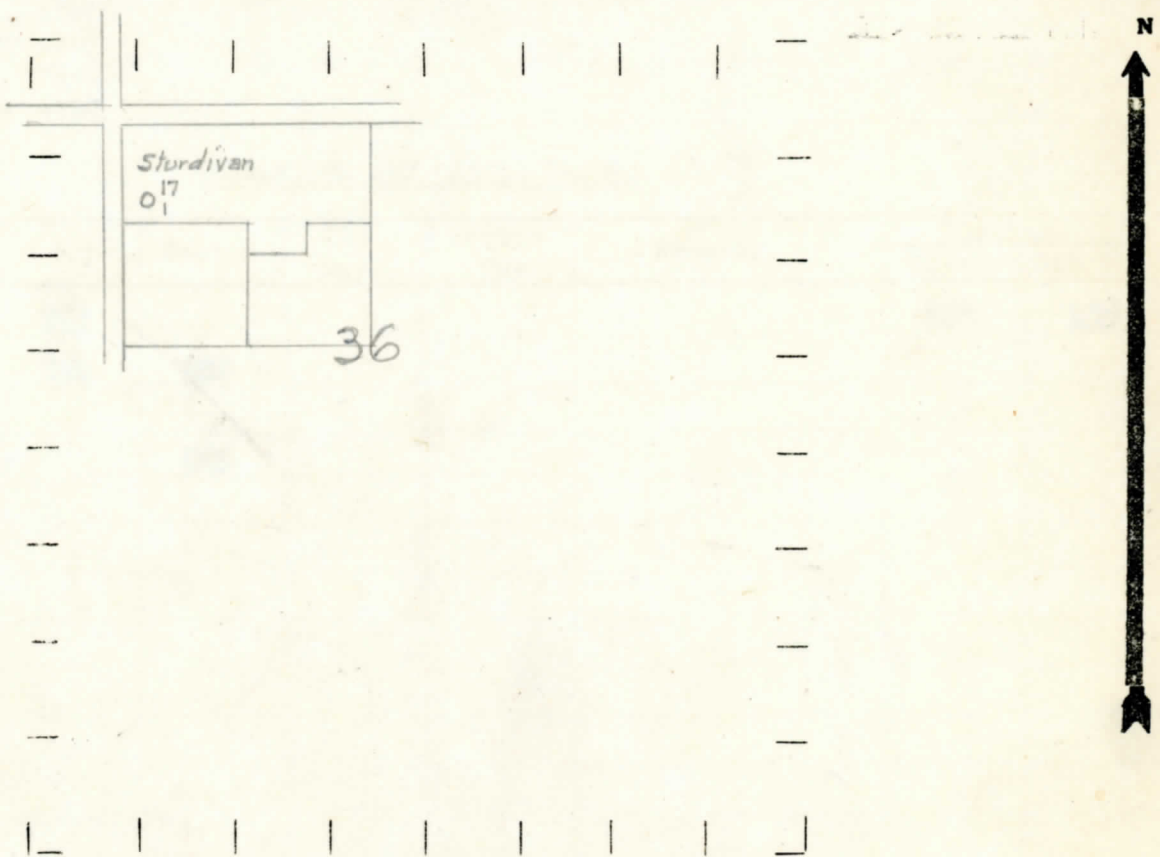

REMARKS: _____

SIGNED _____
Superintendent or Foreman.

COMPLETION RECORD OF WELLS DRILLED BY OTHER OPERATORS

Michigan Producing Division

Date September 30, 1937 No. 17
 State Mich. County Clinton Dist. Bingham Twp. 36 Sec. 7N Rge. 2W
 Well No. 1 (Serial No.) (County No.) 17 Farm Abbie Sturdivan Acres
 Operator J. T. Morris, Tr. Information secured from Scouting Dept. by
 Date well started 8-27-37 Date well completed 9-21-37 Elevation 770.2'

PRODUCTION RECORD

1st 24 hours natural Dry Hole
 2nd 24 hours natural
 Date of shot No. of quarts From to From to
 Date of acid No. of gallons
 shot
 1st 24 hours after acid
 shot
 2nd 24 hours after acid

FORMATION AND CASING RECORD

Formation	Top	Bottom	Top Pay	Bottom Pay	Remarks	Casing	
						Size	Set At
Marshall	755					10"	135
Red Rock	850	900					
Total Depth		985					

Remarks This well too low on Marshall so was abandoned as a dry hole.

Signed Dean C. Shackelford