



Western Michigan University
ScholarWorks at WMU

Legacy Scout Tickets from Pure Oil Company

8-20-2021

**MGRRE_PureOilScoutTickets_SOMMERVILLE, F.
W._1_21037096560000**

MGRRE
Western Michigan University

Follow this and additional works at: <https://scholarworks.wmich.edu/pure>



Part of the Geology Commons

WMU ScholarWorks Citation

MGRRE, "MGRRE_PureOilScoutTickets_SOMMERVILLE, F. W._1_21037096560000" (2021). *Legacy Scout Tickets from Pure Oil Company*. 1009.
<https://scholarworks.wmich.edu/pure/1009>

This Document is brought to you for free and open access via ScholarWorks at WMU. It has been accepted for inclusion in Legacy Scout Tickets from Pure Oil Company by an authorized administrator of ScholarWorks at WMU. See the National Digital Catalogue - Science Base Catalogue for more collections submitted by MGRRE.



MGRRE_PureOilScoutTickets_SOMMERVILLE, F. W._1_21037096560000

API 21037096560000

Permit Number 9656

Lease Name SOMMERVILLE, F. W.

Well Number 1

County Clinton

Township 8N

Range 2W

Section 12

2021 DEQ or Pure co_name GRALE OIL CO

Pure Number 25

Latitude 43.09886

Longitude -84.48753

COMPLETION RECORD THE PURE OIL COMPANY OPERATORS

Date July 1, 1942 LOCATION REPORT A.F.E. No.

Division Mich. Producing District Lease F.W. SOMMERVILLE F. W. Sommerville

Acres Lease No. Elevation Well No. 1 (Serial No. 25)

Quadrangle NW SE NE Sec. 12 Twp. 8 N Rge. 2 W GREENBUSH Greenbush

Survey County Clinton State Michigan

Operator Grale Oil Co Map GREENBUSH TWP, CLINTON CO. Greenbush Township, Clinton County

330	330	Feet from North Line of Lease
"	"	East " " "
"	"	South " " "
330	330	West " " "
Feet from North Line of Section		
990	990	East " 1/4 "
990	990	South " " "
"	"	West " " "

Loos

LEGEND

- Location
- ☀ Gas Well
- Oil Well
- ☀ Gas - Distillate Well
- or ○ Dry Hole
- Dry Showing Oil
- ☀ Dry Showing Gas
- ⊗ Abandoned Location
- ☀ or ☀ Abandoned Gas Well
- or ● Abandoned Oil Well
- or ○ Input Well

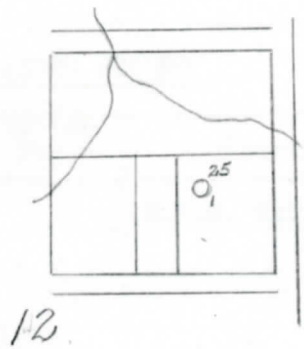

Scale _____

Remarks: _____

Submitted by _____ Civil Engineer Approved by _____ Division Manager

Approved by _____ Vice-President - General Manager

Michigan Producing Division

Date October 7, 1942 No. 25
 State Mich. County Clinton ~~Exxxx~~ Twp. Greenbush Sec. 12 Twp. 8 N Rge. 2 W
 Well No. 1 (Serial No.) ~~Exxxx~~ 25 Farm F. W. Somerville Acres _____
 Operator Grale Oil Company Information secured ~~from~~ Scouting Department By _____
 Date well started 7-31-42 Date well completed 9-28-42 Elevation 698.3

PRODUCTION RECORD

1st 24 hours natural Dry Hole
 2nd 24 hours natural _____
 Date of shot _____ No. of quarts _____ From _____ to _____ From _____ to _____
 Date of acid _____ No. of gallons _____
 1st 24 hours after acid shot
 2nd 24 hours after acid shot

FORMATION AND CASING RECORD

Formation	Top	Bottom	Top Pay	Bottom Pay	Remarks	Casing	
						Size	Set at
Marshall	705				H.F.W. 717.	10"	216
Red Rock	835	975				8-1/4"	656
Coldw. Red Rock	1975	1982				6-5/8"	995
Sunbury	1997	2010					
Berea	2025	2075					
Antrim	2075						
Traverse Lime	2421				H.F.S.W. 2421-28.		
Dundee	2866				H.F.S.W. 2885.		
Monroe	3075				Black salt water at 2925 and 3020.		
Total Depth		3641					

Remarks _____

Signed D. C. Shackelford