



Western Michigan University
ScholarWorks at WMU

Legacy Scout Tickets from Pure Oil Company

8-20-2021

**MGRRE_PureOilScoutTickets_REDMOND, ClareNCE W. &
ALICE_1_21037097370000**

MGRRE

Western Michigan University

Follow this and additional works at: <https://scholarworks.wmich.edu/pure>



Part of the Geology Commons

WMU ScholarWorks Citation

MGRRE, "MGRRE_PureOilScoutTickets_REDMOND, ClareNCE W. & ALICE_1_21037097370000" (2021).

Legacy Scout Tickets from Pure Oil Company. 1010.

<https://scholarworks.wmich.edu/pure/1010>

This Document is brought to you for free and open access via ScholarWorks at WMU. It has been accepted for inclusion in Legacy Scout Tickets from Pure Oil Company by an authorized administrator of ScholarWorks at WMU. See the National Digital Catalogue - Science Base Catalogue for more collections submitted by MGRRE.



**MGRRE_PureOilScoutTickets_REDMOND, ClareNCE W. &
ALICE_1_21037097370000**

API 21037097370000

Permit Number 9737

Lease Name REDMOND, ClareNCE W. & ALICE

Well Number 1

County Clinton

Township 5N

Range 1W

Section 20

2021 DEQ or Pure co_name AMERICAN DRILLING CO

Pure Number 26

Latitude 42.81224

Longitude -84.44585

The Pure Oil Company
THE PURE OIL COMPANY OPERATORS

26

Date August 19, 1942 A.F.E. No. _____
 Division Mich. Producing District _____ Lease Redmond
 Acres _____ Lease No. _____ Elevation _____ Well No. 1 (Serial No. 26)
 Quadrangle C N 2 NE NE Sec. 20 Twp. 5 N Rge. 1 W Bath Bath
 Survey _____ County Clinton State Michigan

Operator American Drilling Company Map Bath Township, Clinton County

330	330	Feet from North Line of Lease
660	660	" " East " " "
		" " South " " "
		" " West " " "
330	330	Feet from North Line of Section
660	660	" " East " " "
		" " South " " "
		" " West " " "

Loop

LEGEND

- Location
- ☀ Gas Well
- Oil Well
- ☀ Gas - Distillate Well
- ∅ or ○ Dry Hole
- Dry Showing Oil
- ☀ Dry Showing Gas
- ⊗ Abandoned Location
- ☀ or ⊗ Abandoned Gas Well
- or ● Abandoned Oil Well
- or ○ Input Well

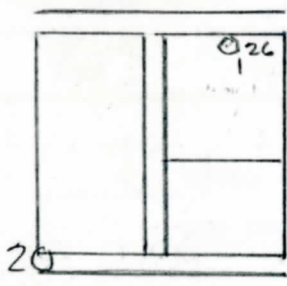

Scale _____

Remarks: _____

Submitted by W Civil Engineer Approved by _____ Division Manager
 Approved by _____ Vice-President - General Manager

Michigan Producing Division

Date 11-4-42 No. 26
 State Mich. County Clinton Twp. Bath Sec. 20 Twp. 5 N Rge. 1 W
 Well No. 1 (Serial No. 26) Farm Redmond Acres _____
 Operator American Drilling Company Information secured ~~from~~ ^{by} Scouting Department
 Date well started 9-21-42 Date well completed 10-27-42 Elevation 865.8

PRODUCTION RECORD

1st 24 hours natural Dry Hole
 2nd 24 hours natural _____
 Date of shot _____ No. of quarts _____ From _____ to _____
 Date of acid _____ No. of gallons _____
 1st 24 hours after acid shot _____
 2nd 24 hours after acid shot _____

FORMATION AND CASING RECORD

Formation	Top	Bottom	Top Pay	Bottom Pay	Remarks	Casing	
						Size	Set at
Marshall	839	Log.				10"	164
Red Rock	910	980	Log.		Water - 2 bailers	8-1/4"	727
Coldw. Red Rock	1960	2075	"		per hr. 1450-1460.	6-5/8"	1110
Sunbury	2085	2105	SLM.			5-3/16"	2715
Berea	2105	S.L.M.					
Antrim	2192						
Traverse Lime	2481	S.L.M.			H.F.S.W. 2550.		
Dundee	2773						
Monroe	2825				H.F.S.W. 2920-2930.		
Total Depth		2934					

Remarks 2245' CTM equals 2257' SLM; 2477' CTM equals 2481' SLM.

Signed D. C. Shackelford