



Western Michigan University  
ScholarWorks at WMU

---

Legacy Scout Tickets from Pure Oil Company

---

8-20-2021

**MGRRE\_PureOilScoutTickets\_KELLAM, LEE\_1\_21037112710000**

MGRRE

*Western Michigan University*

Follow this and additional works at: <https://scholarworks.wmich.edu/pure>



Part of the Geology Commons

---

#### **WMU ScholarWorks Citation**

MGRRE, "MGRRE\_PureOilScoutTickets\_KELLAM, LEE\_1\_21037112710000" (2021). *Legacy Scout Tickets from Pure Oil Company*. 1022.

<https://scholarworks.wmich.edu/pure/1022>

This Document is brought to you for free and open access via ScholarWorks at WMU. It has been accepted for inclusion in Legacy Scout Tickets from Pure Oil Company by an authorized administrator of ScholarWorks at WMU. See the National Digital Catalogue - Science Base Catalogue for more collections submitted by MGRRE.



---

**MGRRE\_PureOilScoutTickets\_KELLAM, LEE\_1\_21037112710000**

API 21037112710000

Permit Number 11271

Lease Name KELLAM, LEE

Well Number 1

County Clinton

Township 8N

Range 4W

Section 33

2021 DEQ or Pure co\_name SMITH PETROLEUM CO

Pure Number 38

Latitude 43.0442

Longitude -84.78315

# THE PURE OIL COMPANY LOCATION REPORT

Date December 6, 1944 A.F.E. No. \_\_\_\_\_  
 Division Mich. Producing District \_\_\_\_\_ Lease Lee Kellam  
 Acres \_\_\_\_\_ Lease No. \_\_\_\_\_ Elevation \_\_\_\_\_ Well No. 1 (Serial No. 38)  
 Quadrangle SW NE NE Sec. 33 Twp. 8 N Rge. 4 W ~~XBIM~~ Lebanon  
~~Dist.~~ Twp. Lebanon  
 Survey \_\_\_\_\_ County Clinton State Michigan  
 Operator Smith Petroleum Company Map Lebanon Twp. Clinton Co.

		Feet from North Line of Lease			
		" "	East	" "	" "
<u>330</u>	<u>330</u>	" "	South	" "	" "
<u>330</u>	<u>330</u>	" "	West	" "	" "
<u>990</u>	<u>990</u>	Feet from North Line of Section			
<u>990</u>	<u>990</u>	" "	East	" "	" "
		" "	South	" "	" "
		" "	West	" "	" "

### LEGEND

- Location
- ☀ Gas Well
- Oil Well
- ☀ Gas - Distillate Well
- ⊘ or ○ Dry Hole
- Dry Showing Oil
- ☀ Dry Showing Gas
- ⊘ Abandoned Location
- ☀ or ☀ Abandoned Gas Well
- or ● Abandoned Oil Well
- or ○ Input Well

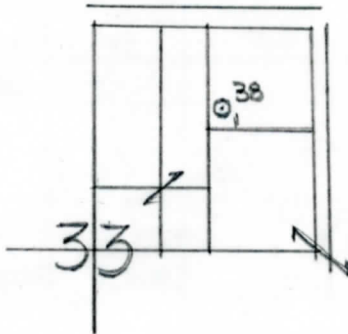

Remarks: \_\_\_\_\_  
 \_\_\_\_\_  
 \_\_\_\_\_

Scale \_\_\_\_\_

Submitted by RN Civil Engineer Approved by \_\_\_\_\_ Division Manager  
 Approved by \_\_\_\_\_ Vice-President - General Manager

COMPLETION RECORD OF WELLS DRILLED BY OTHER OPERATORS

Michigan Producing Division

Date May 9, 1945 No. 38  
 State Mich. County Clinton ~~Diakon~~ Twp. Lebanon Sec. 33 Twp. 8 N Rge. 4 W  
 Well No. 1 (~~Serial No.~~) 28 Farm Lee Kellan Acres  
 Operator Smith Petroleum Company Information secured ~~By~~ Scouting Department  
 Date well started 12-10-44 Date well completed 5-4-45 Elevation 751.8

PRODUCTION BOARD

1st 24 hours natural Dry Hole  
 2nd 24 hours natural  
 Date of shot No. of quarts From To From to  
 Date of acid 2-2-45 No. of gallons 200  
12 ~~33~~ hours after acid 56 Barrels & Pumped off. (Pumped) (Traverse Oil)  
 shot  
 2nd 24 hours after acid

FORMATION AND CASING RECORD

Formation	Top	Bottom	Top Pay	Bottom Pay	Remarks	Casing	
						Size	Set at
Brown Dolomite	758	S.L.M.	(-6)			10"	234
Mich. Stray	777	(-25)			H.F.W. at 782.	8-1/4"	643
Marshall	850	1031	(-98)		(-30)	6-5/8"	1053
Coldw. Red Rock	2110	2113	(-1358)			5-3/16"	2575 Pulled
Antrim	2125	2520	(-1373) S.L.M.			5-3/16"	2934
Trav. (Squaw Bay)	2549	(-1799)			Small show oil 2560.	(-1808)	
Trav. (Alpena)	2565	(-1813)			750 ft. Oil in 15 hrs. 2572-2575.	(-1820)	
					Show salt wtr. 2575.	(-1823)	
Dundee	2930	S.L.M.	(-2178)		1 ba. S.W./hr. 2946-2951.	(-2194)	
					Inc. S.W. 2983-2985.	(-2231)	
					900 ft. S.W. in 9 hrs. at 2994 1/2	(-2242 1/2)	
Total Depth		3000	(-2248)				

Remarks Produced about 121 bbls. oil on pump in 8 days before acidizing-pumped 138 bbls. in 10 days after acid-abandoned as Traverse producer and deepened to Dundee.  
 836' eq. 838' SLM; 2013' eq. 2020' SLM; 2541' eq. 2541' SLM; 2906' eq. 2906' SLM; 2934' eq. 2934' SLM.

Signed D. C. Shackelford