



Western Michigan University  
ScholarWorks at WMU

---

Legacy Scout Tickets from Pure Oil Company

---

8-20-2021

**MGRRE\_PureOilScoutTickets\_Bothwell Heirs\_1\_21035008240000**

MGRRE

*Western Michigan University*

Follow this and additional works at: <https://scholarworks.wmich.edu/pure>



Part of the Geology Commons

---

#### WMU ScholarWorks Citation

MGRRE, "MGRRE\_PureOilScoutTickets\_Bothwell Heirs\_1\_21035008240000" (2021). *Legacy Scout Tickets from Pure Oil Company*. 1032.

<https://scholarworks.wmich.edu/pure/1032>

This Document is brought to you for free and open access via ScholarWorks at WMU. It has been accepted for inclusion in Legacy Scout Tickets from Pure Oil Company by an authorized administrator of ScholarWorks at WMU. See the National Digital Catalogue - Science Base Catalogue for more collections submitted by MGRRE.



---

**MGRRE\_PureOilScoutTickets\_Bothwell Heirs\_1\_21035008240000**

API 21035008240000

Permit Number 824

Lease Name Bothwell Heirs

Well Number 1

County Clare

Township 18N

Range 04W

Section 15

2021 DEQ or Pure co\_name Mammoth Producing and Refining Corporation

Pure Number 4

Latitude 43.95274

Longitude -84.7772

THE PURE OIL COMPANY  
LOCATION REPORTNo. 4DATE Oct. 11, 1929STATE Michigan COUNTY Clare DIST. Hutton SEC. 15 TOWN 18N RANGE 4W  
WELL No. 1 (SERIAL No. 4) FARM A. Bothwell ACRESNAME OF STREAM OR WATERS \_\_\_\_\_ QUADRANGLE SW - NEOPERATOR Oaks-Livingston MAP Hutton Twp., Clare County

\_\_\_\_\_ Feet from North Line of Farm

\_\_\_\_\_ " " East " " "

\_\_\_\_\_ 200 " " South " " "

\_\_\_\_\_ 200 " " West " " "

\_\_\_\_\_ 2440 Feet from North Line of Section

\_\_\_\_\_ 2440 " " East " " "

\_\_\_\_\_ " " South " " "

\_\_\_\_\_ " " West " " "

## LEGEND

○ LOCATION

① RIG

⊕ DRILLING

⊗ GAS WELL

● OIL WELL

⬮ SMALL OIL WELL

⬮ DRY HOLE

⬮ DRY SHOWING OIL

⬮ DRY SHOWING GAS

⬮ ABANDONED LOCATION

⬮ ABANDONED GAS WELL

⬮ ABANDONED OIL WELL

NOTE: Below make tracing from map, (when no map is obtainable make sketch) showing farm, center of section, this location with measurements and also wells, dry holes, or other locations in the vicinity of this location. Make copy to keep for reference and send original to Columbus office.

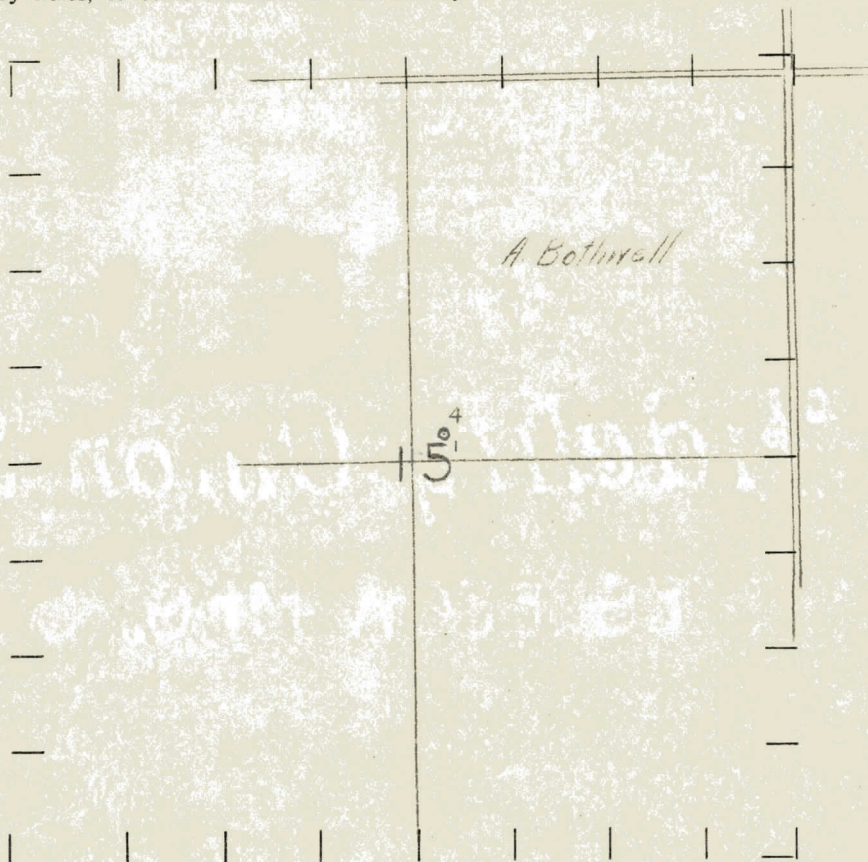

REMARKS:

SIGNED

Superintendent or Foreman.



DATE Oct. 4, 1930.

No. 4

WELL No. 1 (SERIAL No. 4) FARM A. Bothwell ACRES           

NAME OF STREAM OR WATERS QUADRANGLE SW - NE

OPERATOR Oaks-Livingston MAP Hatton Twp., Clare Co.

LOCATION REPORT SENT IN (DATE) Oct. 11, 1929.

WELL STARTED (DATE) October 1929. WELL COMPLETED (DATE) Oct. 4, 1930.

ON WEDNESDAY

GASWELLS

DRY HOLE

ABANDONED WELLS

CROSS OUT THREE OF THE ABOVE  
WELL RECORD

DATE OF SHOT \_\_\_\_\_ NUMBER OF QUARTS \_\_\_\_\_

1st 24 HOURS PRODUCTION		BARRELS OR FEET	
-------------------------	--	-----------------	--

2nd " " " " " "

3rd " " " " " "

4th " " "

---

[illegible]

## SAND AND CASING

[illegible]

REMARKS Abandoned.

**NOTE:—MAKE COPY TO KEEP FOR REFERENCE AND SEND ORIGINAL TO CHICAGO OFFICE. LIST MATERIAL CHARGEABLE TO WELL ON OTHER SIDE.**

SIGNED \_\_\_\_\_ SUPT. OR FOREMAN



**SUPT. OR FOREMAN**

DESCRIPTION	QUANTITY	MAKE	SIZE	MATERIAL
-------------	----------	------	------	----------

LIST OF MATERIAL CHARGEABLE TO WELL NO.

Sec. 15, Matten Top, Clare County, Michigan  
OUR CLARE #

OPERATOR: J.C. ARTHURS  
Well started 11-2-29  
Completed 3-13-32

CASING  
14" 607'  
8 1/2" 1072  
6-5/8" 1434

FROM	TO	FORMATION
0'	105'	Sand & gravel
105	142	Sand
142	205	Gravel
205	235	Sand
235	325	Sand & gravel
325	375	Gravel
375	395	Sand
395	440	Red Rock
440	475	Red mud
475	515	Red mud & gravel
515	568	Red sand
568	598	Blue mud
598	625	Blue mud
625	650	Blue shale
650	725	Gray shale
725	765	Broken lime
765	800	Blue shale
800	900	Black shale
900	960	Sandy shale
960	985	Lime hard
985	1000	Lime gray
1000	1026	Blue shale
1026	1150	Gray shale
1150	1160	Lime gray
1160	1190	Gray shale
1190	1235	Gray lime
1235	1245	Water sand
1245	1250	Lime, Gyp shell
1250	1260	Blue shale
1260	1430	Shells & shale
1430	1475	Hard lime
1475	1485	Black slate
1485	1500	Broken lime
1500	1505	Gray hard lime
1505	1520	Broken lime
1520	1532	Black slate
1532	1560	Lime & White hard gyp
1560	1575	Black slate
1575	1580	Lime shell hard
1580	1602	Marshall
1602	1630	Blue shale
1630	1700	Gray lime
1700	1735	Red Sand
1735	1750	Red Rock shale
1750	1780	Gray sand sharp
1780	1815	Blue shale
1815	1840	Brown sandy shale
1840	2780	Gray shale
2780	2820	Black shale
2820	3404	Brown shale
3404	3880	Traverse line



DESCRIPTION	QUANTITY	MAKE	SIZE	MATERIAL
-------------	----------	------	------	----------

3860	3950	Blue shale
3950	3975	Line shell
3975	4000	Shell & slate
4000	4017	Shale
4017	4019	Line shells
4019	4072	Shale
	4072	Top Dundee
4072	4089	White lime
4089	4092	Black lime
	4092	Hole full water
	4092	Total Depth