



Western Michigan University  
ScholarWorks at WMU

---

Legacy Scout Tickets from Pure Oil Company

---

8-20-2021

**MGRRE\_PureOilScoutTickets\_Frackelton\_1\_21035017370000**

MGRRE

*Western Michigan University*

Follow this and additional works at: <https://scholarworks.wmich.edu/pure>



Part of the Geology Commons

---

#### **WMU ScholarWorks Citation**

MGRRE, "MGRRE\_PureOilScoutTickets\_Frackelton\_1\_21035017370000" (2021). *Legacy Scout Tickets from Pure Oil Company*. 1054.

<https://scholarworks.wmich.edu/pure/1054>

This Document is brought to you for free and open access via ScholarWorks at WMU. It has been accepted for inclusion in Legacy Scout Tickets from Pure Oil Company by an authorized administrator of ScholarWorks at WMU. See the National Digital Catalogue - Science Base Catalogue for more collections submitted by MGRRE.



---

## MGRRE\_PureOilScoutTickets\_Frackelton\_1\_21035017370000

API 21035017370000

Permit Number 1737

Lease Name Frackelton

Well Number 1

County Clare

Township 18N

Range 05W

Section 18

2021 DEQ or Pure co\_name McClanahan Oil Company

Pure Number 26

Latitude 43.9448

Longitude -84.95036

THE PURE OIL COMPANY  
LOCATION REPORT

No. 26

DATE September 22, 1933

STATE Michigan COUNTY Clare DIST. Lincoln TWP. Lincoln SEC. 18 TOWN 18 N. RANGE 5 W.  
WELL No. 1 (SERIAL No. 26) FARM David W. Frackelton ACRES

NAME OF STREAM OR WATERS QUADRANGLE SE-SE-SE  
OPERATOR McClanahan Oil Company MAP Lincoln Township, Clare County

Feet from North Line of Farm  
330 " " East " " "  
330 " " South " " "  
" " West " " "  
Feet from North Line of Section  
330 " " East " " "  
330 " " South " " "  
" " West " " "

- LEGEND**
- O LOCATION
  - ① RIG
  - ⊕ DRILLING
  - ⊗ GAS WELL
  - OIL WELL
  - ⬮ SMALL OIL WELL
  - ⬮ DRY HOLE
  - ⬮ DRY SHOWING OIL
  - ⬮ DRY SHOWING GAS
  - ⬮ ABANDONED LOCATION
  - ⬮ ABANDONED GAS WELL
  - ⬮ ABANDONED OIL WELL

NOTE: Below make tracing from map, (when no map is obtainable make sketch) showing farm, center of section, this location with measurements and also wells, dry holes, or other locations in the vicinity of this location. Make copy to keep for reference and send original to Columbus office.

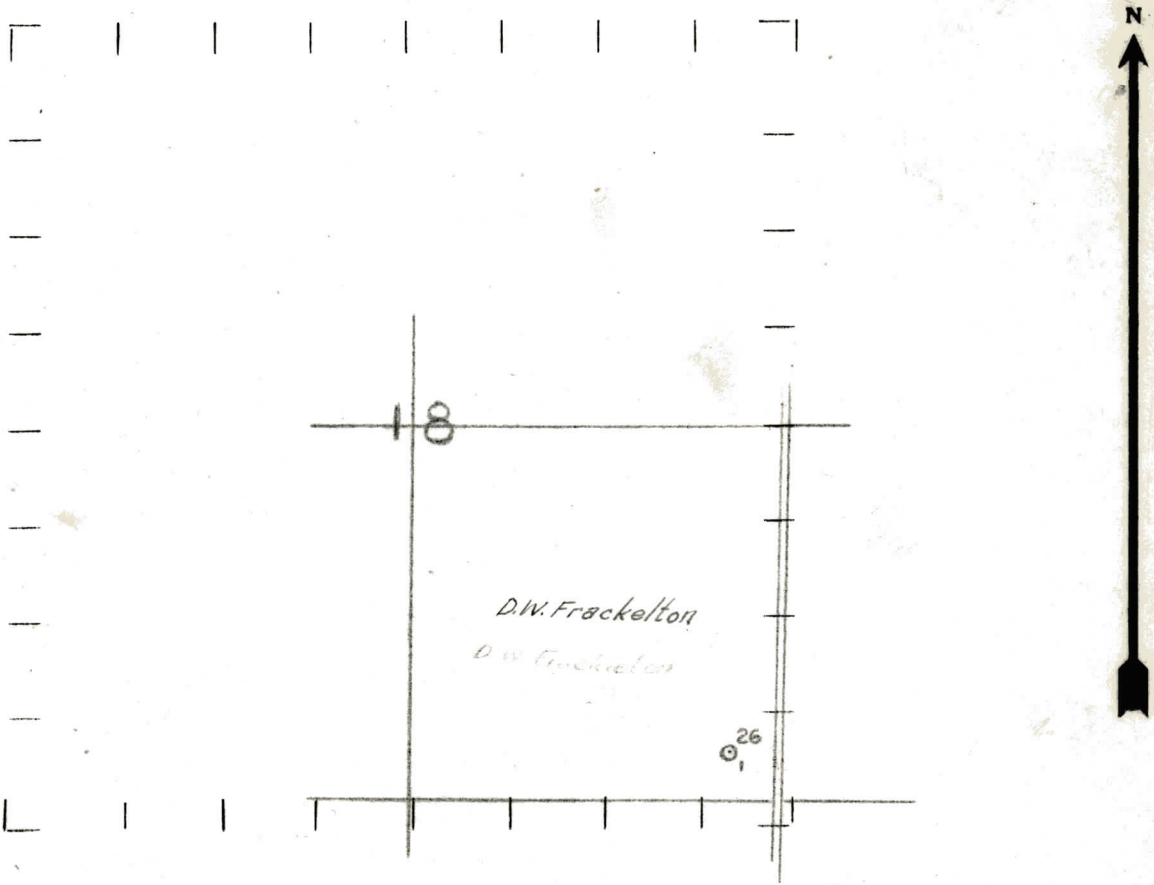

REMARKS:

SIGNED

Superintendent or Foreman.



**THE PURE OIL COMPANY**

Michigan Producing DIVISION

DATE August 2, 1934

## COMPLETION RECORD

No. 26

STATE Michigan COUNTY Clare DIST. Lincoln TWP. 18 SEC. 18 TOWN 18N RANGE 5W

WELL No. 1 (SERIAL No. 26) FARM David W. Frackelton ACRES           

NAME OF STREAM OR WATERS \_\_\_\_\_ QUADRANGLE **SE-SE-SE**

OPERATOR McClanahan Oil Company MAP Lincoln Township, Clare County

LOCATION REPORT SENT IN (DATE) 9/22/33

WELL STARTED (DATE) 9/22/33 WELL COMPLETED (DATE) 7/31/34

© 1994 NVEA

UNIVERSITY OF ALABAMA

DRY HOLE

## ABANDONED WELL

**CROSS OUT THREE OF THE ABOVE**

Elevation 1100.9'

## WELL RECORD

DATE OF SHOT \_\_\_\_\_ NUMBER OF QUARTS \_\_\_\_\_

1st 24 HOURS PRODUCTION \_\_\_\_\_ DRY HOLE \_\_\_\_\_ BARRELS OR FEET

2nd " " " \_\_\_\_\_ " " "

3rd " " " \_\_\_\_\_ " " "

4th " " " \_\_\_\_\_ " " "

5th " " " \_\_\_\_\_ " " "

## SAND AND CASING

[illegible]

REMARKS Hole filled 3599' with black water from 3963-3968'

$$\begin{array}{r} 395.7 \\ 1101 \\ \hline 285 \end{array}$$
$$\begin{array}{r} 3957 \\ 1515 \\ \hline 2442 \end{array}$$

**NOTE:—MAKE COPY TO KEEP FOR REFERENCE AND SEND ORIGINAL TO CHICAGO OFFICE. LIST MATERIAL CHARGEABLE TO WELL ON OTHER SIDE.**

**SIGNED**

SUPT. OR FOREMAN