



Western Michigan University  
ScholarWorks at WMU

---

Legacy Scout Tickets from Pure Oil Company

---

8-20-2021

**MGRRE\_PureOilScoutTickets\_Doherty, Sara M et  
al\_1\_21035048240000**

MGRRE  
*Western Michigan University*

Follow this and additional works at: <https://scholarworks.wmich.edu/pure>



Part of the Geology Commons

---

#### WMU ScholarWorks Citation

MGRRE, "MGRRE\_PureOilScoutTickets\_Doherty, Sara M et al\_1\_21035048240000" (2021). *Legacy Scout Tickets from Pure Oil Company*. 1074.  
<https://scholarworks.wmich.edu/pure/1074>

This Document is brought to you for free and open access via ScholarWorks at WMU. It has been accepted for inclusion in Legacy Scout Tickets from Pure Oil Company by an authorized administrator of ScholarWorks at WMU. See the National Digital Catalogue - Science Base Catalogue for more collections submitted by MGRRE.



---

**MGRRE\_PureOilScoutTickets\_Doherty, Sara M et al\_1\_21035048240000**

API 21035048240000

Permit Number 4824

Lease Name Doherty, Sara M et al

Well Number 1

County Clare

Township 17N

Range 04W

Section 25

2021 DEQ or Pure co\_name Gulf Refining Company

Pure Number 48

Latitude 43.8303

Longitude -84.74714

The Pure Oil Company

THE PURE OIL COMPANY

COMPLETION RECORD OF WELLS DRILLED BY OTHER OPERATORS

DATE March 3, 1938

LOCATION REPORT

No. 48STATE Michigan

COUNTY

Clare

DIST.

Grant

TWP.

Grant

SEC.

25

TOWN.

17 N

RANGE

4 WWELL No. 1 (SERIAL No. 48) FARMSara M. Doherty, et al

ACRES

NAME OF STREAM OR WATERS

QUADRANGLE

SW-SW-SW  
SW SW SWOPERATOR Gulf Refining Company

Map

Grant Township, Clare CountyGulf Ref. Co.Grant - Clare

Feet from North Line of Farm

" " East " " "

330 330

" " South " " "

330 330

" " West " " "

Feet from North Line of Section

" " East " " "

330 330

" " South " " "

330 330

" " West " " "

## LEGEND

○ LOCATION

① RIG

⊕ DRILLING

☼ GAS WELL

● OIL WELL

⬮ SMALL OIL WELL

⊙ DRY HOLE

⬮ DRY SHOWING OIL

⊙ DRY SHOWING GAS

⊙ ABANDONED LOCATION

☼ ABANDONED GAS WELL

⬮ ABANDONED OIL WELL

NOTE: Below make tracing from map, (when no map is obtainable make sketch) showing farm, center of section, this location with measurements and also wells, dry holes, or other locations in the vicinity of this location.

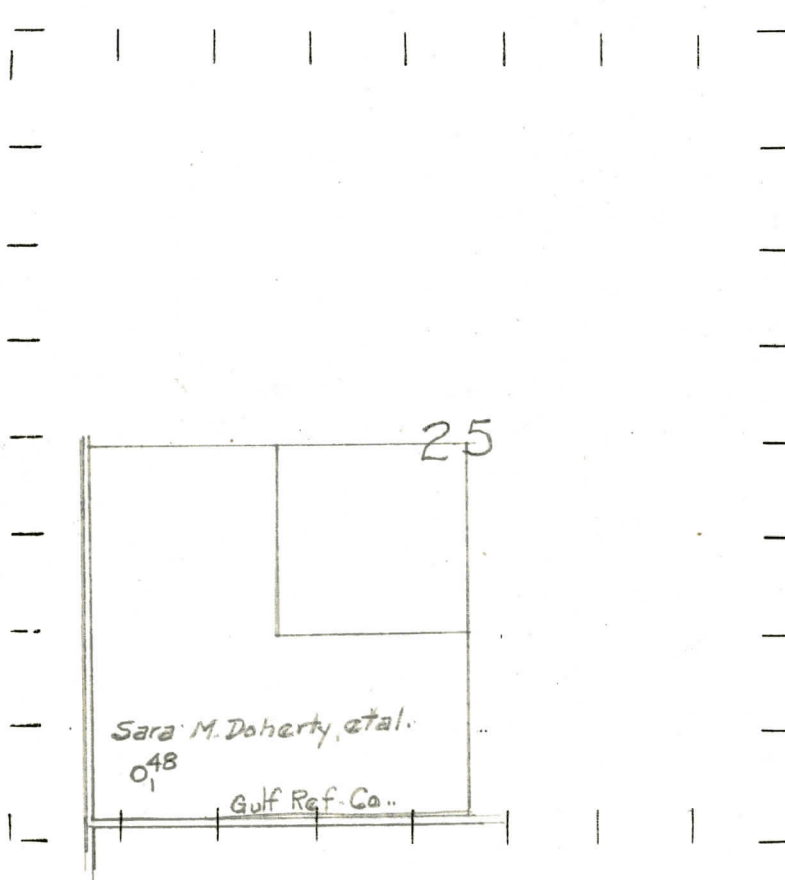

REMARKS:

SIGNED

R. L. Yeager

Superintendent or Foreman.



## Michigan Producing Division

Date **May 5, 1938**

No. 48

State ~~Michigan~~ County Clare

**DISC:**

Twp. Grant

Sec. 25

Twp. 17 N Rge. 4 W

(Serial No.)

Well No. 1 (Source No.) 48

Farm

Doherty, et al

Acres

Operator **Gulf Refining Company**

Information secured

By

Scouting Department

Date well started **5-6-33**

Date well completed

4-26-38

Elevation

833.6

## PRODUCTION RECORD

1st 24 hours natural **Dry Hole**

2nd 24 hours natural

[illegible][illegible]

shot

1st 24 hours after acid

shot

2nd 24 hours after acid

# FORMATION AND CASING RECORD

Formation	Top	Bottom	Top Pay	Bottom Pay	Remarks	Casing	
						Size	Set at
Stray Sand	1281	1305					
Marshall	1335					10"	440
Red Rock	1473	1535				6-5/8"	1615
Antrim	2495	C.T.M.				5-3/16"	3739
Traverse Form.	3065						
Traverse Lime	3065	S.L.M.					
Dundee	3737	"		3795	Small show water		
			3795	3865	Salt water-1000 ft.		
Total Depth		3865					

Remarks

Signed

D. C. Shackelford