



Western Michigan University
ScholarWorks at WMU

Legacy Scout Tickets from Pure Oil Company

8-20-2021

MGRRE_PureOilScoutTickets_Dawson et al_1_21035048540000

MGRRE

Western Michigan University

Follow this and additional works at: <https://scholarworks.wmich.edu/pure>



Part of the Geology Commons

WMU ScholarWorks Citation

MGRRE, "MGRRE_PureOilScoutTickets_Dawson et al_1_21035048540000" (2021). *Legacy Scout Tickets from Pure Oil Company*. 1079.

<https://scholarworks.wmich.edu/pure/1079>

This Document is brought to you for free and open access via ScholarWorks at WMU. It has been accepted for inclusion in Legacy Scout Tickets from Pure Oil Company by an authorized administrator of ScholarWorks at WMU. See the National Digital Catalogue - Science Base Catalogue for more collections submitted by MGRRE.



MGRRE_PureOilScoutTickets_Dawson et al_1_21035048540000

API 21035048540000

Permit Number 4854

Lease Name Dawson et al

Well Number 1

County Clare

Township 17N

Range 04W

Section 36

2021 DEQ or Pure co_name Michigan Consolidated Gas Company

Pure Number 53

Latitude 43.82941

Longitude -84.72846

The Pure Oil Company
THE PURE OIL COMPANY

COMPLETION RECORD OF WELLS DRILLED BY OTHER OPERATORS

DATE March 10, 1938

LOCATION REPORT

No. 53

STATE Michigan COUNTY Clare DIST. Sheridan SEC. 30 TOWN 17 N RANGE 3 W
 WELL No. 1 (SERIAL No. 53) FARM S. A. Dawson, et al. ACRES

NAME OF STREAM OR WATERS QUADRANGLE SW-SW-SW
SW SW SW

OPERATOR American Production Company Map Sheridan Township, Clare County
Amer. Prod. Co. Sheridan - Clare

Feet from North Line of Farm

1300 1300

" " East " " "

1340 1340

" " South " " "

" " West " " "

Feet from North Line of Section

20 20

" " East " " "

20 20

" " South " " "

" " West " " "

LEGEND

○ LOCATION

① RIG

⊕ DRILLING

☼ GAS WELL

● OIL WELL

⬮ SMALL OIL WELL

⊙ DRY HOLE

⬮ DRY SHOWING OIL

⊙ DRY SHOWING GAS

⊙ ABANDONED LOCATION

☼ ABANDONED GAS WELL

⬮ ABANDONED OIL WELL

NOTE: Below make tracing from map, (when no map is obtainable make sketch) showing farm, center of section, this location with measurements and also wells, dry holes, or other locations in the vicinity of this location.

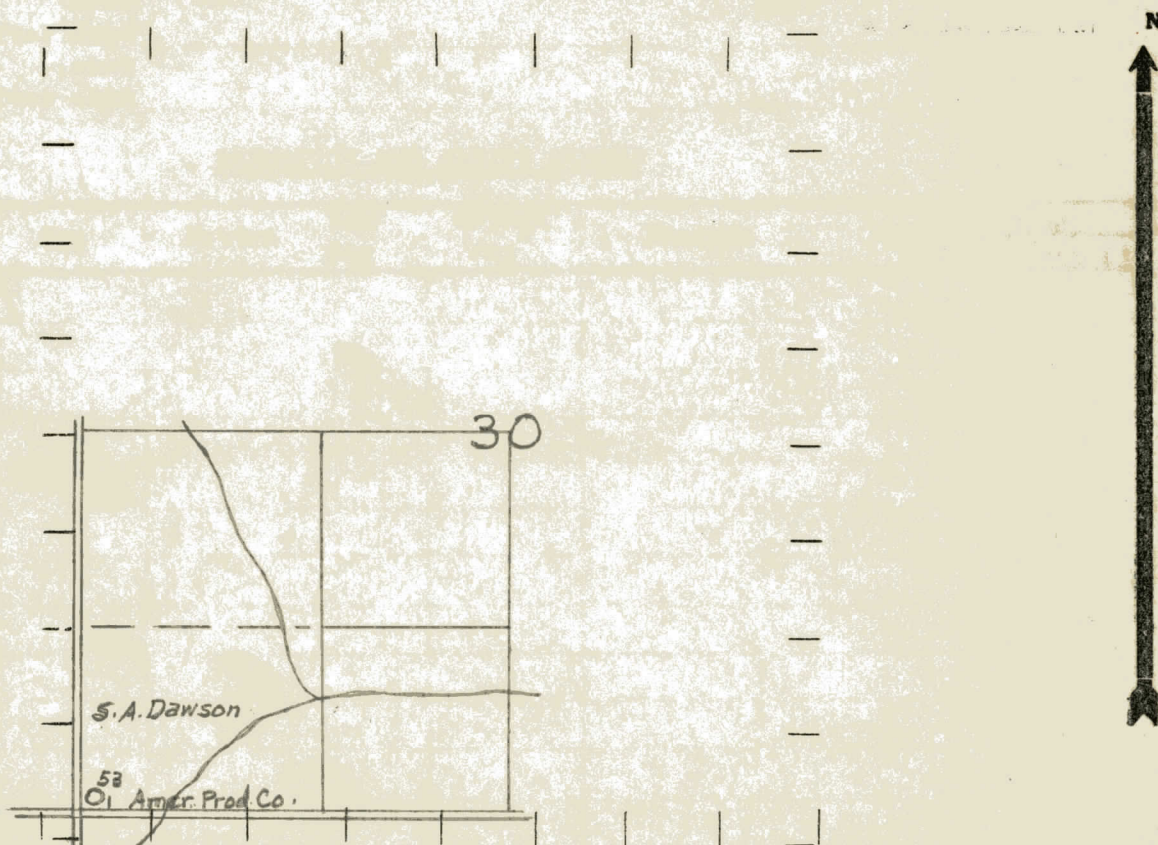

REMARKS:

SIGNED

Superintendent or Foreman.

Signed **D. C. Shackelford**