



Western Michigan University
ScholarWorks at WMU

Legacy Scout Tickets from Pure Oil Company

8-20-2021

MGRRE_PureOilScoutTickets_Breshahan, William V. et
al_1_21035048540000

MGRRE
Western Michigan University

Follow this and additional works at: <https://scholarworks.wmich.edu/pure>



Part of the Geology Commons

WMU ScholarWorks Citation

MGRRE, "MGRRE_PureOilScoutTickets_Breshahan, William V. et al_1_21035048540000" (2021). *Legacy Scout Tickets from Pure Oil Company*. 1084.
<https://scholarworks.wmich.edu/pure/1084>

This Document is brought to you for free and open access via ScholarWorks at WMU. It has been accepted for inclusion in Legacy Scout Tickets from Pure Oil Company by an authorized administrator of ScholarWorks at WMU. See the National Digital Catalogue - Science Base Catalogue for more collections submitted by MGRRE.



MGRRE_PureOilScoutTickets_Breshahan, William V. et al_1_21035048540000

API 21035048540000

Permit Number 4854

Lease Name Breshahan, William V. et al

Well Number 1

County Clare

Township 17N

Range 04W

Section 36

2021 DEQ or Pure co_name Michigan Consolidated Gas Company

Pure Number 60

Latitude 43.82941

Longitude -84.72846

COMPLETION RECORD OF THE PURE OIL COMPANY BY OTHER OPERATORS

DATE May 12, 1938

LOCATION REPORT

No. 60STATE Michigan

COUNTY

ClareDIST. GrantTWP. GrantSEC. 36TOWN 17 NRANGE 4 WWELL No. 1 (SERIAL No. 60) FARMWm. V. Bresnahan, et al.

ACRES

NAME OF STREAM OR WATERS

QUADRANGLE

NE-NE-NE
NE NE NEOPERATOR American Production Company

Map

Grant Township, Clare County20 20 Feet from North Line of Farm20 20 " " East " " "

" " South " " "

" " West " " "

Feet from North Line of Section

" " East " " "

2620 2620 " " South " 1/4 "2620 2620 " " West " 1/4 "

O LOCATION

① RIG

⊕ DRILLING

☼ GAS WELL

● OIL WELL

⬮ SMALL OIL WELL

LEGEND

⊖ DRY HOLE

⬮ DRY SHOWING OIL

☼ DRY SHOWING GAS

⊖ ABANDONED LOCATION

☼ ABANDONED GAS WELL

⬮ ABANDONED OIL WELL

NOTE: Below make tracing from map, (when no map is obtainable make sketch) showing farm, center of section, this location with measurements and also wells, dry holes, or other locations in the vicinity of this location.

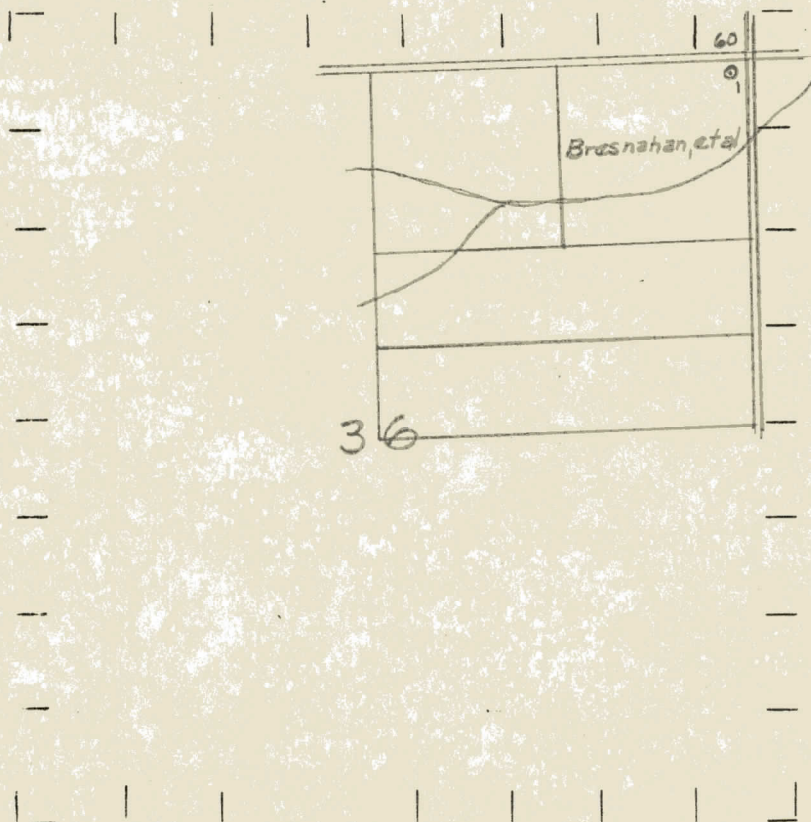

REMARKS:

SIGNED

Superintendent or Foreman.

Signed **D. C. Shackelford**