



Western Michigan University
ScholarWorks at WMU

Legacy Scout Tickets from Pure Oil Company

8-20-2021

MGRRE_PureOilScoutTickets_Van Horn, A E_4_21035054450000

MGRRE

Western Michigan University

Follow this and additional works at: <https://scholarworks.wmich.edu/pure>



Part of the Geology Commons

WMU ScholarWorks Citation

MGRRE, "MGRRE_PureOilScoutTickets_Van Horn, A E_4_21035054450000" (2021). *Legacy Scout Tickets from Pure Oil Company*. 1120.

<https://scholarworks.wmich.edu/pure/1120>

This Document is brought to you for free and open access via ScholarWorks at WMU. It has been accepted for inclusion in Legacy Scout Tickets from Pure Oil Company by an authorized administrator of ScholarWorks at WMU. See the National Digital Catalogue - Science Base Catalogue for more collections submitted by MGRRE.



MGRRE_PureOilScoutTickets_Van Horn, A E_4_21035054450000

API 21035054450000

Permit Number 5445

Lease Name Van Horn, A E

Well Number 4

County Clare

Township 18N

Range 06W

Section 3

2021 DEQ or Pure co_name Trahan Petroleum, Incorporated

Pure Number 106

Latitude 43.9812561

Longitude -85.0195317

THE PURE OIL COMPANY

LOCATION REPORT

DATE October 10, 1938

No. 106

STATE Michigan

COUNTY Clare

Clare

DIST. Freeman

TWP. Freeman

SEC. 3

TOWN 18 N

18 N

RANGE 6 W

6 W

WELL No. 44 (SERIAL No. 106) FARM

BBBC A. E. Van Horn

ACRES

NAME OF STREAM OR WATERS

QUADRANGLE

SE-SE-NW
SE SE NW

OPERATOR Gulf Refining Company

Map Freeman Township, Clare County

Gulf Ref Co.

Freeman - Clare

Feet from North Line of Farm

330 830

" " East " " "

330 330

" " South " " "

" " West " " "

Feet from North Line of Section

330 330

" " East 1/4 1/4 "

330 330

" " South 1/4 1/4 "

" " West " " "

LEGEND

○ LOCATION

⊙ RIG

⊕ DRILLING

☀ GAS WELL

● OIL WELL

⦿ SMALL OIL WELL

⊖ DRY HOLE

⦿ DRY SHOWING OIL

⊖ DRY SHOWING GAS

⊖ ABANDONED LOCATION

☀ ABANDONED GAS WELL

⦿ ABANDONED OIL WELL

NOTE: Below make tracing from map, (when no map is obtainable make sketch) showing farm, center of section, this location with measurements and also wells, dry holes, or other locations in the vicinity of this location.

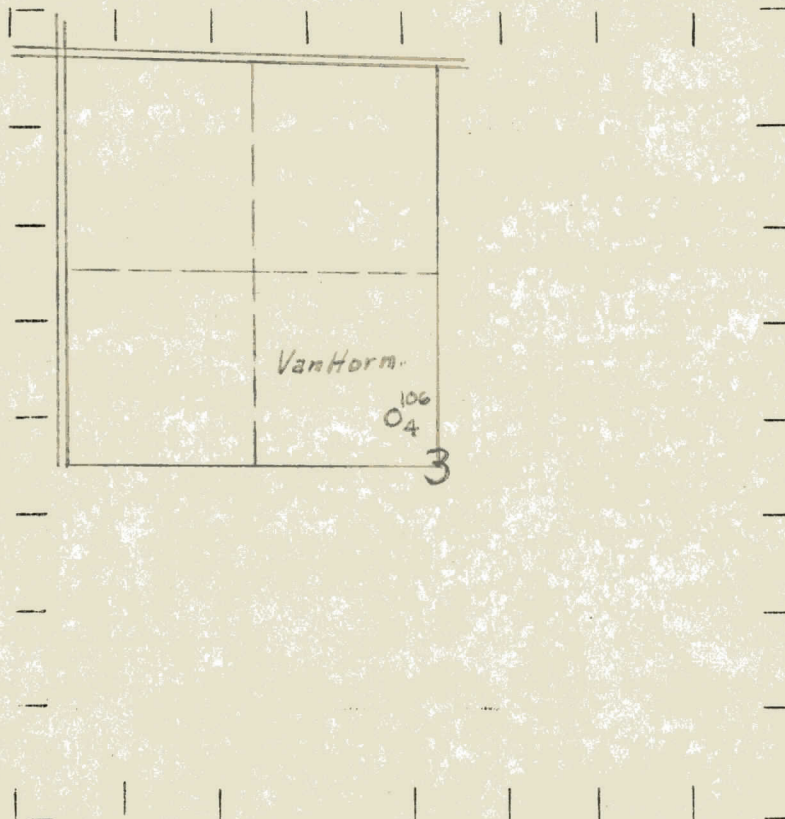

REMARKS:

SIGNED

R. A. J.

Superintendent or Foreman.

COMPLETION RECORD OF WELLS DRILLED BY OTHER OPERATORS

Michigan Producing Division

Date **November 10, 1938** No. **108**
 State **Mich.** County **Clare** Twp. **Freeman** Sec. **3** Twp. **13 N** Rge. **6 W**
 Well No. **4** (Serial No.) **108** Farm **A. E. Van Horn** Acres
 Operator **Gulf Refining Company** Information secured ~~From~~ ^{By} **Scouting Department**
 Date well started **10-3-38** Date well completed **11-3-38** Elevation **1070.7**

PRODUCTION RECORD

1st 24 hours natural **767 Barrels**
 2nd 24 hours natural
 Date of shot No. of quarts From to From to
 Date of acid **11-5-38** No. of gallons **300**
 1st 24 hours after acid **shot** **Est. 3600 Barrels**
 2nd 24 hours after acid

FORMATION AND CASING RECORD

Formation	Top	Bottom	Top Pay	Bottom Pay	Remarks	Casing	
						Size	Set at
Stray	1482					6-5/8"	1744
Marshall	1540					5-3/16"	3880
Red Rock		1716				14"	60
Antrim	2573						
Traverse Lime	3247	C.T.M.	3883	3883 1/2			
Monroe	3679	SLM					
Total Depth		3883 1/2					

Remarks

Signed **D. C. Shackelford**