



Western Michigan University  
ScholarWorks at WMU

---

Legacy Scout Tickets from Pure Oil Company

---

8-20-2021

**MGRRE\_PureOilScoutTickets\_Fell, L. G.\_4\_21035055330000**

MGRRE

*Western Michigan University*

Follow this and additional works at: <https://scholarworks.wmich.edu/pure>



Part of the Geology Commons

---

#### WMU ScholarWorks Citation

MGRRE, "MGRRE\_PureOilScoutTickets\_Fell, L. G.\_4\_21035055330000" (2021). *Legacy Scout Tickets from Pure Oil Company*. 1132.

<https://scholarworks.wmich.edu/pure/1132>

This Document is brought to you for free and open access via ScholarWorks at WMU. It has been accepted for inclusion in Legacy Scout Tickets from Pure Oil Company by an authorized administrator of ScholarWorks at WMU. See the National Digital Catalogue - Science Base Catalogue for more collections submitted by MGRRE.



---

MGRRE\_PureOilScoutTickets\_Fell, L. G.\_4\_21035055330000

API 21035055330000

Permit Number 5533

Lease Name Fell, L. G.

Well Number 4

County Clare

Township 19N

Range 06W

Section 33

2021 DEQ or Pure co\_name Socony Mobil Oil Company, Incorporated

Pure Number 123

Latitude 43.98861

Longitude -85.03209

THE PURE OIL COMPANY

DATE February 15, 1940

LOCATION REPORT

No. 123

STATE Michigan COUNTY Clare DIST. Redding SEC. 33 TOWN 19 N RANGE 6 W

WELL No. 47 (SERIAL No. 123) FARM Fell ACRES

NAME OF STREAM OR WATERS QUADRANGLE SW SE SE

OPERATOR Socony-Vacuum Oil Company, Inc. Map Redding Township, Clare County

Socony-Vacuum Oil Co

Redding - Clare

Feet from North Line of Farm

" " East " " "

" " South " " "

" " West " " "

Feet from North Line of Section

" " East " " "

" " South " " "

" " West " " "

LEGEND

○ LOCATION

① RIG

⊕ DRILLING

⊗ GAS WELL

● OIL WELL

⦿ SMALL OIL WELL

⊖ DRY HOLE

⦿ DRY SHOWING OIL

⊖ DRY SHOWING GAS

⊖ ABANDONED LOCATION

⦿ ABANDONED GAS WELL

⦿ ABANDONED OIL WELL

NOTE: Below make tracing from map, (when no map is obtainable make sketch) showing farm, center of section, this location with measurements and also wells, dry holes, or other locations in the vicinity of this location.

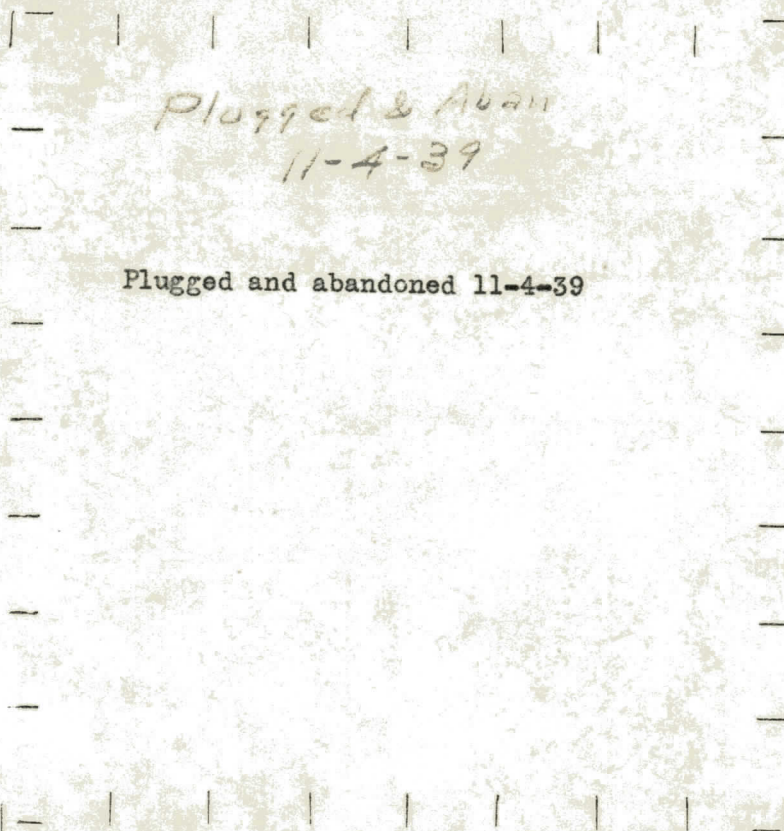

REMARKS:

SIGNED

Superintendent or Foreman.



Feet from North Line of Farm

99990

" " East " " "

3330

" " South " " "

" " West " " "

Feet from North Line of Section

99990

" " East " " "

3330

" " South " " "

" " West " " "

LEGEND

○ LOCATION

① RIG

⊕ DRILLING

☼ GAS WELL

● OIL WELL

⬮ SMALL OIL WELL

⊙ DRY HOLE

⬮ DRY SHOWING OIL

⊙ DRY SHOWING GAS

⬮ ABANDONED LOCATION

☼ ABANDONED GAS WELL

⬮ ABANDONED OIL WELL

NOTE: Below make tracing from map, (when no map is obtainable make sketch) showing farm, center of section, this location with measurements and also wells, dry holes, or other locations in the vicinity of this location.

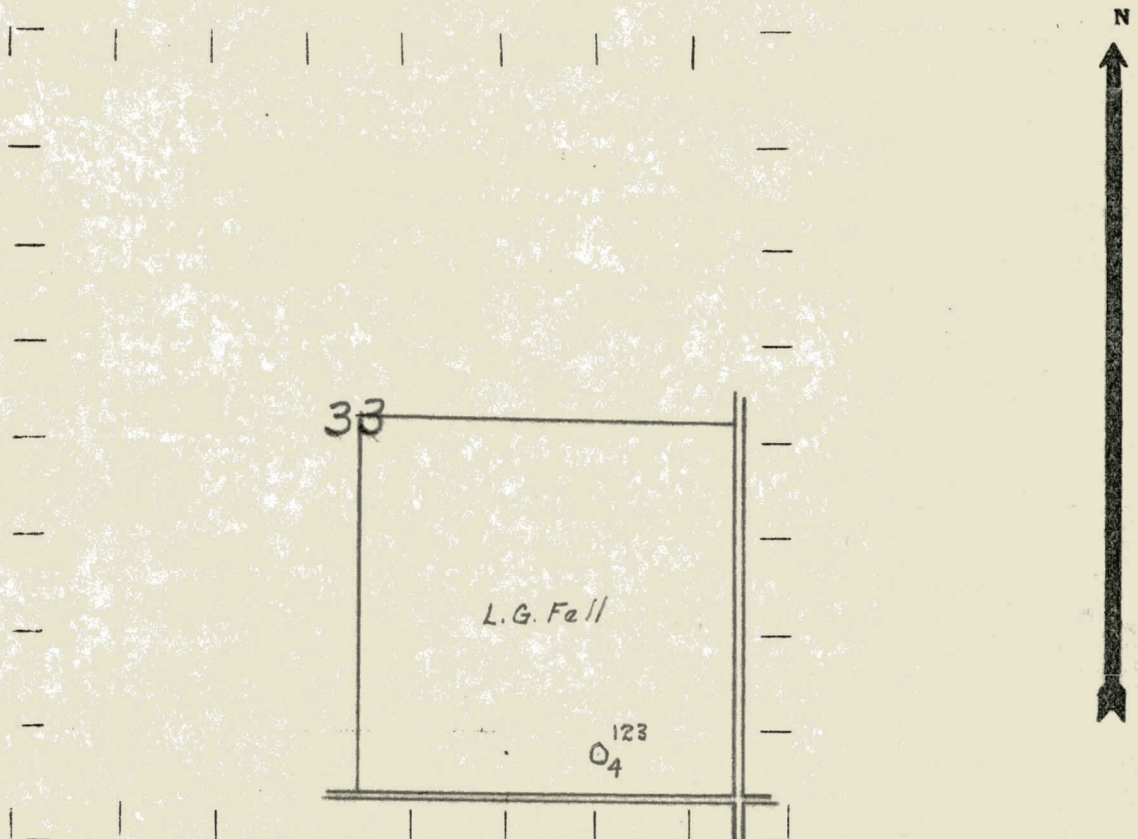

REMARKS:

SIGNED

R. L. J.

Superintendent or Foreman.

Signed D. C. Shackelford