



Western Michigan University  
ScholarWorks at WMU

---

Legacy Scout Tickets from Pure Oil Company

---

8-20-2021

**MGRRE\_PureOilScoutTickets\_Frackelton\_1\_21035055420000**

MGRRE

*Western Michigan University*

Follow this and additional works at: <https://scholarworks.wmich.edu/pure>



Part of the Geology Commons

---

#### **WMU ScholarWorks Citation**

MGRRE, "MGRRE\_PureOilScoutTickets\_Frackelton\_1\_21035055420000" (2021). *Legacy Scout Tickets from Pure Oil Company*. 1135.

<https://scholarworks.wmich.edu/pure/1135>

This Document is brought to you for free and open access via ScholarWorks at WMU. It has been accepted for inclusion in Legacy Scout Tickets from Pure Oil Company by an authorized administrator of ScholarWorks at WMU. See the National Digital Catalogue - Science Base Catalogue for more collections submitted by MGRRE.



---

**MGRRE\_PureOilScoutTickets\_Frackelton\_1\_21035055420000**

API 21035055420000

Permit Number 5542

Lease Name Frackelton

Well Number 1

County Clare

Township 18N

Range 05W

Section 18

2021 DEQ or Pure co\_name Mid Michigan Gas Storage Company

Pure Number 126

Latitude 43.957354

Longitude -84.9501791

The Pure Oil Company  
THE PURE OIL COMPANY  
WELLS OF OTHER OPERATORS

DATE October 31, 1938

LOCATION REPORT

No. 126

STATE Michigan COUNTY Clare DISTRICT Lincoln TWP. Lincoln SEC. 18 TOWN 18 N RANGE 5 W

WELL No. 1 (SERIAL No. 126) FARM David W. Frackelton ACRES

NAME OF STREAM OR WATERS \_\_\_\_\_ QUADRANGLE NE-NE-NE

OPERATOR D. E. Hughes & Art Hansen Map Lincoln Township, Clare County  
D.E. Hughes & Art Hansen Lincoln - Clare

33030 Feet from North Line of Farm

33350 " " East " " "

" " South " " "

" " West " " "

33430 Feet from North Line of Section

33030 " " East " " "

" " South " " "

" " West " " "

LEGEND

○ LOCATION

⊙ RIG

⊕ DRILLING

☼ GAS WELL

● OIL WELL

⦿ SMALL OIL WELL

⊖ DRY HOLE

⦿ DRY SHOWING OIL

☼ DRY SHOWING GAS

⊖ ABANDONED LOCATION

☼ ABANDONED GAS WELL

⦿ ABANDONED OIL WELL

NOTE: Below make tracing from map, (when no map is obtainable make sketch) showing farm, center of section, this location with measurements and also wells, dry holes, or other locations in the vicinity of this location.

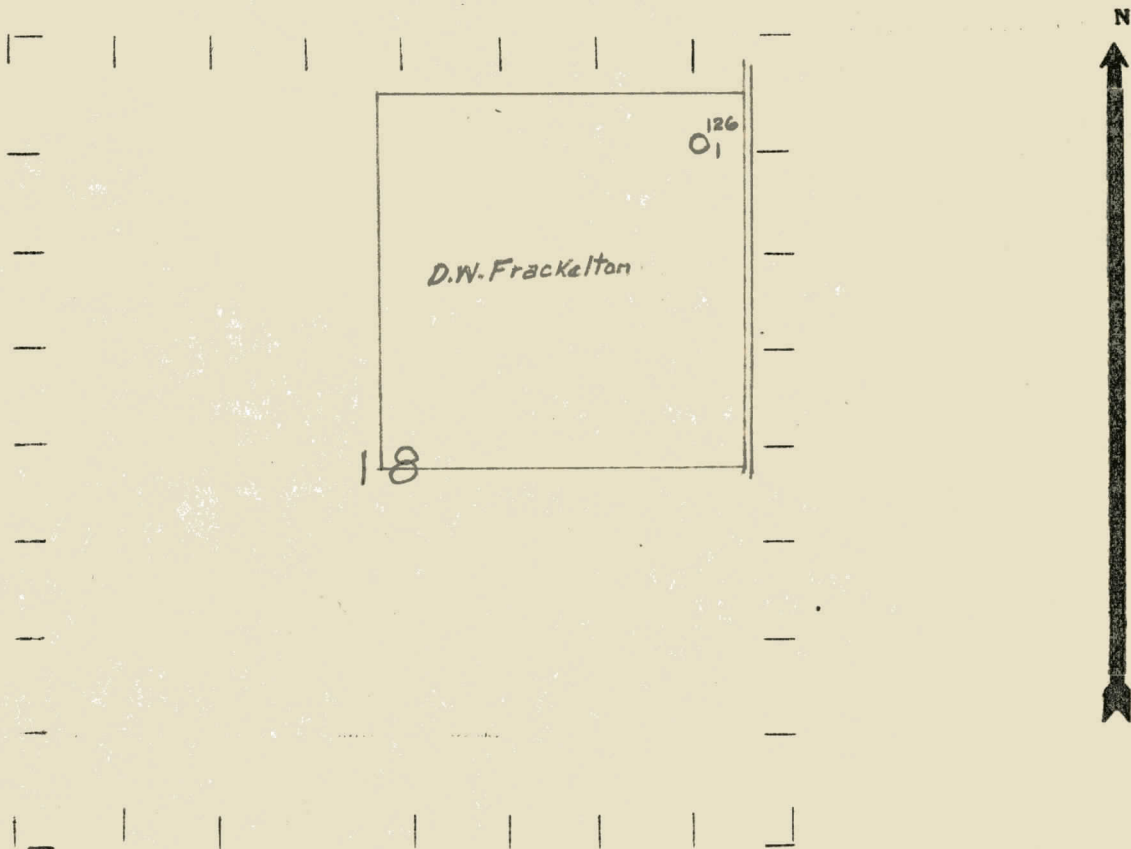

REMARKS:

SIGNED

*R. L. J.*

Superintendent or Foreman

Michigan Producing Division

Date **February 2, 1939** No. **126**  
 State **Michigan** County **Clare** Dist. **Lincoln** Twp. **18** Sec. **18** Twp. **18 N** Rge. **5 W**  
 Well No. **1** (Serial No.) **126** Farm **D. W. Prackelton** Acres \_\_\_\_\_  
 Operator **Hughes & Hansen** Information secured ~~from~~ **Scouting Department** By \_\_\_\_\_  
 Date well started **10-30-38** Date well completed **1-29-39** Elevation **1119.0**

PRODUCTION RECORD

1st 24 hours natural **Dry Hole**  
 2nd 24 hours natural \_\_\_\_\_  
 Date of shot \_\_\_\_\_ No. of quarts \_\_\_\_\_ From \_\_\_\_\_ to \_\_\_\_\_ From \_\_\_\_\_ to \_\_\_\_\_  
 Date of acid \_\_\_\_\_ No. of gallons \_\_\_\_\_  
 1st 24 hours after acid shot \_\_\_\_\_  
 2nd 24 hours after acid shot \_\_\_\_\_

FORMATION AND CASING RECORD

Formation	Top	Bottom	Top Pay	Bottom Pay	Remarks	Casing	
						Size	Set at
Stray	1604					10"	550
Marshall	1695					6-5/8"	1600
Red Rock	1721	1750				5-3/16"	3066 1/2
Antrim	2663	S.L.M.					
Traverse	3316	"					
Dundee	3963	"		3966 1/2	Show oil		
			3966 1/2	3972	Salt water		
Total Depth		3991					

Remarks **2691' C.T.M. equals 2675' S.L.M.; 3373' S.L.M. equals 3365' C.T.M.; 3961' C.T.M. equals 3966' S.L.M.**