



Western Michigan University
ScholarWorks at WMU

Legacy Scout Tickets from Pure Oil Company

8-20-2021

**MGRRE_PureOilScoutTickets_Bicknell, James
S_1_21035055970000**

MGRRE
Western Michigan University

Follow this and additional works at: <https://scholarworks.wmich.edu/pure>



Part of the Geology Commons

WMU ScholarWorks Citation

MGRRE, "MGRRE_PureOilScoutTickets_Bicknell, James S_1_21035055970000" (2021). *Legacy Scout Tickets from Pure Oil Company*. 1140.
<https://scholarworks.wmich.edu/pure/1140>

This Document is brought to you for free and open access via ScholarWorks at WMU. It has been accepted for inclusion in Legacy Scout Tickets from Pure Oil Company by an authorized administrator of ScholarWorks at WMU. See the National Digital Catalogue - Science Base Catalogue for more collections submitted by MGRRE.



MGRRE_PureOilScoutTickets_Bicknell, James S_1_21035055970000

API 21035055970000

Permit Number 5597

Lease Name Bicknell, James S

Well Number 1

County Clare

Township 18N

Range 05W

Section 8

2021 DEQ or Pure co_name Taggart Brothers Company

Pure Number 136

Latitude 43.96197

Longitude -84.93398

THE PURE OIL COMPANY
CORPORATION RECORD OF WELLS DRILLED BY OTHER OPERATORS

DATE November 17, 1938

LOCATION REPORT

No. 136

STATE Mich. COUNTY Clare DIST. Lincoln SEC. 8 TOWN 18 N RANGE 5 W

WELL No. 1 (SERIAL No. 136) FARM James S. Bicknell ACRES

NAME OF STREAM OR WATERS QUADRANGLE CSE

OPERATOR Taggart Brothers, Inc. Map Lincoln Township, Clare County

131320 Taggart Bros. Inc.
Feet from North Line of Farm

" " East " " "

" " South " " "

131320 " " West " " "

Feet from North Line of Section

131320 " " East " " "

131320 " " South " " "

" " West " " "

3 - ratings

LEGEND

○ LOCATION

① RIG

⊕ DRILLING

⊗ GAS WELL

● OIL WELL

⦿ SMALL OIL WELL

⊖ DRY HOLE

⦿ DRY SHOWING OIL

⦿ DRY SHOWING GAS

⦿ ABANDONED LOCATION

⦿ ABANDONED GAS WELL

⦿ ABANDONED OIL WELL

NOTE: Below make tracing from map, (when no map is obtainable make sketch) showing farm, center of section, this location with measurements and also wells, dry holes, or other locations in the vicinity of this location.

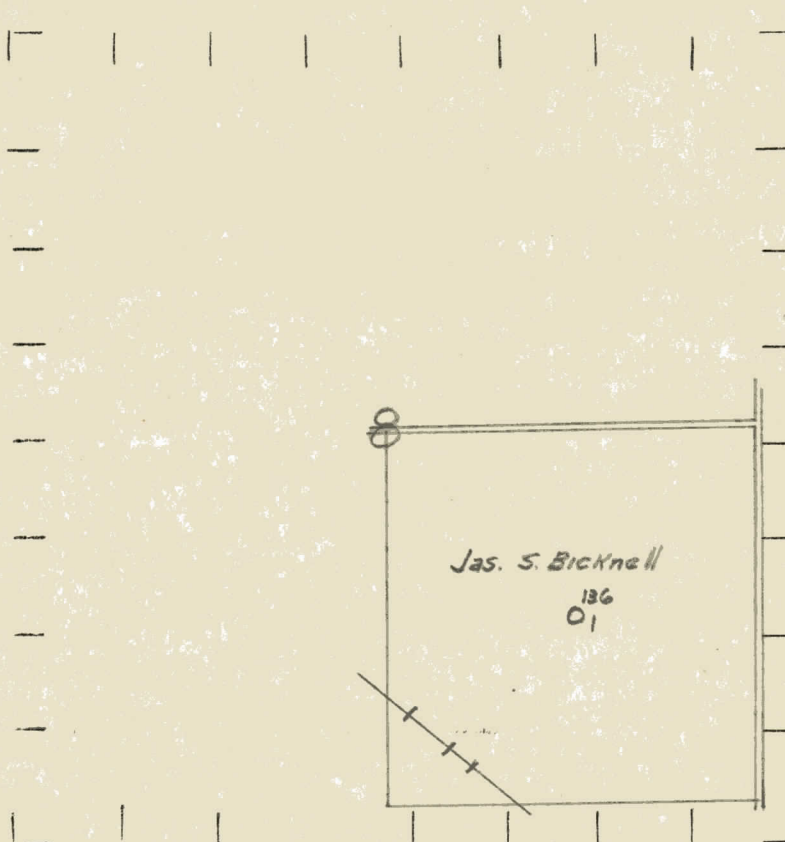

REMARKS:

SIGNED

R. L. [Signature]

Superintendent or Foreman

D. C. Shackelford