



Western Michigan University  
ScholarWorks at WMU

---

Legacy Scout Tickets from Pure Oil Company

---

8-20-2021

**MGRRE\_PureOilScoutTickets\_Fell, L. G.\_B-2\_21035058830000**

MGRRE

*Western Michigan University*

Follow this and additional works at: <https://scholarworks.wmich.edu/pure>



Part of the Geology Commons

---

#### **WMU ScholarWorks Citation**

MGRRE, "MGRRE\_PureOilScoutTickets\_Fell, L. G.\_B-2\_21035058830000" (2021). *Legacy Scout Tickets from Pure Oil Company*. 1162.

<https://scholarworks.wmich.edu/pure/1162>

This Document is brought to you for free and open access via ScholarWorks at WMU. It has been accepted for inclusion in Legacy Scout Tickets from Pure Oil Company by an authorized administrator of ScholarWorks at WMU. See the National Digital Catalogue - Science Base Catalogue for more collections submitted by MGRRE.



---

**MGRRE\_PureOilScoutTickets\_Fell, L. G.\_B-2\_21035058830000**

API 21035058830000

Permit Number 5883

Lease Name Fell, L. G.

Well Number B-2

County Clare

Township 19N

Range 06W

Section 33

2021 DEQ or Pure co\_name Socony Mobil Oil Company, Incorporated

Pure Number 171

Latitude 43.99842

Longitude -85.03474

## WELL REPORT - OUTSIDE OPERATIONS

SERIAL NO. 171STATE Michigan ~~P.M.~~ CO. ClareOPERATOR Socony-Vacuum Oil Co., Inc.FARM L.G. Fell "B" WELL NO. 2TWP. Redding S. 33 T. 19N R. 6WLOC. C E $\frac{1}{2}$  W $\frac{1}{2}$  NEWILDCAT ☐ FIELD ☒ FIELD NAME Freeman - Redding

MAP NO. \_\_\_\_\_ CO-ORD. \_\_\_\_\_ ELEV. \_\_\_\_\_

STATUS Plugged & abandoned - February 26, 1953Total Depth - 3898

NORTH

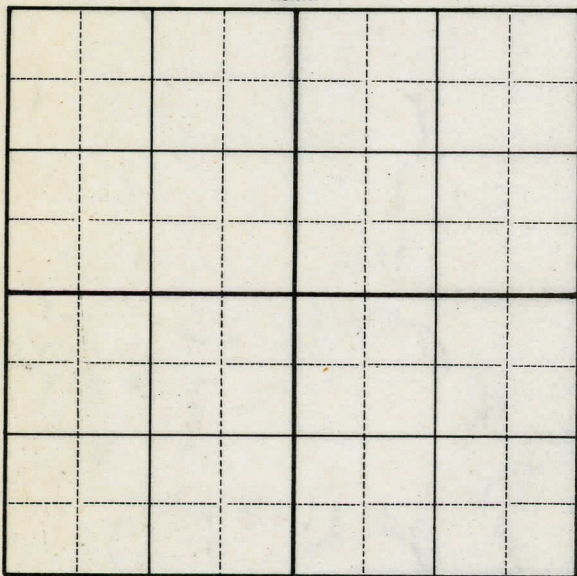
DATE 4-1-53 SCOUT JEC

DATE March 9, 1939 Corrected LOCATION REPORT No. 171  
 STATE Michigan COUNTY Clare DIST. Redding SEC. 33 TOWN 19 N RANGE 6 W  
 WELL No. 22 (SERIAL No. 171) FARM L. G. Fell "B" ACRES

NAME OF STREAM OR WATERS \_\_\_\_\_ QUADRANGLE Clare, W. & N.E.

OPERATOR Socony-Vacuum Oil Company, Inc. Map Redding Township, Clare County

1320 1320 Socony Vacuum Oil Co.  
 Feet from North Line of Farm

330 330 " " East " " "

" " South " " "

" " West " " "

1320 1320 Feet from North Line of Section

" " East " " "

" " South " " "

990 990 " " West " 1 1/4 "

- LEGEND**
- LOCATION
  - ① RIG
  - ⊕ DRILLING
  - ☀ GAS WELL
  - OIL WELL
  - ⦿ SMALL OIL WELL
  - ⊙ DRY HOLE
  - ⦿ DRY SHOWING OIL
  - ⊙ DRY SHOWING GAS
  - ⊙ ABANDONED LOCATION
  - ☀ ABANDONED GAS WELL
  - ⦿ ABANDONED OIL WELL

NOTE: Below make tracing from map, (when no map is obtainable make sketch) showing farm, center of section, this location with measurements and also wells, dry holes, or other locations in the vicinity of this location.

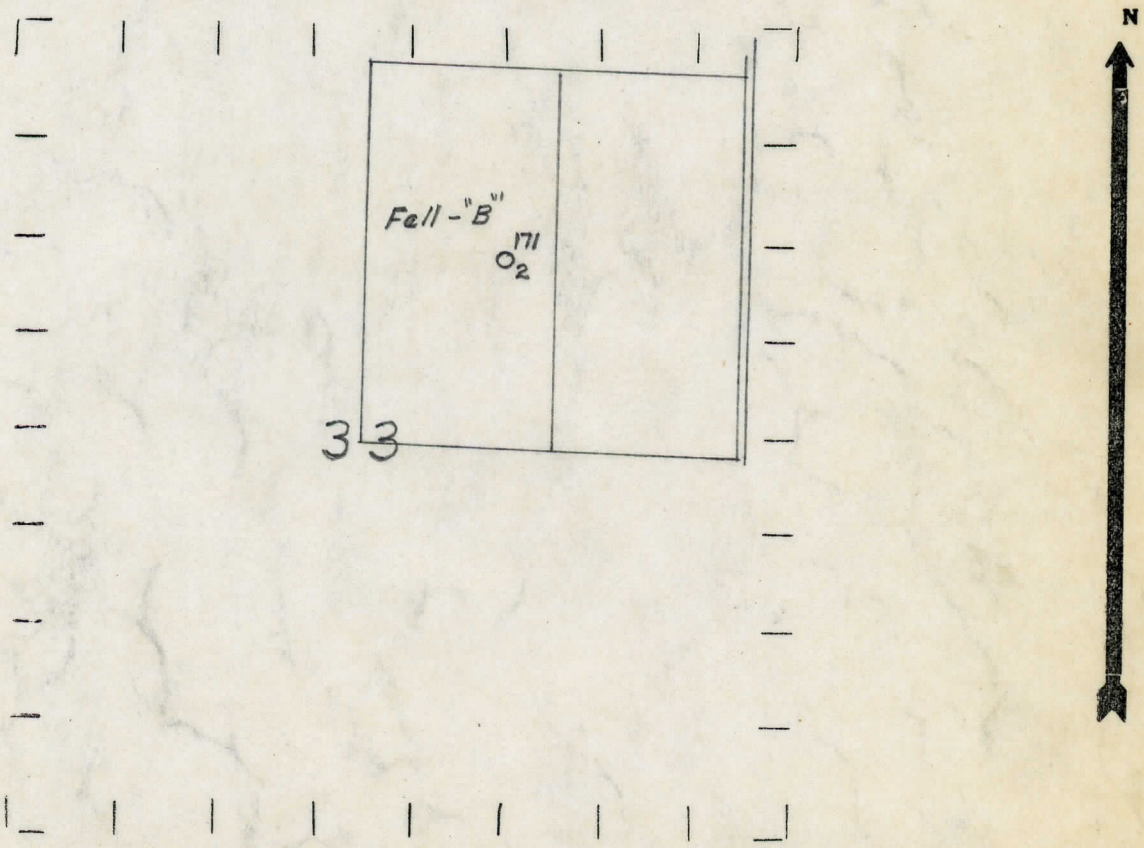

REMARKS: \_\_\_\_\_  
 \_\_\_\_\_  
 \_\_\_\_\_

SIGNED \_\_\_\_\_  
 Superintendent or Foreman.

DATE March 2, 1939 COLLECTED Redding LOCATION Redding No. 171  
 STATE Michigan COUNTY Clare DIST. Redding SEC. 33 TOWN 19 N RANGE 6 W  
 WELL No. 2 (SERIAL No. 171) FARM L.G. Fell "B" ACRES

NAME OF STREAM OR WATERS \_\_\_\_\_ QUADRANGLE C 33 NW NE

OPERATOR Socony-Vacuum Oil Company, Inc. Map Redding Township, Clare County  
990 Socony Vacuum Oil Co. Redding - Clare Co.  
 Feet from North Line of Farm

" " East " " "

" " South " " "

660 660 " " West " " "

990 990 Feet from North Line of Section

" " East " " "

" " South " " "

660 660 " " West " 1 1/4 "

*Loc*

- | LEGEND           |                      |
|------------------|----------------------|
| ○ LOCATION       | ⊙ DRY HOLE           |
| ⊕ RIG            | ⊙ DRY SHOWING OIL    |
| ⊕ DRILLING       | ⊙ DRY SHOWING GAS    |
| ⊙ GAS WELL       | ⊙ ABANDONED LOCATION |
| ● OIL WELL       | ⊙ ABANDONED GAS WELL |
| ⊙ SMALL OIL WELL | ⊙ ABANDONED OIL WELL |

NOTE: Below make tracing from map, (when no map is obtainable make sketch) showing farm, center of section, this location with measurements and also wells, dry holes, or other locations in the vicinity of this location.

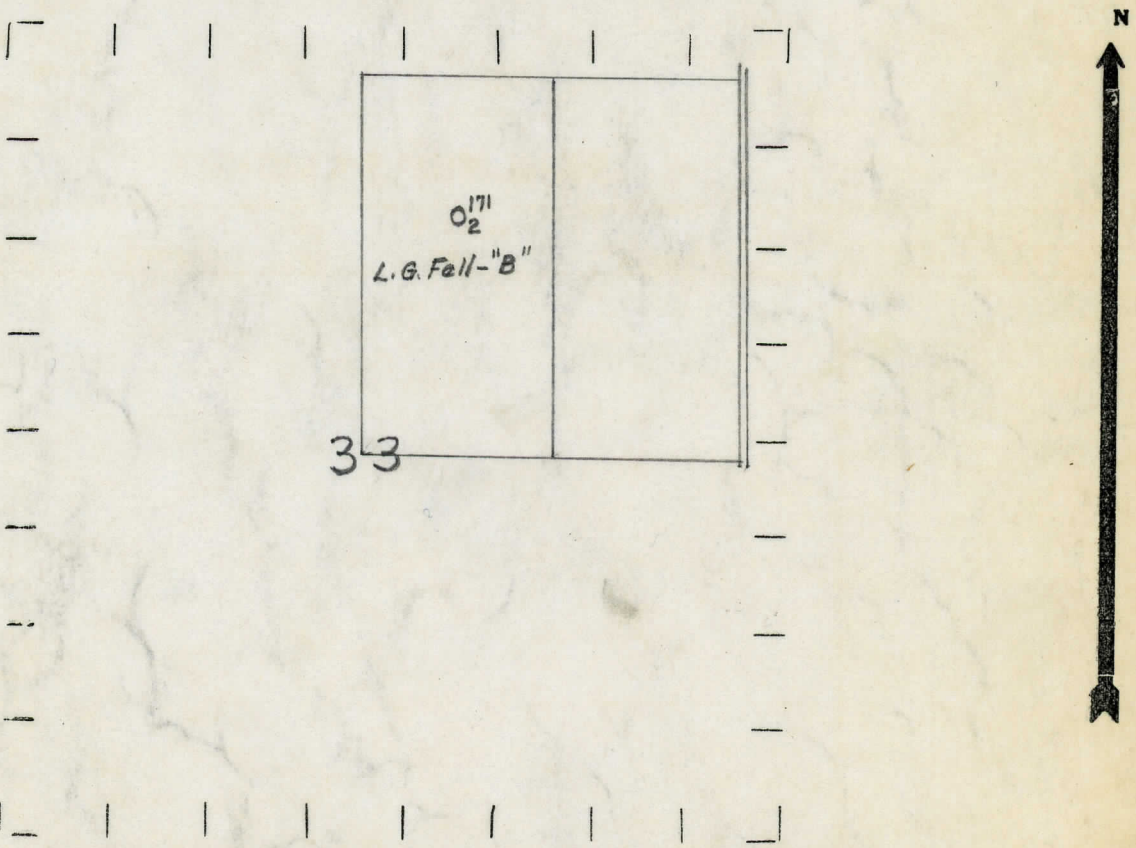

REMARKS: \_\_\_\_\_  
 \_\_\_\_\_  
 \_\_\_\_\_

SIGNED R. L. G.  
 Superintendent or Foreman.

D. C. Shackelford