



Western Michigan University
ScholarWorks at WMU

Legacy Scout Tickets from Pure Oil Company

8-20-2021

MGRRE_PureOilScoutTickets_Alford State_3_21035060760000

MGRRE

Western Michigan University

Follow this and additional works at: <https://scholarworks.wmich.edu/pure>



Part of the Geology Commons

WMU ScholarWorks Citation

MGRRE, "MGRRE_PureOilScoutTickets_Alford State_3_21035060760000" (2021). *Legacy Scout Tickets from Pure Oil Company*. 1171.

<https://scholarworks.wmich.edu/pure/1171>

This Document is brought to you for free and open access via ScholarWorks at WMU. It has been accepted for inclusion in Legacy Scout Tickets from Pure Oil Company by an authorized administrator of ScholarWorks at WMU. See the National Digital Catalogue - Science Base Catalogue for more collections submitted by MGRRE.



MGRRE_PureOilScoutTickets_Alford State_3_21035060760000

API 21035060760000

Permit Number 6076

Lease Name Alford State

Well Number 3

County Clare

Township 19N

Range 06W

Section 28

2021 DEQ or Pure co_name Trahan Petroleum, Incorporated

Pure Number 186

Latitude 44.0066346

Longitude -85.0461648

DATE April 27, 1939

LOCATION REPORT

No. 186

STATE Michigan COUNTY Clare

DIST. Redding
TWP. Redding
PREC. Alford-State

SEC. 28 TOWN 19 N RANGE 6 W

WELL No. 33 (SERIAL No. 186) FARM

ACRES

NAME OF STREAM OR WATERS

QUADRANGLE 082 NW SW

OPERATOR Gulf Refining Company

Map Redding Township, Clare County

Gulf Ref. Co.

Redding - Clare

Feet from North Line of Farm

Low

LEGEND

○ LOCATION

① RIG

⊕ DRILLING

☼ GAS WELL

● OIL WELL

⬮ SMALL OIL WELL

⬮ DRY HOLE

⬮ DRY SHOWING OIL

⬮ DRY SHOWING GAS

⬮ ABANDONED LOCATION

⬮ ABANDONED GAS WELL

⬮ ABANDONED OIL WELL

330 330 " " East " " "

660 660 " " South " " "

990 990 " " West " " "

Feet from North Line of Section

1/4 " " East " " "

660 660 " " South " " "

660 660 " " West " " "

NOTE: Below make tracing from map, (when no map is obtainable make sketch) showing farm, center of section, this location with measurements and also wells, dry holes, or other locations in the vicinity of this location.

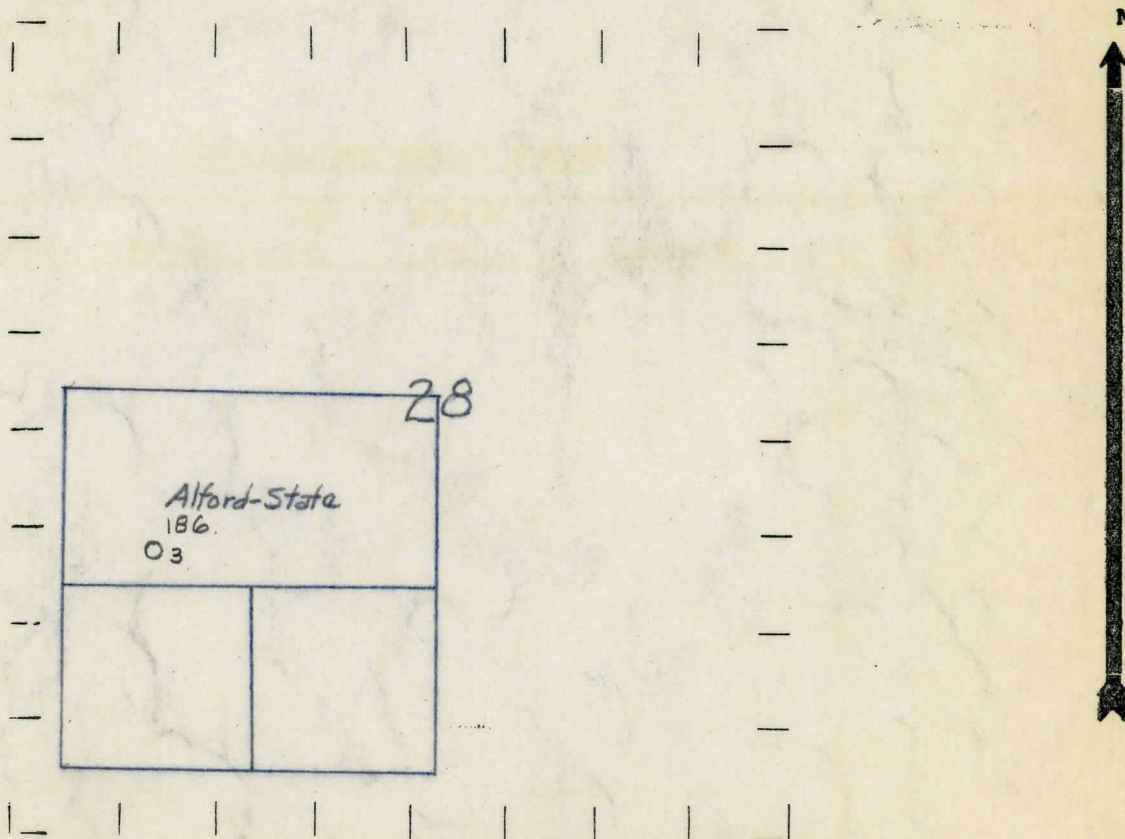

REMARKS:

SIGNED

R. L. G.
Superintendent or Foreman.

