



Western Michigan University
ScholarWorks at WMU

Legacy Scout Tickets from Pure Oil Company

8-20-2021

MGRRE_PureOilScoutTickets_Christensen, S. et
al_2_21035064370000

MGRRE
Western Michigan University

Follow this and additional works at: <https://scholarworks.wmich.edu/pure>



Part of the Geology Commons

WMU ScholarWorks Citation

MGRRE, "MGRRE_PureOilScoutTickets_Christensen, S. et al_2_21035064370000" (2021). *Legacy Scout Tickets from Pure Oil Company*. 1190.
<https://scholarworks.wmich.edu/pure/1190>

This Document is brought to you for free and open access via ScholarWorks at WMU. It has been accepted for inclusion in Legacy Scout Tickets from Pure Oil Company by an authorized administrator of ScholarWorks at WMU. See the National Digital Catalogue - Science Base Catalogue for more collections submitted by MGRRE.



MGRRE_PureOilScoutTickets_Christensen, S. et al_2_21035064370000

API 21035064370000

Permit Number 6437

Lease Name Christensen, S. et al

Well Number 2

County Clare

Township 18N

Range 06W

Section 3

2021 DEQ or Pure co_name Freeman Oil Company

Pure Number 212

Latitude 43.97752

Longitude -85.0197

THE PURE OIL COMPANY

LOCATION REPORT

No. 212

DATE 10-1-41

STATE Michigan COUNTY Clare DIST. Freeman SEC. 3 TOWN 18 N RANGE 6 W

WELL No. 2 (SERIAL No. 212) FARM Samuel Christensen, et al ACRES

NAME OF STREAM OR WATERS QUADRANGLE SE NE SW

OPERATOR Freeman Oil Company Map Freeman Township, Clare County

Feet from North Line of Farm

" " East " " "

" " South " " "

" " West " " "

Feet from North Line of Section

" " East " " "

" " South " " "

" " West " " "

LEGEND

O LOCATION

① RIG

⊕ DRILLING

☀ GAS WELL

● OIL WELL

● SMALL OIL WELL

☉ DRY HOLE

☉ DRY SHOWING OIL

☉ DRY SHOWING GAS

☉ ABANDONED LOCATION

☉ ABANDONED GAS WELL

☉ ABANDONED OIL WELL

NOTE: Below make tracing from map. (when no map is obtainable make sketch) showing farm, center of section, this location with measurements and also wells, dry holes, or other locations in the vicinity of this location.

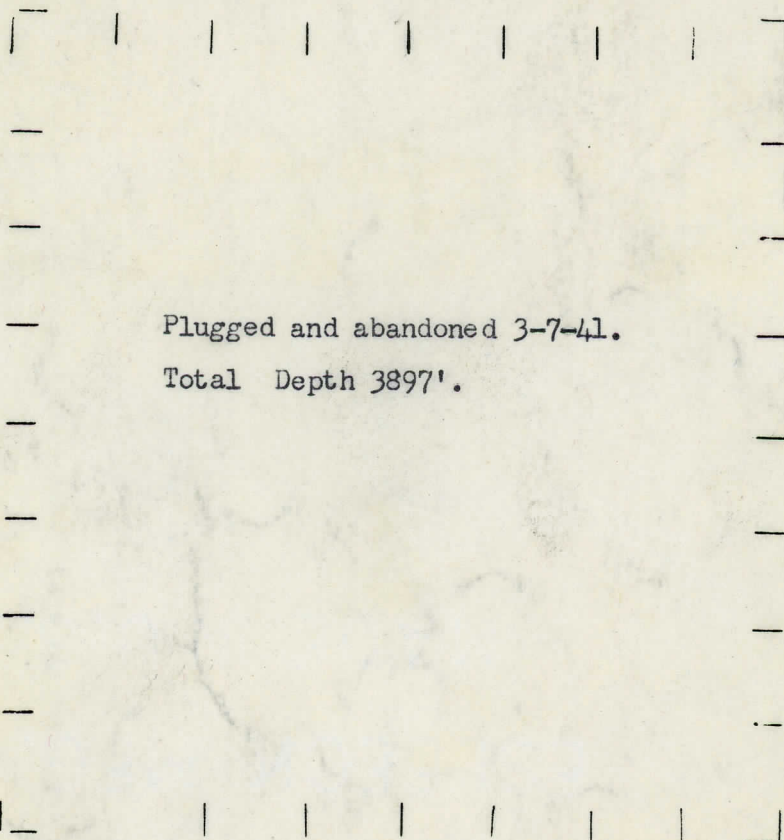

REMARKS:

SIGNED

Superintendent or Foreman.

WELL No. 8 (SERIAL No. 515) FARM

Samuel Christensen et al

ACRES

WELL No. 2 (SERIAL No. 212) FARM

RECORD

Samuel Christensen et al

ACRES

NAME OF STREAM OR WATERS

QUADRANGLE SE NE 3M

OPERATOR Freeman Oil Co.

Map Freeman Township, Clare County

9990

Freeman Oil Co.

Freeman - Clare

Feet from North Line of Farm

3330

" " East " " "

" " South " " "

3330

" " West " " "

9990

Feet from North Line of Section

3330

" " East 1/4 " "

" " South " " "

" " West " " "

LEGEND

○ LOCATION

⊕ RIG

⊕ DRILLING

☼ GAS WELL

● OIL WELL

⬮ SMALL OIL WELL

⬮ DRY HOLE

⬮ DRY SHOWING OIL

⬮ DRY SHOWING GAS

⬮ ABANDONED LOCATION

⬮ ABANDONED GAS WELL

⬮ ABANDONED OIL WELL

NOTE: Below make tracing from map, (when no map is obtainable make sketch) showing farm, center of section, this location with measurements and also wells, dry holes, or other locations in the vicinity of this location.

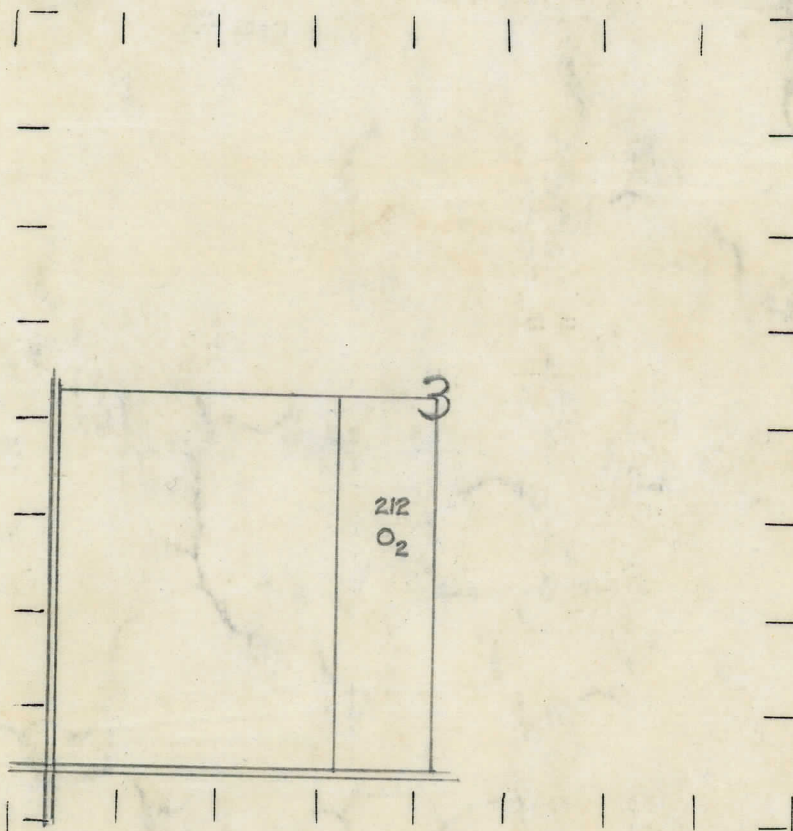

REMARKS:

SIGNED

Superintendent or Foreman.

Michigan Producing Division

Date **October 5, 1939**

No. 212

State Mich. County Clare Twp. Freeman Sec. 3 Twp. 18 N Rge. 6 W

Well No. 2 (County) 212 Farm Christensen, et al Acres

Operator **Freeman Oil Company** By **Scouting Department**
Information secured ~~from~~ **Scouting Department**

Date well started 7-20-39 Dated well completed 9-11-39 Elevation 1079.8

PRODUCTION RECORD

1st 24 hours natural Filled up 1200 ft.

2nd 24 hours natural

Date of shot	No. of quarts	From	to	From	to
--------------	------------------	------	----	------	----

Date of acid **9-14-39** No. of gallons **250**

1st ~~2~~ hour after acid 30 Barrels

shot

2nd 24 hours after acid

FORMATION AND CASING RECORD

[illegible]

Remarks After producing 30 bbls. the 1st. hour after acid well was pinched in to 100 barrels per day, it then went dead; later put on the pump and at present is producing 180 barrels of fluid, 25% water. 3887' C.T.M. equals 3881' S.L.M.

Signed

D. C. Shackelford